



## CHIC 100 SASH HINGES

### Functions

Concealed hinges, designed for traditional and minimal profiles, with sash weight up to 100 kg.

Online data sheet



### Technical Features

This hinge is designed to be combined with reduced hardware dimensions in view, such as SUPRA 7.

The surface treatment SHIELD MAX 5 offers Giesse hardware a significant advantage, allowing it to achieve CLASS 5 (<480 h) corrosion resistance according to the UNI EN 1670 standard.

Furthermore, this treatment ensures exceptional resistance on Giesse's CHIC 100 casement and tilt-and-turn products, exceeding 1000 hours in salt spray testing, thus providing more than double the durability and protection against corrosion.

### Materials

Corner support made of zamak

Connecting brackets and hinge plates made of zinc plated steel

Pins made of 304 grade stainless steel and aluminium bronze

Cams made of zinc plated steel

Table of maximum glass thickness [mm]

2500	33	27	23	20	18	16	15	14	13	12	11
2400	33	27	23	20	18	16	15	14	13	12	11
2300	34	28	24	21	19	17	16	14	13	12	11
2200	36	30	25	22	20	18	16	15	14	13	12
2100	37	31	27	23	21	19	17	16	14	13	12
2000	39	33	28	25	22	20	18	16	15	14	13
1900	41	34	30	26	23	21	19	17	16	15	14
1800	44	36	31	27	24	22	20	18	17	16	15
1700	46	38	33	29	26	23	21	19	18	16	15
1600	49	41	35	31	27	25	22	20	19	17	15
1500	50	44	37	33	29	26	24	22	20	17	15
1400	50	47	40	35	31	28	25	23	20	17	15
1300	50	50	43	38	34	30	27	24	20	17	15
1200	50	50	47	41	36	33	28	24	20	17	15
1100	50	50	50	45	40	34	28	24	20	17	
1000	50	50	50	49	42	34	28	24	20		
900	50	50	50	50	42	34	28	24			
800	50	50	50	50	42	34	28				
700	50	50	50	50	42	34					

Table of maximum load capacity [kg]

2500	100	100	100	100	100	100	100	100	100	100	100
2400	100	100	100	100	100	100	100	100	100	100	100
2300	100	100	100	100	100	100	100	100	100	100	100
2200	100	100	100	100	100	100	100	100	100	100	100
2100	100	100	100	100	100	100	100	100	100	100	100
2000	100	100	100	100	100	100	100	100	100	100	100
1900	100	100	100	100	100	100	100	100	100	100	100
1800	100	100	100	100	100	100	100	100	100	100	100
1700	100	100	100	100	100	100	100	100	100	100	98
1600	100	100	100	100	100	100	100	100	100	99	92
1500	100	100	100	100	100	100	100	100	100	93	87
1400	100	100	100	100	100	100	100	100	93	87	81
1300	100	100	100	100	100	100	100	100	94	87	75
1200	100	100	100	100	100	100	95	87	80	74	69
1100	100	100	100	100	100	95	87	79	73	68	
1000	100	100	100	100	96	87	79	72	67		
900	100	100	100	98	87	78	71	65			
800	100	100	99	87	77	69	63				
700	100	100	87	76	67	61					

### ADJUSTMENTS [mm]

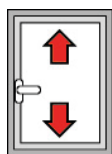

Height:  
+2.5 / -1

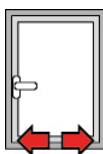

Side:  
+1,5 / -1,5



Hinge compression:  
+1,4 / -0,6

Item code	Description	PROFILE CROSS - SECTION	Hand	Base Raw	Anodised Elox	Painted	Trend/Gold Brass	Pieces per pack
0435421	CHIC - SASH HINGE SET	C001-C002-C003-C005-C006	LX	X				10
0435411	CHIC - SASH HINGE SET	C001-C002-C003-C005-C006	RX	X				10



## CHIC 100 SASH MECHANISM

### Functions

Giesse Cremona and window handles can be used to operate a CHIC 100 sash.

For space and design reasons, we recommend the use of the SUPRA 7 hammer, an innovative reversible mechanism system without washer, which can be used for moving window sashes with different types of opening, having mechanisms compatible with 7 mm square pins.

Online data sheet



### Technical Features

Supra 7 window handles can be combined with Giesse sash drives and mechanisms and have a rotor with a 7 mm square hole.

They are available in four styles: ARIA, ASIA, KORA and PRIMA.

Two movements are available:

- 0102001 for standard profiles (11.1 mm backset) two-way
- 00949 for minimal profiles (3.5 mm backset), one-way
- 0106101 for standard profiles (11.1 mm backset) one-way

### Materials

Handle in die-cast aluminium

Internal components made of GS SILVER PLUS

zamak, zinc plated steel and white polyamide

Zinc plated steel fixing screws, with Eslock treatment

04153

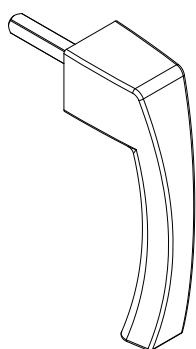

04154

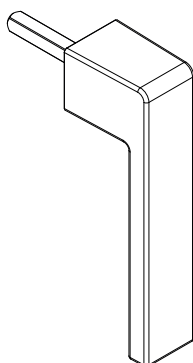

04155

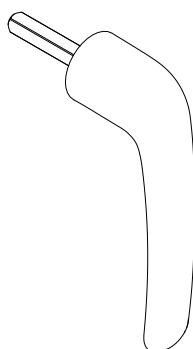

04156

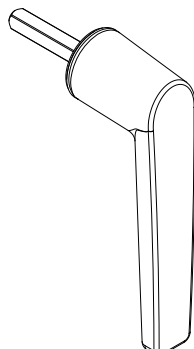

00949

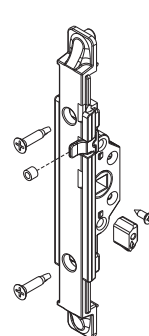

0102001

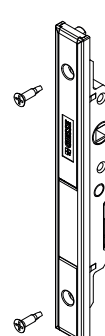

0106101

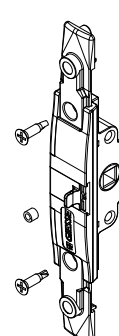

Item code	Description	Base Raw	Anodised Elox	Painted	Trend/Gold Brass	Pieces per pack
04153	SUPRA 7 - ASIA MECHANISM	X		X	X	10
04154	SUPRA 7 - KORA MECHANISM	X		X	X	10
04155	SUPRA 7 - PRIMA MECHANISM	X		X	X	10
04156	SUPRA 7 - ARIA MECHANISM	X		X	X	10

Item code	Description	PROFILE CROSS - SECTION	Finish	Base Raw	Anodised Elox	Painted	Trend/Gold Brass	Pieces per pack
00949	ONE-WAY MECHANISM M180	-	GS Silver Plus	X				10
0102001	TWO-WAY INTERNAL MECHANISM	C001-C002-C003-C004-C005-C006-C009-C010-C012-C013-C014-C015-C016-C017-P001-P002-P004-P005-P006-P007-P008-P009-P010	GS Silver Plus	X				5
0106101	ONE-WAY MECHANISM	-	GS Silver Plus	X				10

## CHIC 100 SASH FASTENERS



### Functions

Depending on the fastening system (one-way or two-way), different fastening components such as terminals or pawls and their corresponding strikers are available.

Online data sheet



01347K

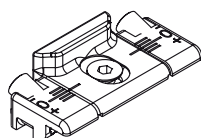

01348K

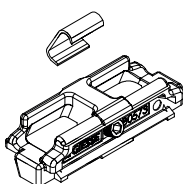

01349K

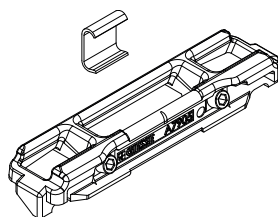

02111K

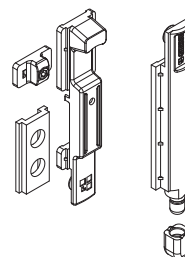

02114K



02168K

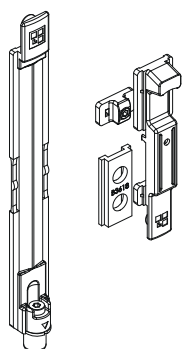

02188K

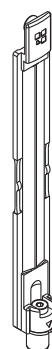

02309

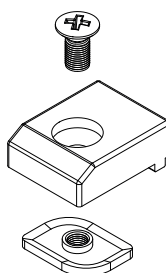

02336

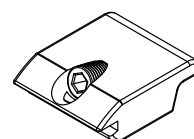

04027K

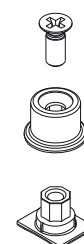

Item code	Description	Base Raw	Anodised Elox	Painted	Trend/Gold Brass	Pieces per pack
01347K	STRIKER	X				200
01348K	STRIKER	X				100
01349K	STRIKER	X				100
02111K	GIAP BOLT	X				50
02114K	TERMINAL FOR RODS	X				50
02168K	FUTURA ADJUSTABLE BOLT	X				10
02188K	FUTURA ADJUSTABLE TERMINAL	X				40
02309	SASH SUPPORT PLUG	X				100
02336	SASH SUPPORT PLUG	X				500
04027K	FUTURA FIXED PAWL	X				200

## SECONDARY SASH HINGE SET FOR CHIC 3D 100

### Functions

Set of hinges (top and bottom) for side-hung or secondary sash with tilt-and-turn CHIC 3D 100.

### Technical Features

Sash opening to 180°.

Maximum load capacity 100 kg.

Assembly is simple, fast and easy using the special pre-assembled cams.

When there is an additional fastening mechanism, you need to use the CHIC fastening element.

Both hinges are adjustable (3D).

If opening is obstructed, you need to use the FRIZ limitation arm.

The surface treatment SHIELD MAX 5 offers Giesse hardware a significant advantage, allowing it to achieve CLASS 5 (<480 h) corrosion resistance according to the UNI EN 1670 standard.

Furthermore, this treatment ensures exceptional resistance on Giesse's CHIC 100 casement and tilt-and-turn products, exceeding 1000 hours in salt spray testing, thus providing more than double the durability and protection against corrosion.

### Materials

Corner support made of zamak

Connecting brackets and hinge plates made of zinc plated steel

Pins made of 304 grade stainless steel and aluminium bronze

Cams made of zinc plated steel

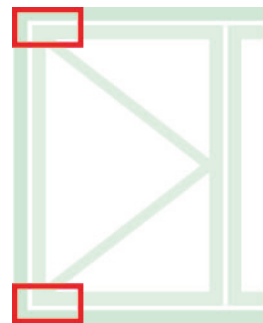

Online data sheet



SHIELD MAX 5

0435421

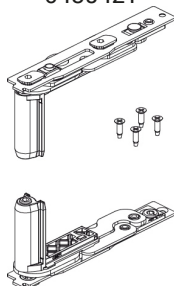

0435411

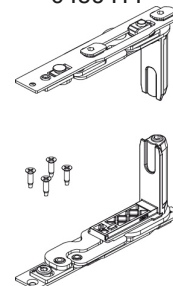

Mandatory to use the FRIZ arm

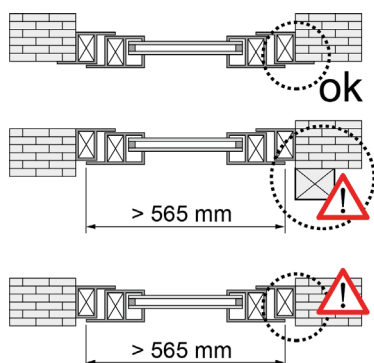

FRIZ arm positioning

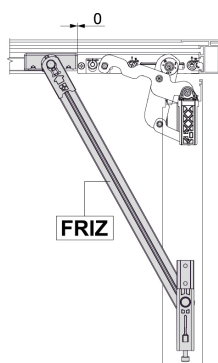

Opening angle with FRIZ arm

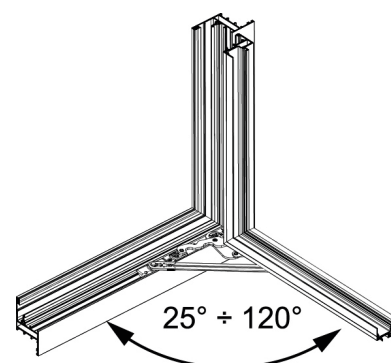

Item code	Description	PROFILE CROSS - SECTION	Hand	Base Raw	Anodised Elox	Painted	Trend/Gold Brass	Pieces per pack
0435421	CHIC - SASH HINGE SET	C001-C002-C003-C005-C006	LX	X				10
0435411	CHIC - SASH HINGE SET	C001-C002-C003-C005-C006	RX	X				10