

## CHAMPION PLUS MULTILOCK

### Functions

Multilocking system, for aluminium sliding doors and windows, that can be operated with a single mechanism (window handle or recess handle).

### Technical Features

Champion Plus is a locking system consisting of 3 different components:

1. Standard fastening rod or fastening rod with micro-ventilation
2. Fixing kit for standard fastening rods or fastening rods with micro-ventilation
3. Mechanisms

Depending on the type of sliding system used and the size of the sash, the appropriate fastening rod and fixing kit must be selected.

## CHAMPION PLUS - VERSION WITH MICRO-VENTILATION

1. Closed window

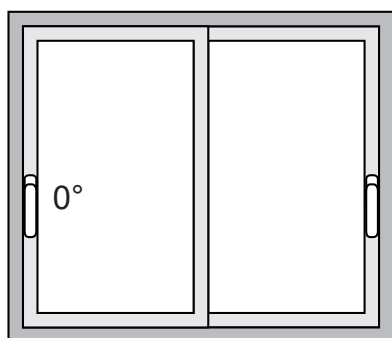

2. Opening window

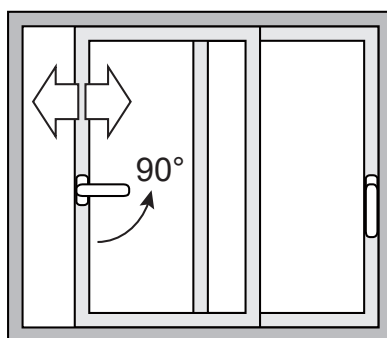

3. Window in micro-ventilation position

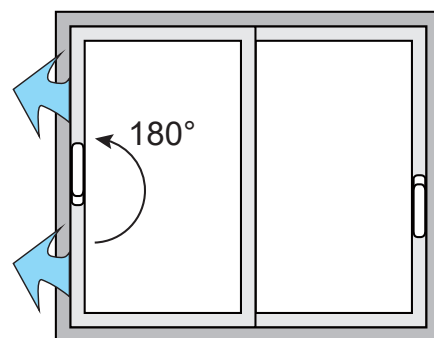

## CHAMPION PLUS - STANDARD VERSION (WITHOUT MICRO-VENTILATION)

1. Closed window

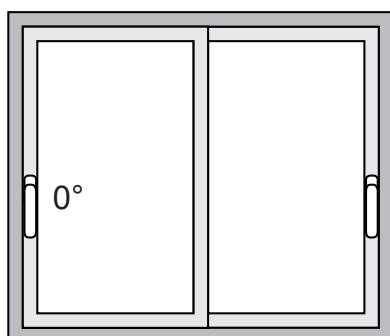

2. Opening window

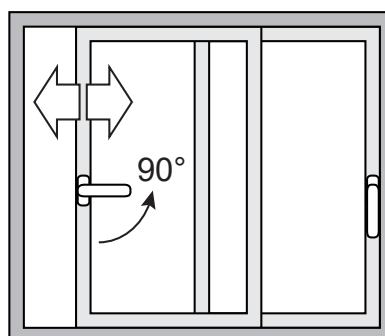



Complete system of multi-lock rods (1 to 3 points) for sliding windows or balcony-doors made of aluminium.



The Champion Plus fastening rods with 2 and 3 locking points are compatible with the incorrect movement safety device art. 02770, which prevents the window handle from returning to the closed position with the sash open.

Zinc-plated steel lift-proof pin and rods  
Box for rotor and nibs in zamak

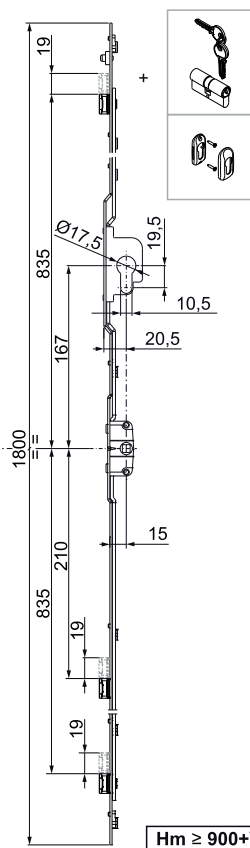

Item code	Description	Backset	Lock	Incorrect Movement Safety Device Compatibility	Length	Window handle height	Locking points	Base Raw	Anodised Elox	Painted	Trend/Gold Brass	Pieces per pack
0272001	CHAMPION PLUS ROD	7,5	NO	NO	270	> 130 + Y	1	X				4
0272101	CHAMPION PLUS ROD	7,5	NO	YES	600	> 300 + Y	2	X				4
0272201	CHAMPION PLUS ROD	7,5	NO	YES	1000	> 500 + Y	2	X				4
0630901	CHAMPION PLUS ROD	7,5	NO	Yes	1600	> 800 + Y	3	X				4
0272301	CHAMPION PLUS ROD	7,5	NO	YES	1800	> 900 + Y	3	X				4
0272401	CHAMPION PLUS ROD	15	NO	NO	270	> 130 + Y	1	X				4
0272501	CHAMPION PLUS ROD	15	NO	YES	600	> 300 + Y	2	X				4
0272601	CHAMPION PLUS ROD	15	NO	YES	1000	> 500 + Y	2	X				4
0631001	CHAMPION PLUS ROD	15	NO	YES	1600	> 800 + Y	3	X				4
0272701	CHAMPION PLUS ROD	15	NO	YES	1800	> 900 + Y	3	X				4
0272801	CHAMPION PLUS ROD WITH LOCK	15	YES	YES	1800	> 900 + Y	3	X				4



## CHAMPION PLUS FIXING KIT

### Functions

The fixing kit is necessary to correctly and durably apply a Champion rod in a specific aluminium sliding system and to obtain the micro-air circulation function.

Online data sheet



### Technical Features

The Champion Plus fixing kit with micro-ventilation is available in 3 versions:

- for 1 point multi-lock
- for 2 point multi-lock
- for 3 point multi-lock

The Champion Plus fixing kit usually includes all those components necessary to apply the fastening rod in a specific aluminium sliding system.

These kits therefore generally include:

- Shims to adapt the rod to the sash profile
- Frame counterplates
- Frame counterplate adjustment shims
- Lift-proof component
- Fixing screws
- Window handle spacer tubes

The rod adjustment shims snap into place, facilitating hardware installation operations.

Depending on the sliding system used, these adapters provide different fixing systems:

- direct to the profile, in which the screw grips directly in the sash profile
- with expansion (patented by Giesse) in which the adapter expands and anchors to the sash profile without the need for drilling

### Materials

Shims for adapting the rod to the profile, counterplate shims and window handle spacers of grey polyamide

Screws for fixing rod to profile in stainless steel

Frame counterplate made of zinc plated steel

Anti-lift component and retractor (where applicable) made of die-cast zamak

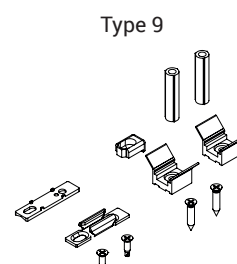
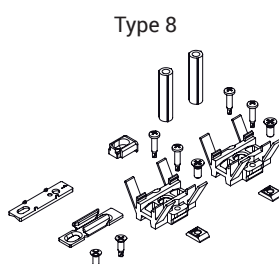
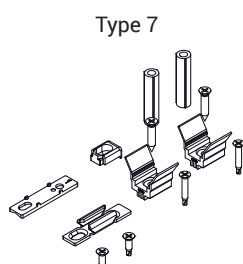
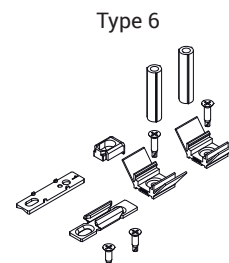
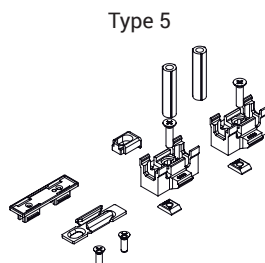
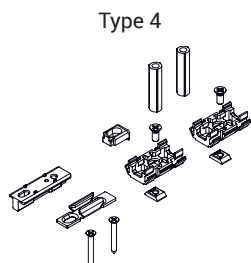
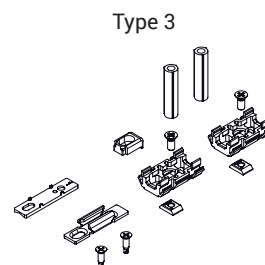
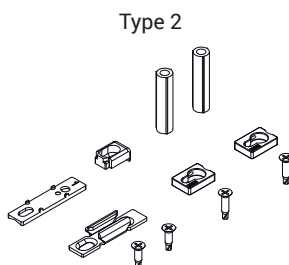
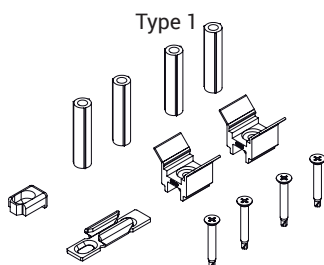

Type 10

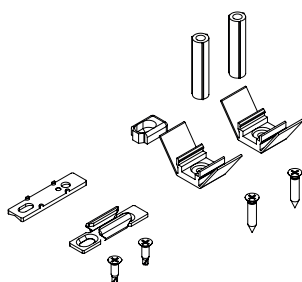

Type 11

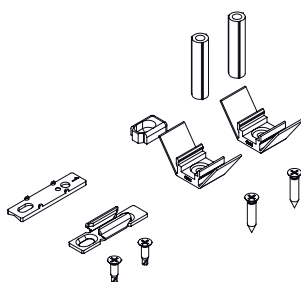

Type 12

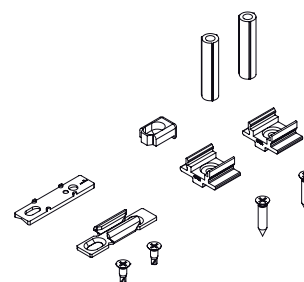

Type 13

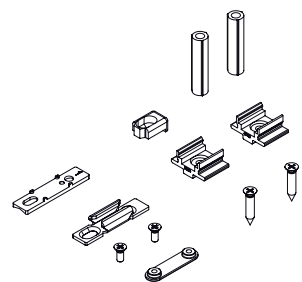

Type 14

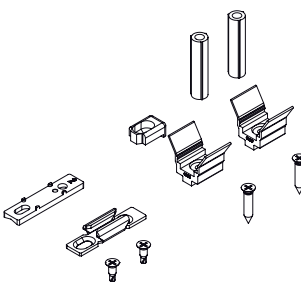

Type 15

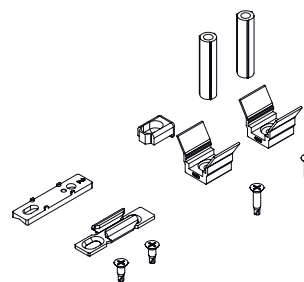

Type 16

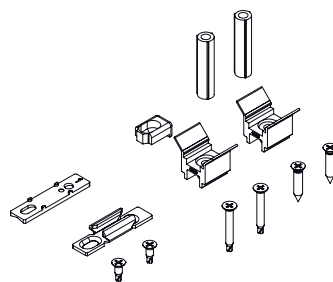

Type 17

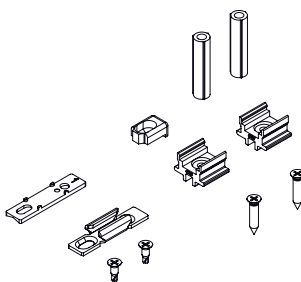

Type 18

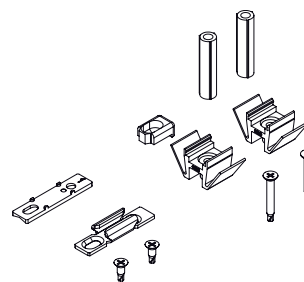

Type 19

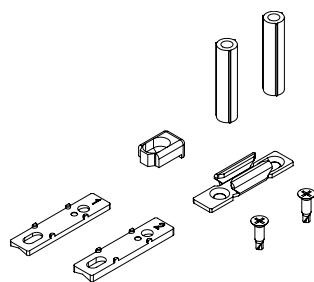

Type 20

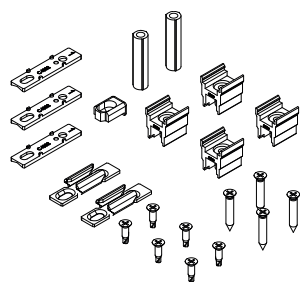

Type 21

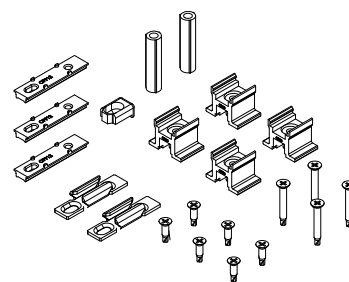

Direct fixing (A1)

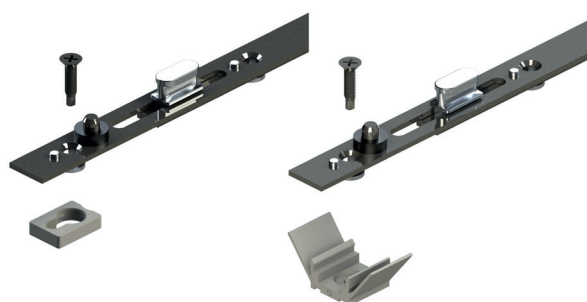

Expansion fixing (A2)

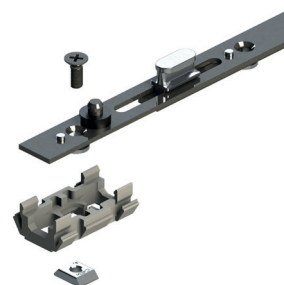

Item code	Description	Rod for matching	Type	Rod fixing to sash	Base Raw	Anodised Elox	Painted	Trend/Gold Brass	Pieces per pack
06040	FIXING KIT for Champion Plus with 2 locking points	02721 - 02722 - 02725 - 02726	20	Direct (A1)	X				8
06044	FIXING KIT for Champion Plus with 2 locking points	02721 - 02722 - 02725 - 02726	15	Direct (A1)	X				8
06045	FIXING KIT for Champion Plus with 3 locking points	02723 - 02727 - 02728 - 06309 - 06710	15	Direct (A1)	X				8
06046	FIXING KIT for Champion Plus with 2 locking points	02721 - 02722 - 02725 - 02726	21	Direct (A1)	X				8
06047	FIXING KIT for Champion Plus with 3 locking points	02723 - 02727 - 02728 - 06309 - 06710	21	Direct (A1)	X				8
06048	FIXING KIT for Champion Plus with 3 locking points	02723 - 02727 - 02728 - 06309 - 06710	20	Direct (A1)	X				8
06112	FIXING KIT for Champion Plus with 2 locking points	02721 - 02722 - 02725 - 02726	20	Direct (A1)	X				8
06113	FIXING KIT for Champion Plus with 3 locking points	02723 - 02727 - 02728 - 06309 - 06710	20	Direct (A1)	X				8
06231	FIXING KIT for Champion Plus with 1 locking point	02720 - 02724	1	Direct (A1)	X				8
06232	FIXING KIT for Champion Plus with 2 locking points	02721 - 02722 - 02725 - 02726	1	Direct (A1)	X				8
06233	FIXING KIT for Champion Plus with 3 locking points	02723 - 02727 - 02728 - 06309 - 06710	1	Direct (A1)	X				8
06301	FIXING KIT for Champion Plus with 1 locking point	02720 - 02724	2	Direct (A1)	X				8
06302	FIXING KIT for Champion Plus with 2 locking points	02721 - 02722 - 02725 - 02726	2	Direct (A1)	X				8
06303	FIXING KIT for Champion Plus with 3 locking points	02723 - 02727 - 02728 - 06309 - 06710	2	Direct (A1)	X				8
06311	FIXING KIT for Champion Plus with 1 locking point	02720 - 02724	3	Expansion fixing (A2)	X				8
06312	FIXING KIT for Champion Plus with 2 locking points	02721 - 02722 - 02725 - 02726	3	Expansion fixing (A2)	X				8
06313	FIXING KIT for Champion Plus with 3 locking points	02723 - 02727 - 02728 - 06309 - 06710	3	Expansion fixing (A2)	X				8
06321	FIXING KIT for Champion Plus with 1 locking point	02720 - 02724	4	Expansion fixing (A2)	X				8
06322	FIXING KIT for Champion Plus with 2 locking points	02721 - 02722 - 02725 - 02726	4	Expansion fixing (A2)	X				8
06323	FIXING KIT for Champion Plus with 3 locking points	02723 - 02727 - 02728 - 06309 - 06710	4	Expansion fixing (A2)	X				8
06325	FIXING KIT for Champion Plus with 2 locking points	02721 - 02722 - 02725 - 02726	9	Direct (A1)	X				8
06326	FIXING KIT for Champion Plus with 3 locking points	02723 - 02727 - 02728 - 06309 - 06710	9	Direct (A1)	X				8
06332	FIXING KIT for Champion Plus with 2 locking points	02721 - 02722 - 02725 - 02726	5	Expansion fixing (A2)	X				8
06333	FIXING KIT for Champion Plus with 3 locking points	02723 - 02727 - 02728 - 06309 - 06710	5	Expansion fixing (A2)	X				8
06342	FIXING KIT for Champion Plus with 2 locking points	02721 - 02722 - 02725 - 02726	6	Direct (A1)	X				8
06343	FIXING KIT for Champion Plus with 3 locking points	02723 - 02727 - 02728 - 06309 - 06710	6	Direct (A1)	X				8
06351	FIXING KIT for Champion Plus with 1 locking point	02720 - 02724	7	Direct (A1)	X				8
06352	FIXING KIT for Champion Plus with 2 locking points	02721 - 02722 - 02725 - 02726	7	Direct (A1)	X				8
06353	FIXING KIT for Champion Plus with 3 locking points	02723 - 02727 - 02728 - 06309 - 06710	7	Direct (A1)	X				8
06362	FIXING KIT for Champion Plus with 2 locking points	02721 - 02722 - 02725 - 02726	8	Expansion fixing (A2)	X				8
06371	FIXING KIT for Champion Plus with 1 locking point	02720 - 02724	2	Direct (A1)	X				8
06372	FIXING KIT for Champion Plus with 2 locking points	02721 - 02722 - 02725 - 02726	2	Direct (A1)	X				8
06373	FIXING KIT for Champion Plus with 3 locking points	02723 - 02727 - 02728 - 06309 - 06710	2	Direct (A1)	X				8

Item code	Description	Rod for matching	Type	Rod fixing to sash	Base Raw	Anodised Elox	Painted	Trend/Gold Brass	Pieces per pack
06381	FIXING KIT for Champion Plus with 1 locking point	02720 - 02724	10	Direct (A1)	X				8
06382	FIXING KIT for Champion Plus with 2 locking points	02721 - 02722 - 02725 - 02726	10	Direct (A1)	X				8
06383	FIXING KIT for Champion Plus with 3 locking points	02723 - 02727 - 02728 - 06309 - 06710	10	Direct (A1)	X				8
06391	FIXING KIT for Champion Plus with 1 locking point	02720 - 02724	11	Direct (A1)	X				8
06392	FIXING KIT for Champion Plus with 2 locking points	02721 - 02722 - 02725 - 02726	11	Direct (A1)	X				8
06393	FIXING KIT for Champion Plus with 3 locking points	02723 - 02727 - 02728 - 06309 - 06710	11	Direct (A1)	X				8
06421	FIXING KIT for Champion Plus with 1 locking point	02720 - 02724	12	Direct (A1)	X				8
06422	FIXING KIT for Champion Plus with 2 locking points	02721 - 02722 - 02725 - 02726	12	Direct (A1)	X				8
06423	FIXING KIT for Champion Plus with 3 locking points	02723 - 02727 - 02728 - 06309 - 06710	12	Direct (A1)	X				8
06431	FIXING KIT for Champion Plus with 1 locking point	02720 - 02724	13	Direct (A1)	X				8
06441	FIXING KIT for Champion Plus with 1 locking point	02720 - 02724	14	Direct (A1)	X				8
06443	FIXING KIT for Champion Plus with 3 locking points	02723 - 02727 - 02728 - 06309 - 06710	14	Direct (A1)	X				8
06451	FIXING KIT for Champion Plus with 1 locking point	02720 - 02724	15	Direct (A1)	X				8
06452	FIXING KIT for Champion Plus with 2 locking points	02721 - 02722 - 02725 - 02726	15	Direct (A1)	X				8
06453	FIXING KIT for Champion Plus with 3 locking points	02723 - 02727 - 02728 - 06309 - 06710	15	Direct (A1)	X				8
06461	FIXING KIT for Champion Plus with 1 locking point	02720 - 02724	16	Direct (A1)	X				8
06462	FIXING KIT for Champion Plus with 2 locking points	02721 - 02722 - 02725 - 02726	16	Direct (A1)	X				8
06463	FIXING KIT for Champion Plus with 3 locking points	02723 - 02727 - 02728 - 06309 - 06710	16	Direct (A1)	X				8
06471	FIXING KIT for Champion Plus with 1 locking point	02720 - 02724	17	Direct (A1)	X				8
06472	FIXING KIT for Champion Plus with 2 locking points	02721 - 02722 - 02725 - 02726	17	Direct (A1)	X				8
06473	FIXING KIT for Champion Plus with 3 locking points	02723 - 02727 - 02728 - 06309 - 06710	17	Direct (A1)	X				8
06481	FIXING KIT for Champion Plus with 1 locking point	02720 - 02724	18	Direct (A1)	X				8
06482	FIXING KIT for Champion Plus with 2 locking points	02721 - 02722 - 02725 - 02726	18	Direct (A1)	X				8
06483	FIXING KIT for Champion Plus with 3 locking points	02723 - 02727 - 02728 - 06309 - 06710	18	Direct (A1)	X				8
06491	FIXING KIT for Champion Plus with 1 locking point	02720 - 02724	19	Sash side adapters and fixing screws not included in the kit	X				8
06492	FIXING KIT for Champion Plus with 2 locking points	02721 - 02722 - 02725 - 02726	19	Sash side adapters and fixing screws not included in the kit	X				8
06493	FIXING KIT for Champion Plus with 3 locking points	02723 - 02727 - 02728 - 06309 - 06710	19	Sash side adapters and fixing screws not included in the kit	X				8
06792	FIXING KIT for Champion Plus with 2 locking points	02721 - 02722 - 02725 - 02726	20	Direct (A1)	X				8
06793	FIXING KIT for Champion Plus with 3 locking points	02723 - 02727 - 02728 - 06309 - 06710	20	Direct (A1)	X				8

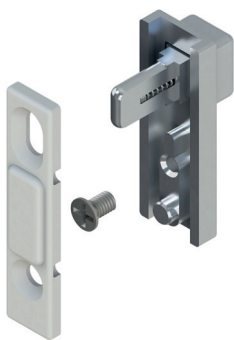

## INCORRECT MOVEMENT SAFETY DEVICE

### Functions

Device that prevents, with the sash open, bringing the hardware into the closed position.

Online data sheet



### Technical Features

Easily fitted on all Champion Plus Multilocks with 2 or 3 locking points.  
Acts as protection for the hardware preventing accidental impact between the ribs and counterplates.  
Prevents the user of the window from inadvertently putting the window handle into the closed position when the sash is open.  
Only when the sash is closed and then moved next to the frame will the device unlock and allow turning the pull handle and subsequently closing the sash.  
It can be used in combination with all Champion Plus rods without micro-ventilation.  
Compatible with Champion Plus rods with micro-ventilation only with cremone locked at 90°.

### Materials

Incorrect movement safety device body and button made of die-cast zamak  
Return spring made of harmonic steel  
Stainless steel fixing screw  
Frame striker of polyamide

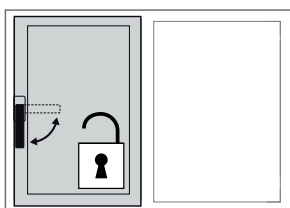
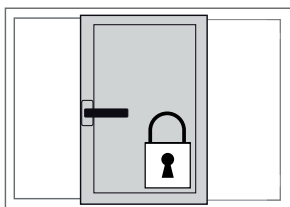

A = contained in the Champion Plus fixing kit

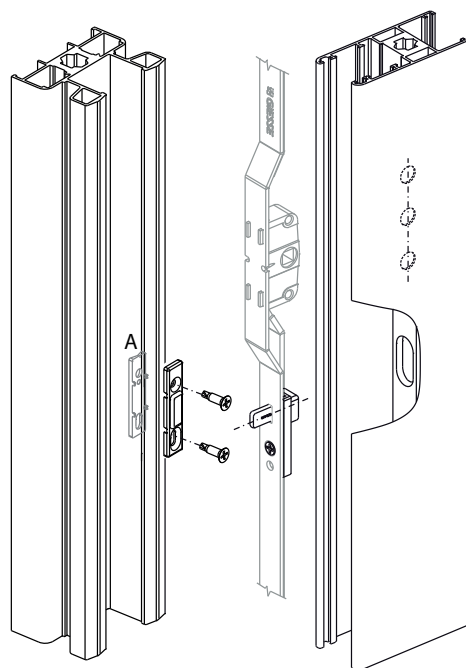

Item code	Description	Can be combined with	Base Raw	Anodised Elox	Painted	Trend/Gold Brass	Pieces per pack
02770	INCORRECT MOVEMENT SAFETY DEVICE	0272101 - 0272201 - 0272301 - 0272501 - 0272601 - 0272701 - 0272801 - 0630901 - 0631001	X				8



## PRIMA CHAMPION PLUS WINDOW HANDLE

### Functions

Window handle that is applied on the main sash of a sliding casement.

Online data sheet



### Technical Features

Two versions are available, single and double (balcony doors), the Prima window handle provides easy operation of the Champion Plus multi-lock. Equipped with a 7 mm square pin and a positioner for stopping the handle at 0° and 180°.

### Materials

Handle, plate-cover and rotor in die-cast zamak  
Square pin and screws in stainless steel  
Polyamide plate

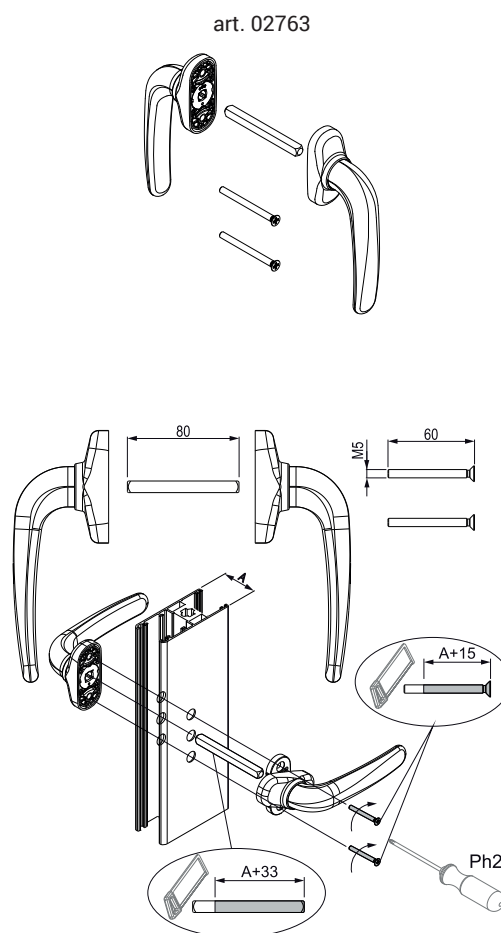
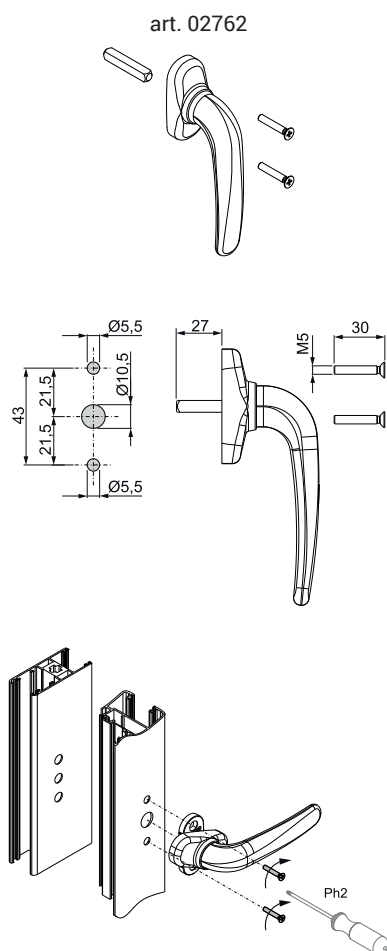

Item code	Description	PROFILE CROSS - SECTION	Applicable	Base Raw	Anodised Elox	Painted	Trend/ Gold Brass	Pieces per pack
02762	PRIMA WINDOW HANDLE	C001-C002-C003-C004-C005-C006-C007-C009-C010-C011-C012-C013-C014-C015-C016-C017-P001-P002-P003-P004-P005-P006-P007-P008-P009-P010	internal	X		X	X	5
02763	DOUBLE PRIMA WINDOW HANDLE	-	internal/external	X		X	X	5

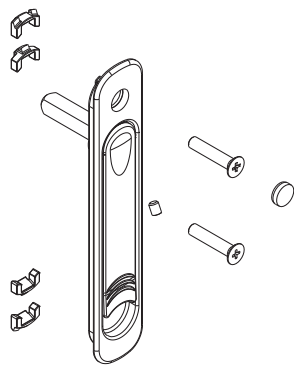

## RECESSED WINDOW HANDLE

### Functions

Window handle that is applied on the secondary sash of a sliding casement.

Online data sheet



### Technical Features

Not being top-hung, it allows overlapping the sashes.  
Equipped with a 7 mm square pin and a positioner for stopping the handle at 0° and 180°.  
The product has its own system for fixing to the stand-alone profile compared to the M5x25 screws fastening the window handle to the internal mechanism.  
Depending on the shape of the sash profile, the manufacturer will decide on how to prepare the recessed window handle with parts A or B so that the product is anchored in an effective and long-lasting manner.

### Materials

External body, pull handle and fixing components made of die-cast zamak  
Square pin and fixing screws in zinc plated steel  
Hostaform snap disk  
Locking washer made of harmonic steel

art. 02760

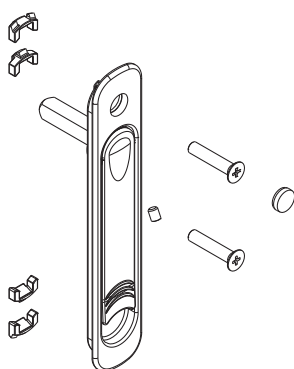

art. 02761

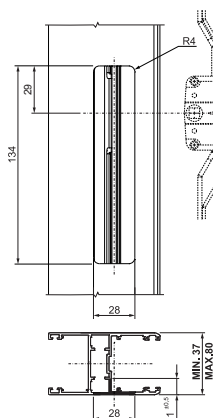
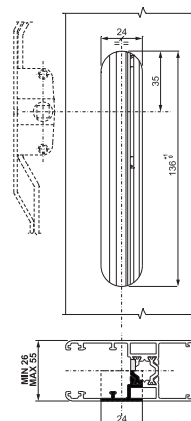
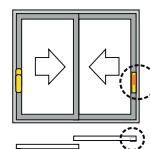
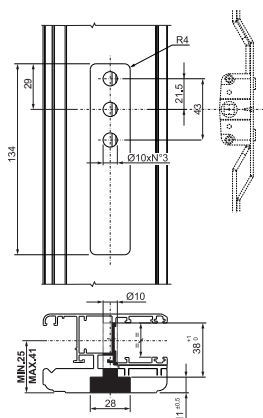
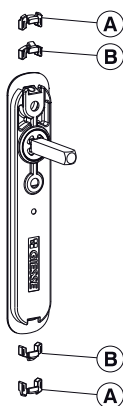
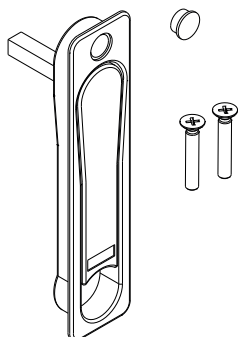

Item code	Description	Applicable	Notes	Base Raw	Anodised Elox	Painted	Trend/Gold Brass	Pieces per pack
02760	RECESSED WINDOW HANDLE	internal		X		X	X	8
02761	RECESSED WINDOW HANDLE	internal	Alu/wood or Alu profiles > 37 mm	X		X	X	8

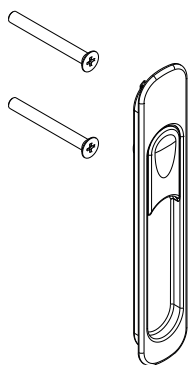

## EXTERNAL RECESS PULL HANDLE

### Functions

The external recess pull handle has the function of pulling a sliding sash and works in conjunction with a window handle on the inside of the casement.

Online data sheet



### Technical Features

The external recess pull handle has the function of pulling a sliding sash and works in conjunction with a window handle on the inside of the casement. This article is fitted externally and performs the function of pulling a sliding sash.

This product works in combination with the recess window handle or in combination with the Prima window handle.

The metric screws supplied with the window handle for the inside are screwed into the external recess handle, joining the 2 products with the profile

### Materials

External body and lever made of die-cast zamak  
Zinc plated steel screws

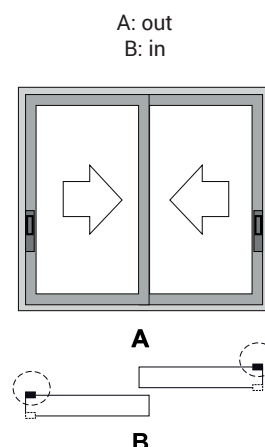
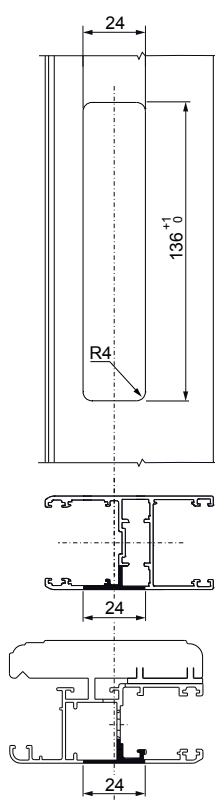

Item code	Description	Applicable	Can be combined with	Base Raw	Anodised Elox	Painted	Trend/Gold Brass	Pieces per pack
02764	EXTERNAL RECESS PULL HANDLE	external	02760-02761-02762	X		X	X	8

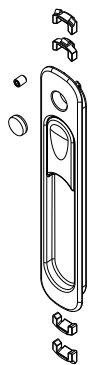

BLIND INTERNAL RECESS PULL HANDLE

**Functions**  
Blind recess handle to be applied on the opposite sash which has the sole function of drawing.

Online data sheet



**Materials**  
Die-cast zamak coupling teeth and body  
Stainless steel locking grub screw

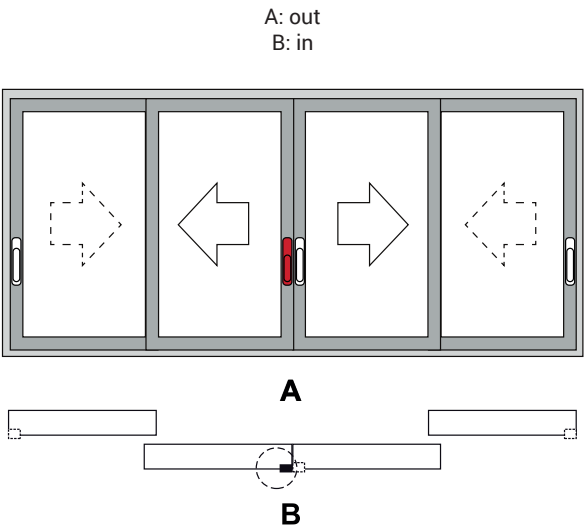
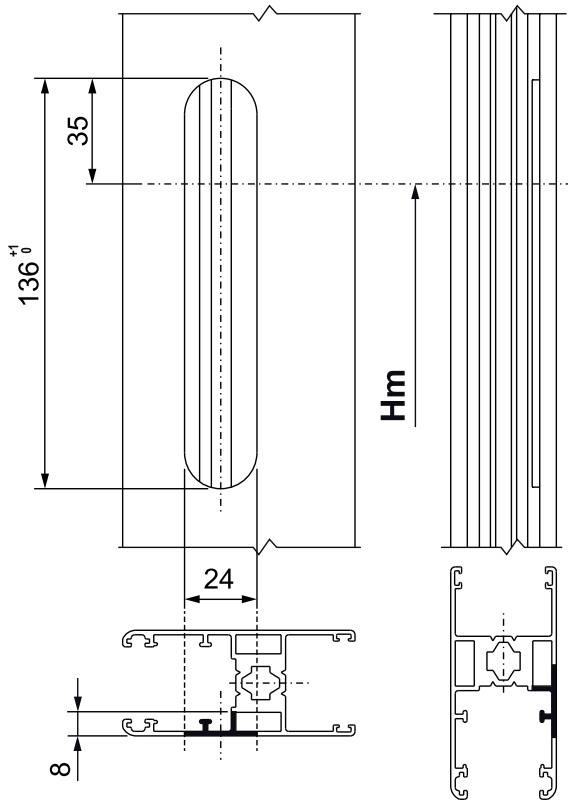

Item code	Description	Applicable	Notes	Base Raw	Anodised Elox	Painted	Trend/Gold Brass	Pieces per pack
02765	BLIND INTERNAL RECESS PULL HANDLE	internal	Opposing sashes	X		X	X	8