

FLUSH CHIC 3D 100

FLUSH CHIC 3D 100

Functions

Complete system for the construction of concealed tilt-and-turn windows with load capacities of up to 100 kg and with 105° sash opening. Available in the standard, logic and micro-ventilation versions.



CHIC 100

Technical Features

Making a CHIC 3D 100 Tilt-and-Turn mechanism requires:

1. Set of hinges + arms
2. Limitation arm
3. Set of fastening mechanisms for Cremones, window handles and SUPRA 7 window handles
4. Cremona, window handle and SUPRA 7 window handle (available in different models to choose from in the specific catalog section)

Adjustments

The adjustments are micrometric and independent.

Standard microventilation

Micro-ventilation enables having simultaneously both the tilt-and-turn position and micro-ventilation (precision opening of the sash) on the casement, for better air exchange.

Logica

The logical operation consists in first tilt-and-turn opening (with the cremona at 90°) and secondly side-hung opening (with the cremona at 180°). Its use is particularly recommended in public buildings (schools, hospitals, etc.) in combination with a cremona with a key in order to have only tilt-and-turn window opening for safety reasons and to allow full opening only for staff with the key.

Production micro-ventilation with standard opening

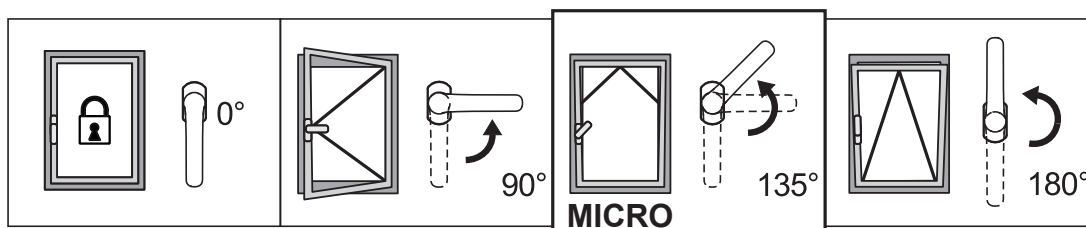

Production micro-ventilation with Logica opening

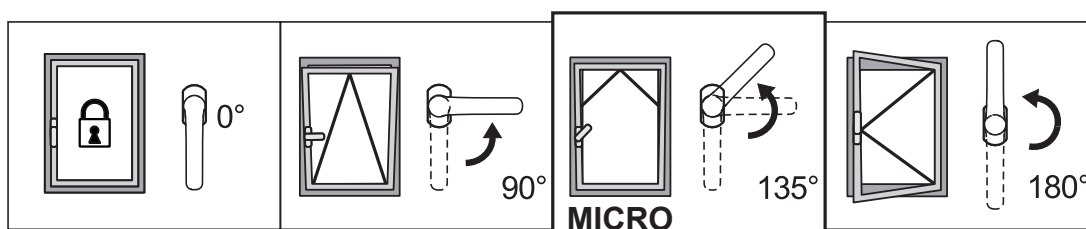

ADJUSTMENTS [mm]

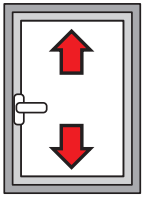

Height:
+2.5 / -1

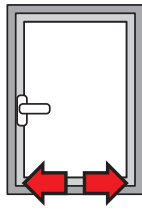

Side:
±1.5

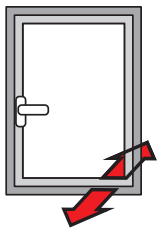

Bottom hinge compression:
+1.4 / -0.6

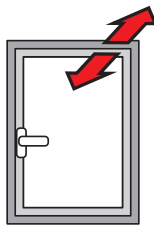

Top hinge compression:
±1.5

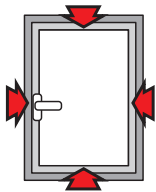

Striker compression:
±1.8

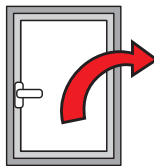

Sash fall:
+3.5 / -1.5

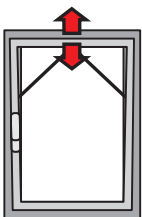

Micro-ventilation:
+3.6 / -1.8

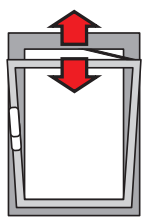

T2 arm opening:
148 ÷ 178

Table of maximum glass thickness [mm]

2500	33	27	23	20	18	16	15	14	13	12	11
2400	33	27	23	20	18	16	15	14	13	12	11
2300	34	28	24	21	19	17	16	14	13	12	11
2200	36	30	25	22	20	18	16	15	14	13	12
2100	37	31	27	23	21	19	17	16	14	13	12
2000	39	33	28	25	22	20	18	16	15	14	13
1900	41	34	30	26	23	21	19	17	16	15	14
1800	44	36	31	27	24	22	20	18	17	16	15
1700	46	38	33	29	26	23	21	19	18	16	15
1600	49	41	35	31	27	25	22	20	19	17	15
1500	50	44	37	33	29	26	24	22	20	17	15
1400	50	47	40	35	31	28	25	23	20	17	15
1300	50	50	43	38	34	30	27	24	20	17	15
1200	50	50	47	41	36	33	28	24	20	17	15
1100	50	50	50	45	40	34	28	24	20	17	
1000	50	50	50	49	42	34	28	24	20		
900	50	50	50	50	42	34	28	24			
800	50	50	50	50	42	34	28				
700	50	50	50	50	42	34					
600											
485	500	600	700	800	900	1000	1100	1200	1300	1400	1500

Table of maximum load capacity [kg]

2500	100	100	100	100	100	100	100	100	100	100	100
2400	100	100	100	100	100	100	100	100	100	100	100
2300	100	100	100	100	100	100	100	100	100	100	100
2200	100	100	100	100	100	100	100	100	100	100	100
2100	100	100	100	100	100	100	100	100	100	100	100
2000	100	100	100	100	100	100	100	100	100	100	100
1900	100	100	100	100	100	100	100	100	100	100	100
1800	100	100	100	100	100	100	100	100	100	100	100
1700	100	100	100	100	100	100	100	100	100	100	98
1600	100	100	100	100	100	100	100	100	100	99	92
1500	100	100	100	100	100	100	100	100	100	93	87
1400	100	100	100	100	100	100	100	100	93	87	81
1300	100	100	100	100	100	100	100	94	87	80	75
1200	100	100	100	100	100	100	95	87	80	74	69
1100	100	100	100	100	100	95	87	79	73	68	
1000	100	100	100	100	96	87	79	72	67		
900	100	100	100	98	87	78	71	65			
800	100	100	99	87	77	69	63				
700	100	100	87	76	67	61					
600											
485	500	600	700	800	900	1000	1100	1200	1300	1400	1500

FLUSH CHIC 3D 100 standard

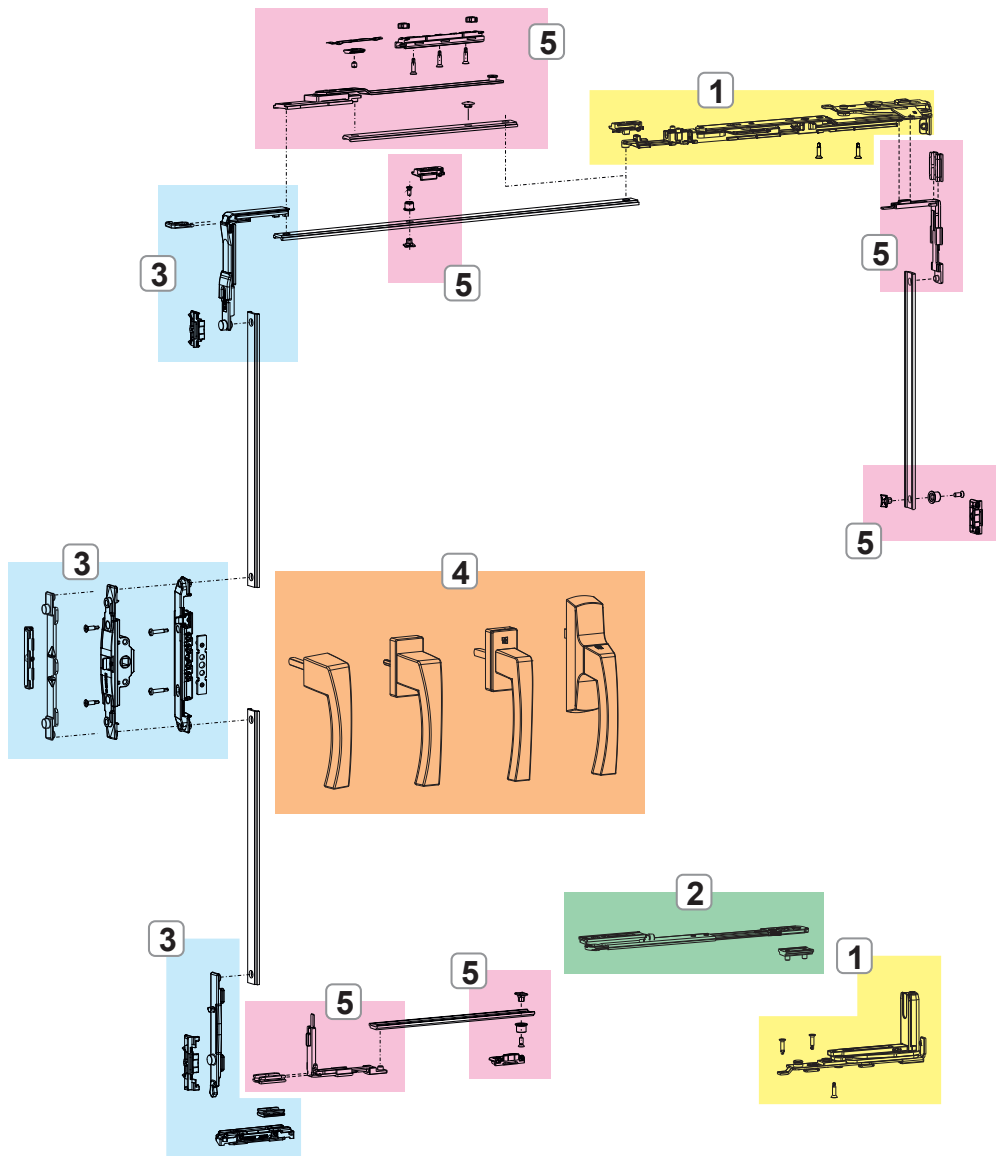

- 1. FLUSH CHIC 3D 100 HINGES AND ARMS
- 2. LIMITATION ARM
- 3. FLUSH CHIC 3D 100 FASTENING MECHANISM
- 4. CREMONE, WINDOW HANDLES AND SUPRA 7 WINDOW HANDLES
- 5. FLUSH CHIC 3D 100 ADDITIONAL FASTENING MECHANISMS AND COMPONENTS

CHIC 100

FLUSH CHIC 3D 100 logic

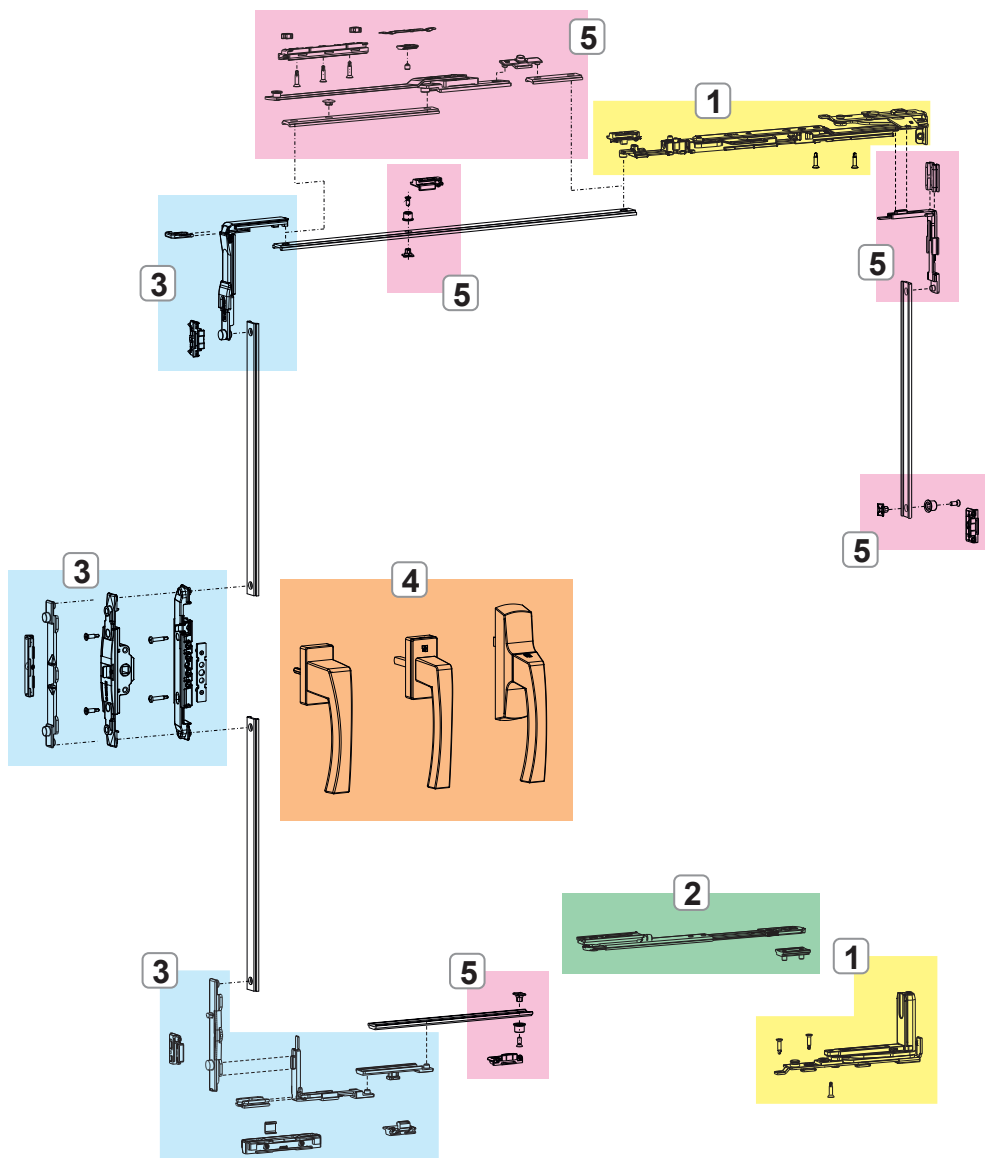

- 1. FLUSH CHIC 3D 100 HINGES AND ARMS
- 2. LIMITATION ARM
- 3. FLUSH CHIC 3D 100 FASTENING MECHANISM
- 4. CREMONESI, MARTELLINE E MANOVRE NP SUPRA
- 5. FLUSH CHIC 3D 100 ADDITIONAL FASTENING MECHANISMS AND COMPONENTS

FLUSH CHIC 3D 100 HINGES AND ARMS

Functions

Set of hinges (top and bottom), completely pre-assembled and ready to be installed on the profile.

Technical Features

They enable tilt-and-turn opening combined with the mechanisms.

Micro-ventilation and logica versions.

The arm is equipped with micro-ventilation as standard (adjustable).

Moving the fastening pawl takes the arm from conventional to logica.

The T2 arm is adjustable: the opening "A" goes from 178 mm (base) to 148 mm.

Materials

Corner support made of zamak

Connecting brackets and hinge plates made of zinc plated steel

Pins made of 304 grade stainless steel and aluminium bronze

Cams made of zinc plated steel

Connecting bracket and arm rod made of 304 grade stainless steel

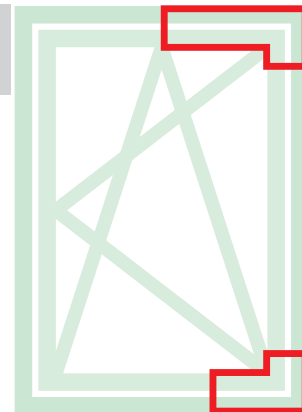

Online data sheet



052912

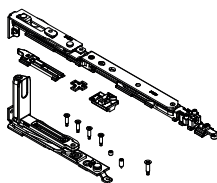

052911

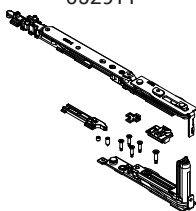

052922

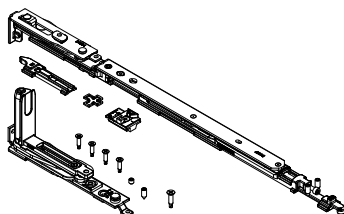

052921

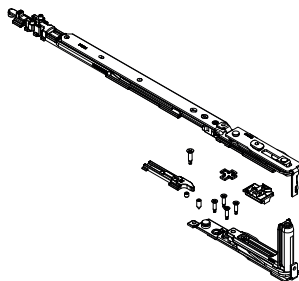

$\alpha^\circ \text{ MAX} = 105^\circ$

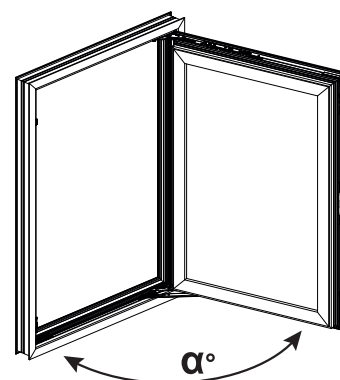

Sash opening

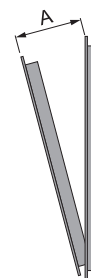

Item code	Description	PROFILE CROSS - SECTION	Range (mm)	Version	A (mm)	Hand	Base Pawl	Anodised Elox	Painted	Trend/Gold Brass	Pieces per pack
052911	CHIC 100 FLUSH - AR ARM T1 KIT	C013-C014-C015-C016-017	W 485 ÷ 700	Micro	98	RX	X				10
052912	CHIC 100 FLUSH - AR ARM T1 KIT	C013-C014-C015-C016-017	W 485 ÷ 700	Micro	98	LX	X				10
052921	CHIC 100 FLUSH - AR ARM T2 KIT	C013-C014-C015-C016-017	L 600 ÷ 1500	Micro	148÷178	RX	X				10
052922	CHIC 100 FLUSH - AR ARM T2 KIT	C013-C014-C015-C016-017	L 600 ÷ 1500	Micro	148÷178	LX	X				10

CHIC LIMITATION ARM

Functions

Accessory utilised to limit opening of the sash when movement of the sash is restricted by obstacles such as uprights or walls.

In the case of FLUSH CHIC it is essential to avoid damage to the hinge since the maximum opening allowed is 105°.

Technical Features

Sliding plate friction adjustable by means of suitable screw.

Applicable on tilt-and-turn window sashes with a minimum width of 485 mm.

Equipped with a spring-loaded manual quick release.

Stop plate fitted with two grub screws to prevent slippage.

Materials

Rod and stop plate made of pre-oxidised extruded aluminium.

Black polyamide frictioning element.

Pins, grub screws, spring and release in stainless steel.



Online data sheet



05293

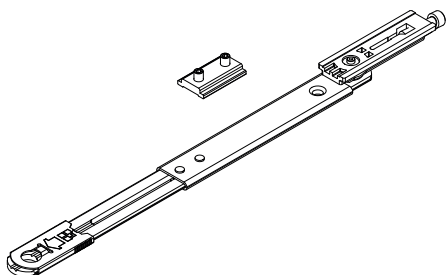

d (mm)	α°
102	105°
127	90°
>127	<90°
α° MAX 105	

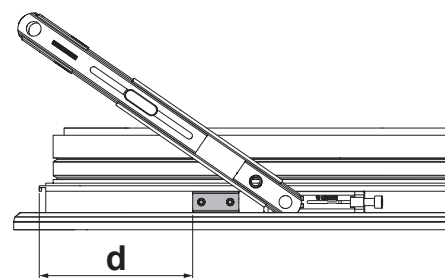
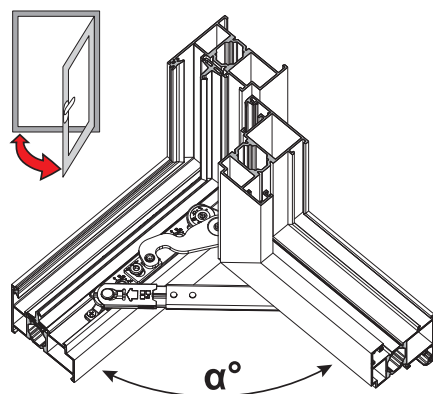

Item code	Description	Interface type	Base Raw	Anodised Elox	Painted	Trend/Gold Brass	Pieces per pack
05293	CHIC - LIMITATION ARM	C013-C014-C015-C016-C017	X				10

FLUSH CHIC 3D 100 FASTENING MECHANISM

Functions

Tilt-and-turn window fastening mechanisms for Cremona, window handle and SUPRA 7 window handle, available in Base and Logica versions.

Materials

Drive, drive rod, mechanism bolt tip and strikers in zamak with GS Silver Plus finish (up to 500 h of corrosion resistance).

Screws and grub screws in stainless steel.

Polyamide raiser.

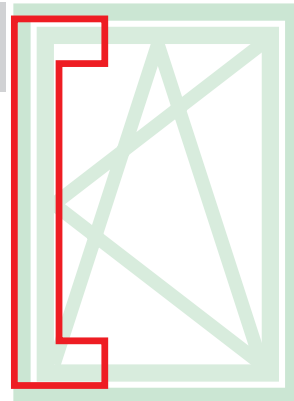

Online data sheet



00947

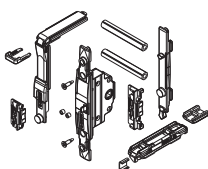

0395501

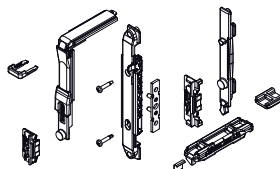

04371

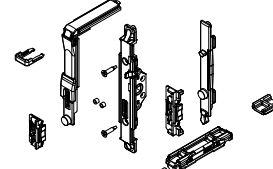

04704

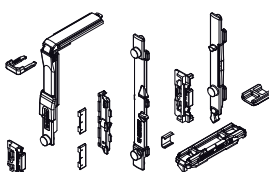

04704010

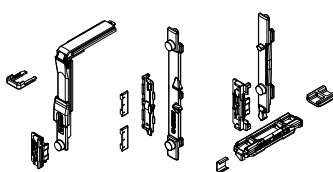

0470501

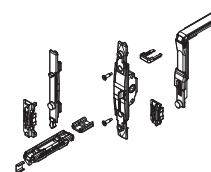

04706N

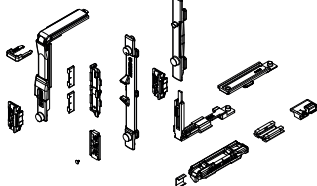

0470701

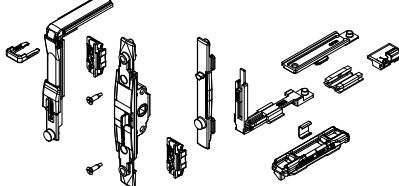

Item code	Descriptions	PROFILE CROSS - SECTION	Mechanism	Version	Base Raw	Anodised Elox	Painted	Trend/Gold Brass	Pieces per pack
00947	T/T M 180 MOVEMENT FASTENING MECHANISM	C001-C002-C003-C005-C006-C013-C014-C015-C017	Window handle	-	X				10
0395501	T/T FASTENING MECHANISM	C001-C002-C003-C005-C006-C013-C014-C015-C017	NP SUPRA	-	X				10
04371	FASTENING MECHANISM T/T MOVEMENT M 180	C001-C002-C004-C005-C006-C013-C014-C015-C016-C017	Window handle - SUPRA 7	-	X				10
04704	T/T FASTENING MECHANISM	C001-C002-C003-C005-C006-C013-C014-C015-C016-C017	Cremona	-	X				10
04704010	T/T FASTENING MECHANISM	C001-C003	Cremona	-	X				10
0470501	T/T M 180 FASTENING MECHANISM	C001-C002-C004-C005-C006-C013-C014-C015-C016-C017	Window handle - SUPRA 7	-	X				10
04706N	T/T LOGICA FASTENING MECHANISM	C001-C002-C003-C005-C006-C013-C014-C015-C016-C017	Cremona	Logica	X				10
0470701	T/T M 180 LOGICA FASTENING MECHANISM	C001-C002-C004-C005-C006-C013-C014-C015-C016-C017	Window handle	Logica	X				10

FLUSH CHIC 3D 100 ADDITIONAL FASTENING MECHANISMS AND COMPONENTS

Functions

The additional fasteners make it possible to add further fastening elements that either increase the dimensions of the casement or that can be used when locking points are needed on the cross beams or hinge-side upright.

Technical Features

On the basis of the dimensions of the casement, additional fasteners (for H>1200 mm and W>1000 mm) and the additional arm (which is mandatory for W>1000 mm) are to be used in combination with this mechanism.

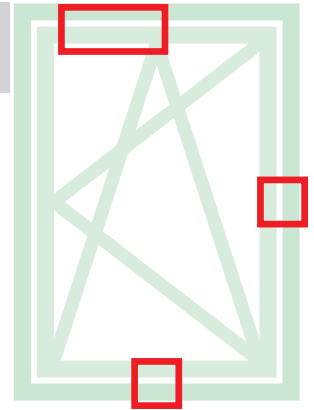

Online data sheet



05289

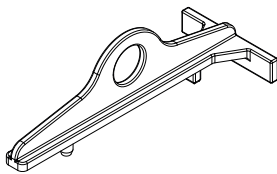

04024K

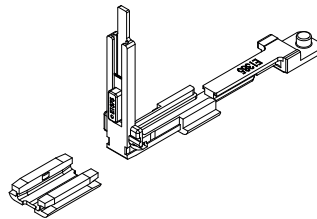

04777K

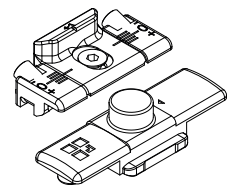

04770K

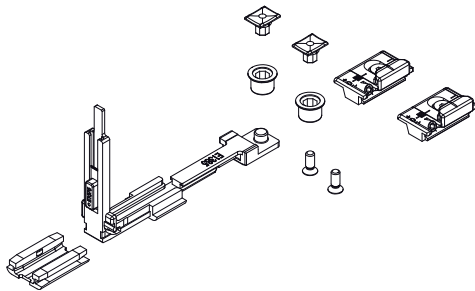

04301K

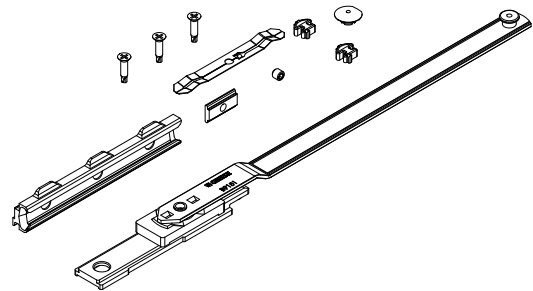

Item code	Description	Interface type	Range (mm)	Version	Base Raw	Anodised Elox	Painted	Trend/Gold Brass	Pieces per pack
05289	CHIC FLUSH - TEMPLATE FOR AR	C013-C014-C015-C016-C017	-	-	X				10
04024K	CORNER DRIVE FOR FUTURA BURGLAR-PROOF FUNCTION	C001-C002-C003-C013-C014-C015-C016-C017	-	-	X				10
04301K	T/T FUTURA ADDITIONAL ARM	C001-C002-C003-C005-C006-C011-C013-C014-C015-C016-C017	W > 1000	-	X				5
04770K	FUTURA ADDITIONAL FASTENING MECHANISM	C001-C002-C003-C005-C006-C013-C014-C015-C016-C017	H > 1200 L > 1000	-	X				10
04777K	FUTURA ADDITIONAL FASTENING MECHANISM	C001-C002-C003-C005-C006-C011-C013-C014-C015-C016-C017	H > 1200 L > 1000	Logica	X				50

FLUSH CHIC 3D 100 SECONDARY SASH HINGE KIT

Functions

CHIC 3D 100 FLUSH hinge set (top and bottom) for side-hung sash or secondary sash combined with turn-and-tilt sash.

Technical Features

Sash opening to 105°.

Maximum load capacity 100 kg.

Assembly is simple, fast and easy using the special pre-assembled cams.

When there is an additional fastening mechanism, you need to use the CHIC fastening element.

Both hinges are adjustable (3D).

It is mandatory to use the CHIC limitation arm (code 05293).

Materials

Corner support made of zamak

Connecting brackets and hinge plates made of zinc plated steel

Pins made of 304 grade stainless steel and aluminium bronze

Cams made of zinc plated steel

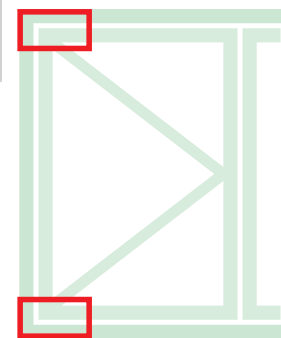

Online data sheet



052902

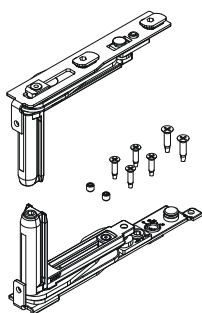

052901

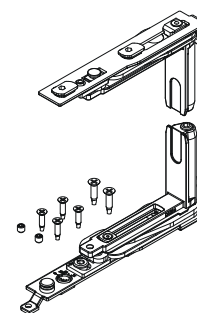

CHIC limitation arm(05293)

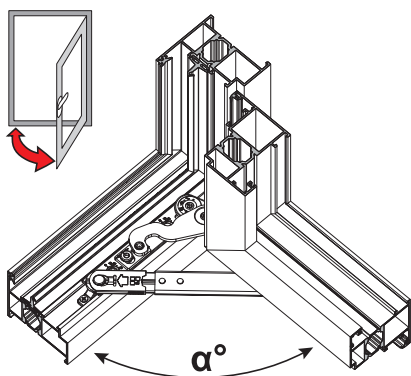

d (mm)	α°
102	105°
127	90°
>127	<90°
α° MAX 105	

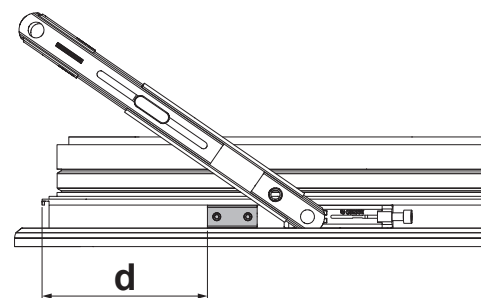

Item code	Description	PROFILE CROSS - SECTION	Hand	Base Raw	Anodised Elox	Painted	Trend/Gold Brass	Pieces per pack
052901	CHIC 100 FLUSH - SASH HINGE KIT	C013-C014-C015-C016-017	RX					10
052902	CHIC 100 FLUSH - SASH HINGE KIT	C013-C014-C015-C016-017	LX					10