

## GS3000 - 300/400 LIFT AND SLIDE

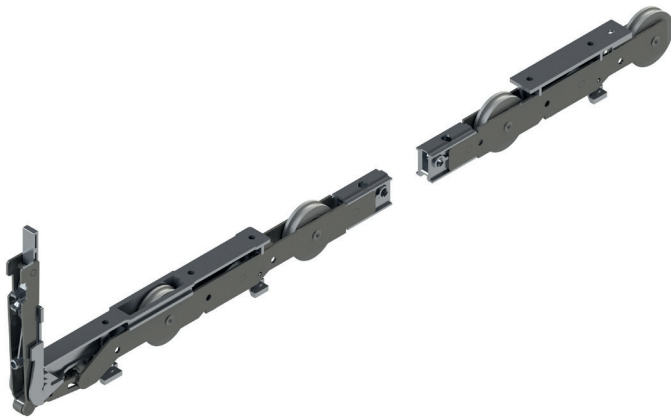

### Functions

Lift and slide hardware system to construct sashes from 300 to 400 kg.

### Technical Features

The GS3000-300/400 system is composed of:

- 300/22 pulleys (300 kg) for seating in profiles with 22 mm slot and 42 mm slot/track distance, for sashes up to 300 kg
- additional pulley, in addition to the 300/22 pulleys, to be employed for the following cases:
  - 1 additional pulley for sashes wider than 2500 mm and up to 300 kg
  - 2 additional pulleys for sashes up to 400 kg in weight and width >1300 mm
- pulleys connection rod for drive transmission from main to secondary pulley. DEREK To be selected on the basis of sash width
- driving rod with 27.5 mm backset and 37.5 with key, type GS3000 or GS3000 PLUS. The backset depends on the profile employed and the length of the rod depends on the sash height
- locking points to assemble to the frame in the case of the GS3000 or on the driving rod in the case of the GS3000 PLUS, to be selected according to the profile used. The number of mechanisms depends on the sash height
- shims to be selected in accordance with the profile, drive gear and type of locking point employed
- window handle with 80 mm fixing C/C distance, available in KORA, ASIA and PRIMA styles, in single version without key and single/double with key.
- external recess handle with 80 mm fixing C/C distance

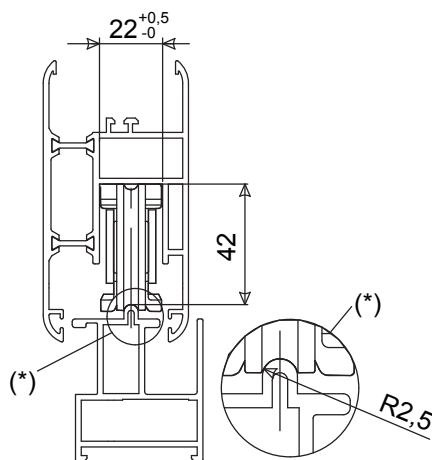

### Available characteristics and sizes

<b>Sash width</b>	L = 720 - 3350 mm
<b>Sash height</b>	H = 1150 - 3750 mm (with extension)
<b>Max sash weight</b>	300 kg (400 kg with two additional pulleys)
<b>Pulleys 300/22</b>	For slot with width A = 22 mm and track distance B = 42 mm
<b>Drive gears</b>	Backset E = 37.5 mm and E = 27.5 mm
<b>Window handle</b>	Handle length L = 240 mm, 80 mm C/C distance and 10 mm square pin. Single and double version, with or without key.

Drive gear with 27.5 mm backset (80 mm fixing C/C distance)



Drive gear with 37.5 mm backset ready for cylinder (80 mm fixing C/C distance)



Drive gear extension covering extension for sashes up to 3750 mm high



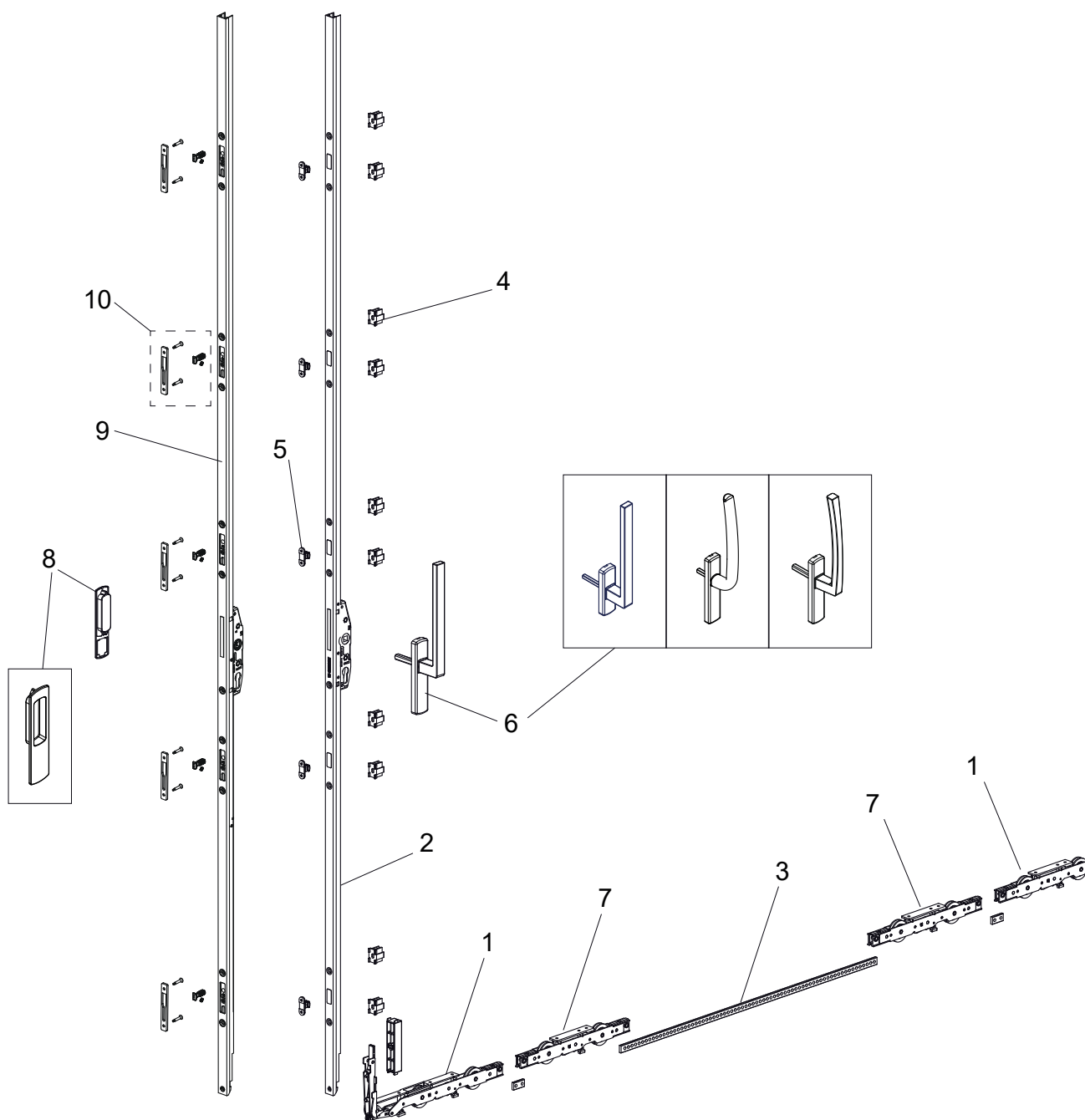

- 1 - Pulleys kit
- 2 - Drive gear
- 3 - Pulleys connection rod
- 4 - Shims
- 5 - Locking points
- 6 - Window handles
- 7 - Additional pulley (300 kg with 1 pulley; 400 kg with 2 pulleys)
- 8 - Recess handle
- 9 - Rod GS3000 Plus
- 10 - Locking point GS3000 Plus (nib+ counterplate)

OPENING SCHEMES

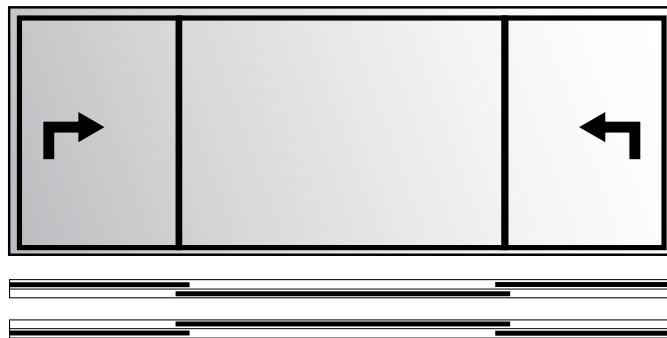
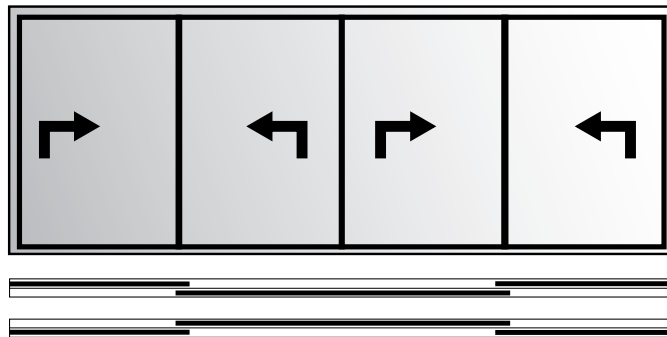
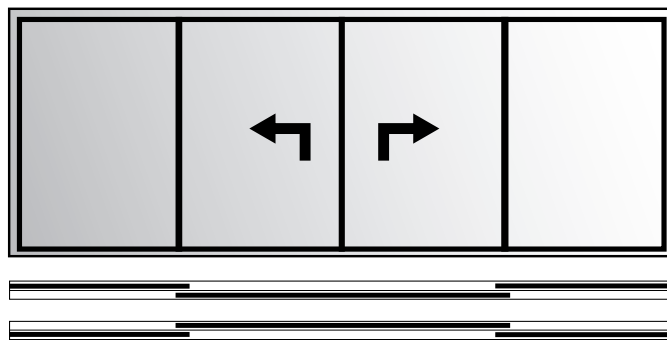
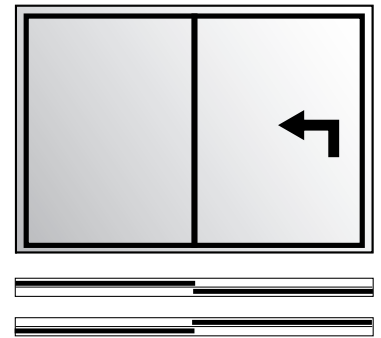
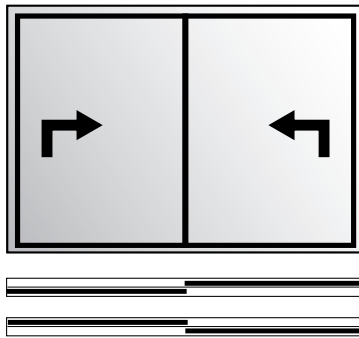
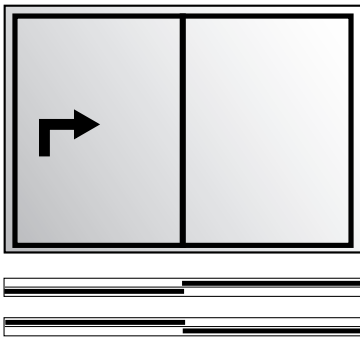

Note: Configurations with opposing sashes are not possible with GS3000 PLUS rods.

## GS3000-300 PULLEYS



### Functions

Reversible pulleys for GS3000 lift and slide system.

Online data sheet



### Technical features

Reversible two-wheel pulleys with lever type lifting device, to create operable sashes from 300 to 400 kg.

#### Pulleys 300/22

Set composed of a primary corner pulley, equipped with a toggle for sash lifting, and a secondary pulley.

Connection and drive of the secondary pulley occurs by means of a connection rod to be cut to length.

Compatible with drive gear with 27.5 and 37.5 mm backset and with window handles having 80 mm fixing C/C distance.

Complete with threaded bushings to fit on the drive gear for use with a single handle and in the external handle, for use of a double handle.

#### 300/22 additional pulley

Additional pulley, to combine with the 300/22 pulleys in the following cases:

- 1 additional pulley for sashes wider than 2500 mm and up to 300 kg
- 2 additional pulleys for sashes up to 400 kg with width >1300 mm

Connection to the other pulleys by means of the length of connection rod supplied.

The 300/22 pulleys and 300/22 additional pulley feature a wheel that is compatible with 2.5 mm radius rails.

Both equipped with special support components that keep the wheels raised from the track in the sash closed position.

Supplied complete with fixing screws, connection rod pin and rod guide.

### Connection rods

The connection rod transmits drive from the main pulley to the secondary pulley.

Available in three different sizes, to be cut in accordance with the sash width. Compatible with all pulley versions.

### Capacities

For sashes up to 400 kg.

### Materials

Pulley body in galvanised zamak

Stainless steel side covers

Stainless steel levers, connecting brackets and pins

Fibreglass-reinforced nylon wheels

Connection rod in zinc plated steel

Connection rod guides in fibreglass-reinforced nylon

Fixing screws, zinc-coated steel

Zinc plated steel bushings

Pulley support components in nylon

Pulleys connection rod in zinc plated steel

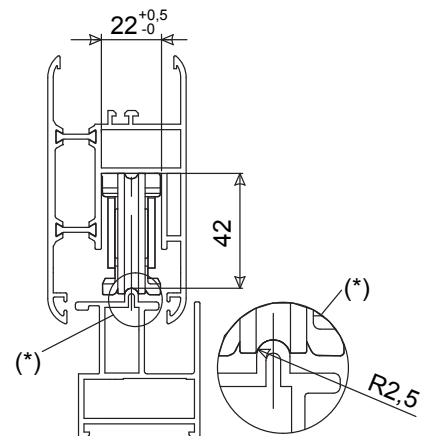

Pulleys 300/22

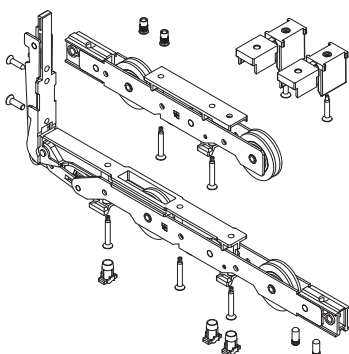

300/22 additional pulley

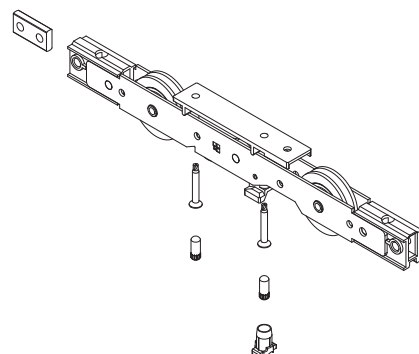

Art. 07101

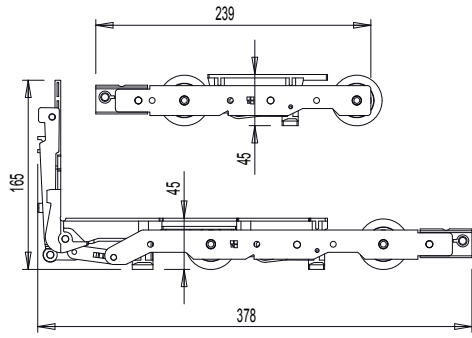

Art. 07102

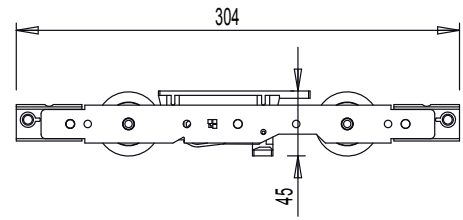

Standard assembly

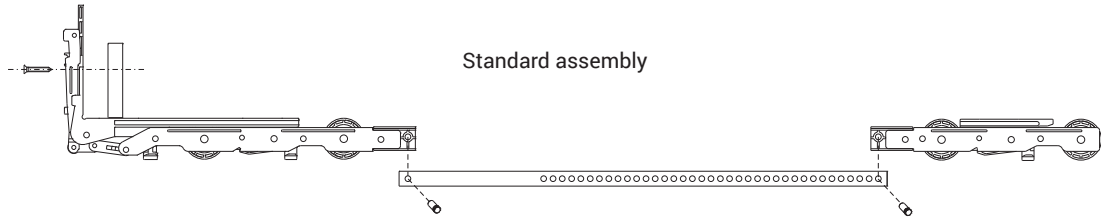

Assembly with 1 additional pulley (300 kg)

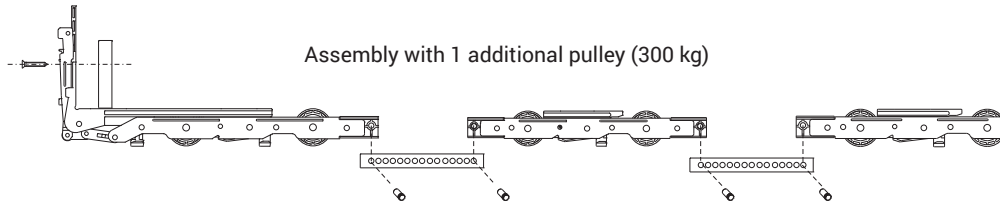

Assembly with 2 additional pulleys (400 kg)

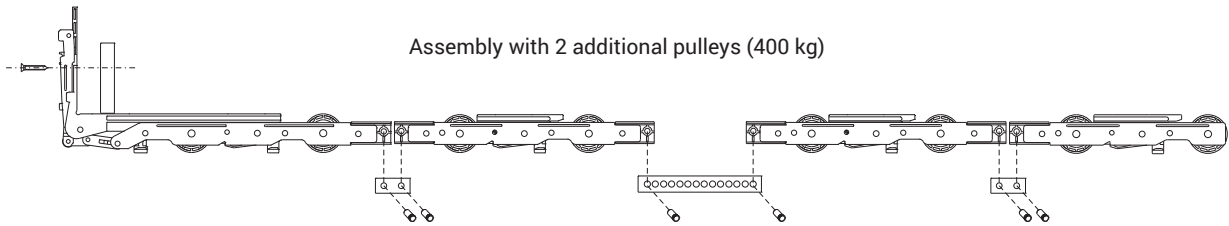

Pulleys connection rod

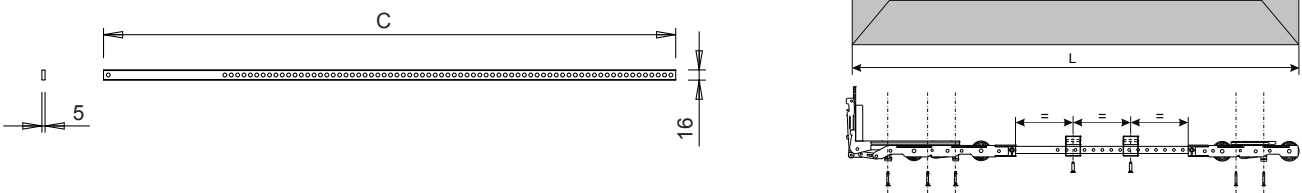

Item code	Description	Slot width (A)	Track height (B)	Max sash weight	Compatible with drive gear	Compatible with window handle C/C distance (I)	Base Raw	Anodised Elox	Painted	Trend/Gold Brass	Pieces per pack
07101	300/22 PULLEYS - GS3000	22 mm	42 mm	300 kg	E = 27.5 E = 37.5	80 mm	X				1
07102	ADDITIONAL PULLEY 300/22-GS3000	22 mm	42 mm	300 kg with 1 pulley 400 kg with 2 pulleys	E = 27.5 mm E = 37.5 mm	80 mm	X				1

Item code	Description	Rod length (C)	Sash width (L) (*)	Base Raw	Anodised Elox	Painted	Trend/Gold Brass	Pieces per pack
07146	PULLEYS CONNECTION ROD 900 - GS3000	900 mm	600 - 1500 mm	X				5
07147	PULLEYS CONNECTION ROD 1400 - GS3000	1400 mm	1501 - 2000 mm	X				5
07148	PULLEYS CONNECTION ROD 1900 - GS3000	1900 mm	2001 - 2500 mm	X				5

(\*) the dimensions are referred to the minimum and maximum sash width that can be constructed with the selected rod. When using additional pulleys the maximum permissible sash width is 3350 mm.

## DRIVING RODS AND LOCKING POINTS GS3000 PLUS



### Functions

Driving rods for GS3000 lift and slide system.  
They are characterized by the nibs that engage directly on the rod.

Online data sheet



### Technical features

Lift and slide casement lock for sashes from 150 to 400 kg (with additional pulleys) to select in accordance with profile width, weight and height of sash. Available in versions with 27.5 mm and 37.5 mm backset.

10 mm square pin.

Available in 6 alternative heights for each version.

Compatible with 150/300 kg pulleys and with window handles with 80 mm fixing c/c distance.

Pre-slotted front plate with up to 5 positions for combination with the locking points.

Cover extension available for all versions of drive gear, to fit to the casement in the hardware slot that the drive gear does not reach.

Allows the construction of sashes up to 3750 mm in height.

### Materials

Anodised aluminium front plate

Internal sliding rod in stainless steel

Body of zinc plated steel

Internal parts in zinc plated steel and brass

Anodised aluminium extension cover

### Machining on profile

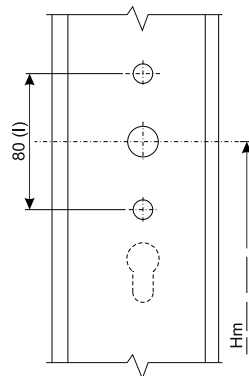
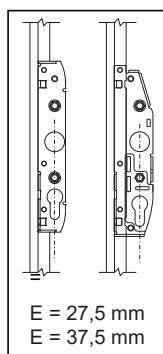

07220

07221

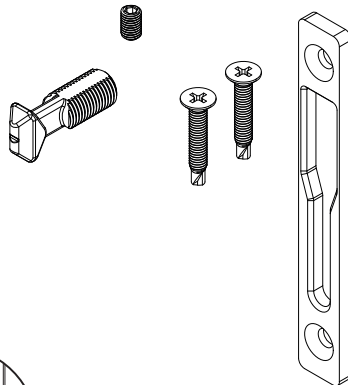

Drive gear with  
E = 27.5 mm

Drive gear with  
E = 37.5 mm

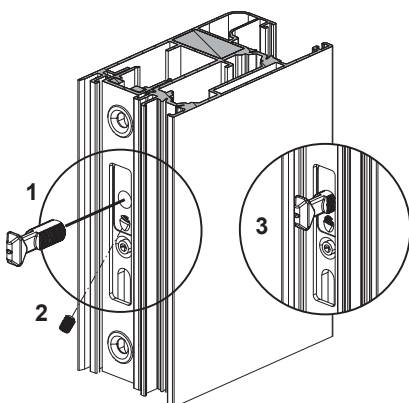
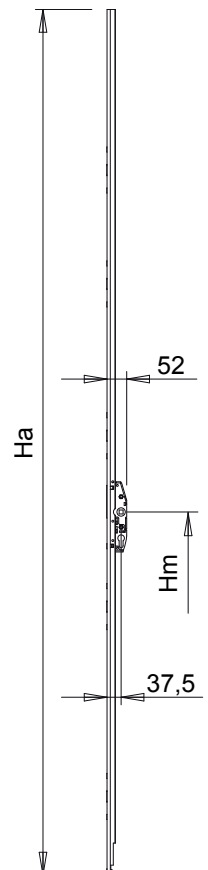
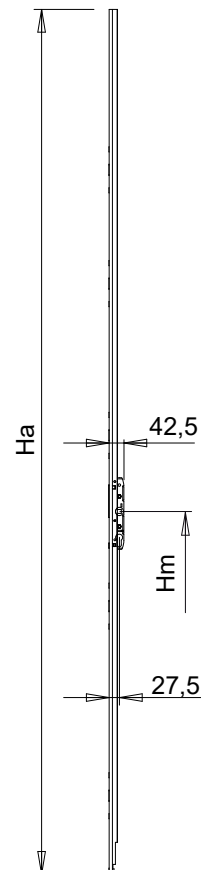

## GS3000 - 300/400 LIFT AND SLIDE

Item code	Description	Backset	Drive gear height (Ha)	Window handle positions (Hm)	Compatible with pulleys	Compatible with window handle C/C distance (l)	Key	Base Raw	Anodised Elox	Painted	Trend/Gold Brass	Pieces per pack
07205	DRIVING ROD KEY GS3000 PLUS	E =37.5 mm	1680 mm	355 mm	300/22 - 150/18 - 150/22	80 mm	YES	X				1
07206	DRIVING ROD KEY GS3000 PLUS	E =37.5 mm	1880 mm	655 mm	300/22 - 150/18 - 150/22	80 mm	YES	X				1
07207	DRIVING ROD KEY GS3000 PLUS	E =37.5 mm	1980 mm	955 mm	300/22 - 150/18 - 150/22	80 mm	YES	X				1
07208	DRIVING ROD KEY GS3000 PLUS	E =37.5 mm	2280 mm	956 mm	300/22 - 150/18 - 150/22	80 mm	YES	X				1
07209	DRIVING ROD KEY GS3000 PLUS	E =37.5 mm	2580 mm	955 mm	300/22 - 150/18 - 150/22	80 mm	YES	X				1
07210	DRIVING ROD KEY GS3000 PLUS	E =37.5 mm	2980 mm	955 mm	300/22 - 150/18 - 150/22	80 mm	YES	X				1
07211	DRIVING ROD KEY GS3000 PLUS	E =27.5 mm	1680 mm	356 mm	300/22 - 150/18 - 150/22	80 mm	YES	X				1
07212	DRIVING ROD KEY GS3000 PLUS	E =27.5 mm	1880 mm	656 mm	300/22 - 150/18 - 150/22	80 mm	YES	X				1
07213	DRIVING ROD KEY GS3000 PLUS	E =27.5 mm	1980 mm	956 mm	300/22 - 150/18 - 150/22	80 mm	YES	X				1
07214	DRIVING ROD KEY GS3000 PLUS	E =27.5 mm	2280 mm	956 mm	300/22 - 150/18 - 150/22	80 mm	YES	X				1
07215	DRIVING ROD KEY GS3000 PLUS	E =27.5 mm	2580 mm	956 mm	300/22 - 150/18 - 150/22	80 mm	YES	X				1
07216	DRIVING ROD KEY GS3000 PLUS	E =27.5 mm	2980 mm	956 mm	300/22 - 150/18 - 150/22	80 mm	YES	X				1

Item code	Description	Range	Base Raw	Anodised Elox	Painted	Trend/Gold Brass	Pieces per pack
07220	NIB GS 3000 PLUS	13 - 25 mm	X				10
07221	COUNTERPLATE GS 3000 PLUS	-	X				10

## DRIVING RODS AND LOCKING POINTS GS3000

### Functions

Driving rods and locking points to fit to frame for GS3000 lift and slide system.

Online data sheet



### Technical features

- Drive gears
- Lift locks for sashes from 150 to 400 kg (with additional pulleys) to select according to profile width, weight and height of sash.
- Available in versions with 27.5 mm and 37.5 mm backset.
- 10 mm square pin.
- Available in 6 alternative heights for each version.
- Compatible with 150/300 kg pulleys and with window handles with 80 mm fixing c/c distance.
- Pre-slotted front plate with up to 5 positions for combination with the locking points.
- Cover extension available for all versions of drive gear, to fit to the casement in the hardware slot that the drive gear does not reach.
- Allows the construction of sashes up to 3750 mm in height.

### Locking points

- Locking points to fit to frame in correspondence with the slots of the drive gear installed on the sash.
- Available in several version to be selected in accordance with the profile.
- When combined with the appropriate shims for the profile the locking points ensure an optimal sash / frame seal.
- The number of locking points required depends on the sash height and the selected drive gear.

### Materials

- Drive gears
  - Anodised aluminium front plate
  - Internal sliding rod in stainless steel
  - Body of zinc plated steel
  - Internal parts in zinc plated steel and brass
  - Anodised aluminium extension cover
- ### Locking points
- Nickel-plated brass locking point
  - Stainless steel shims
  - Nylon adapter (for opposing sashes version)
  - Stainless steel mounting plate (for opposing sashes version)
  - Stainless steel fixing screws

Machining on profile

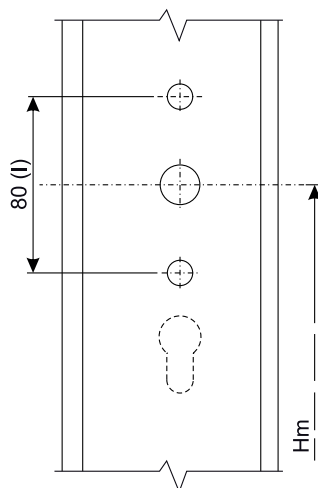
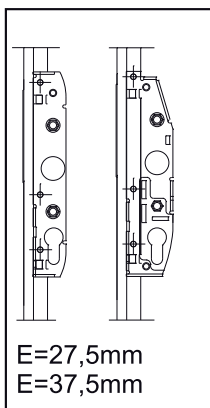

Drive gear with E = 27.5 mm

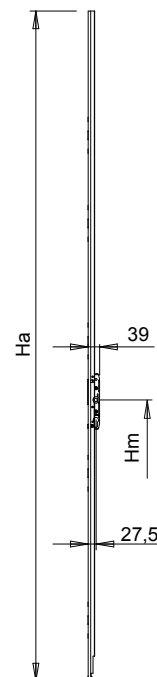

Drive gear with E = 37.5 mm

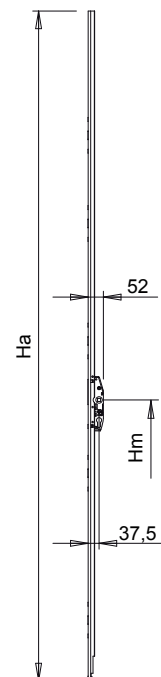



Fixed locking point

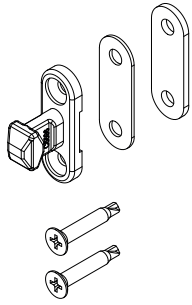

13-25 mm adjustable locking point

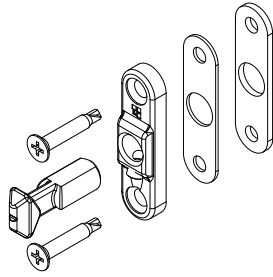

Locking point with Micro-ventilation

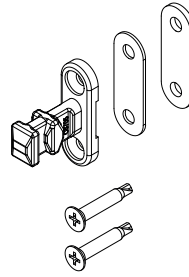

Locking point for opposing sashes

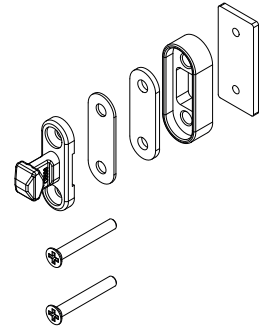

Assembly of fixed locking point

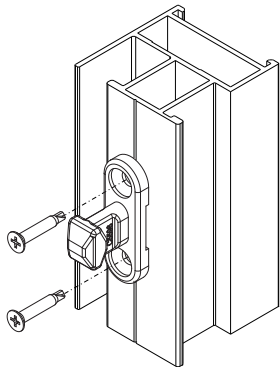

Assembly of 13-25 mm adjustable locking point

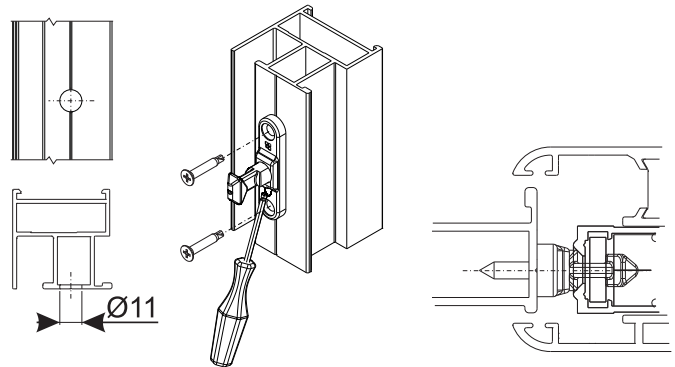

Assembly of Micro-ventilation locking point

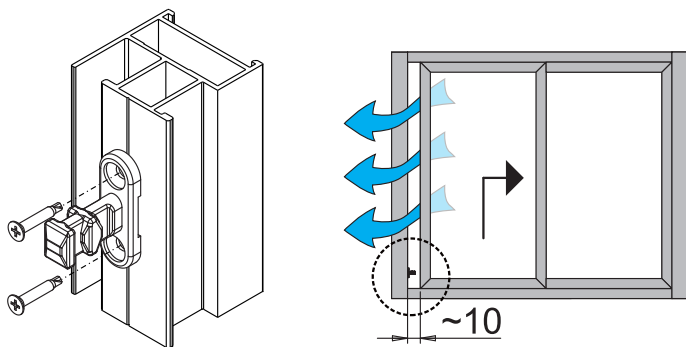

Assembly of locking point for opposing sashes

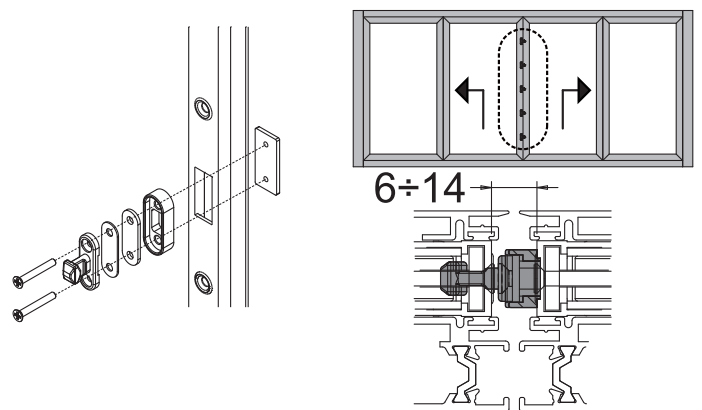

## GS3000 - 300/400 LIFT AND SLIDE

Item code	Description	Backset	Drive gear height (Ha)	Window handle positions (Hm)	Compatible with pulleys	Compatible with window handle C/C distance (l)	Key	Base Raw	Anodised Elox	Painted	Trend/Gold Brass	Pieces per pack
07105	DRIVE GEAR KEY H170 E37.5-GS3000	37.5 mm	1680 mm	354 mm	300/22	80 mm	YES	X				1
07106	DRIVE GEAR KEY H190 E37.5-GS3000	37.5 mm	1880 mm	654 mm	300/22	80 mm	YES	X				1
0710701	DRIVE GEAR KEY H200 E37.5-GS3000	37.5 mm	1980 mm	954 mm	300/22	80 mm	YES	X				1
0710801	DRIVE GEAR KEY H230 E37.5-GS3000	37.5 mm	2280 mm	954 mm	300/22	80 mm	YES	X				1
0710901	DRIVE GEAR KEY H260 E37.5-GS3000	37.5 mm	2580 mm	954 mm	300/22	80 mm	YES	X				1
0711001	DRIVE GEAR KEY H300 E37.5-GS3000	37.5 mm	2980 mm	954 mm	300/22	80 mm	YES	X				1
07133	DRIVE GEAR KEY H170 E27.5-GS3000	27,5 mm	1680 mm	354 mm	300/22	80 mm	YES	X				1
07134	DRIVE GEAR H190 E27.5-GS3000	27,5 mm	1880 mm	654 mm	300/22	80 mm	YES	X				1
0713501	DRIVE GEAR KEY H200 E27.5-GS3000	27,5 mm	1980 mm	954 mm	300/22	80 mm	YES	X				1
0713601	DRIVE GEAR KEY H230 E27.5-GS3000	27,5 mm	2280 mm	954 mm	300/22	80 mm	YES	X				1
0713701	DRIVE GEAR KEY H260 E27.5-GS3000	27,5 mm	2580 mm	954 mm	300/22	80 mm	YES	X				1
0713801	DRIVE GEAR KEY H300 E27.5-GS3000	27,5 mm	2980 mm	954 mm	300/22	80 mm	YES	X				1
07161	GS3000 ROD EXTENSION COVER	-	650 mm	-	-	-	NO	X				5
07122	GS3000 WINDOW HANDLE DAMPER	-	-	-	-	-	-	X				10

Item code	Description	Range	Base Raw	Anodised Elox	Painted	Trend/Gold Brass	Pieces per pack
07149	FIXED LOCKING POINT	13 - 16 mm	X				10
07150	ADJUSTABLE LOCKING POINT	13 - 25 mm	X				10
07151	MICRO-VENTILATION LOCKING POINT	13 - 16 mm	X				10
07152	OPPOSING SASHES LOCKING POINT	13 - 16 mm	X				10

**GS3000 SHIMS**

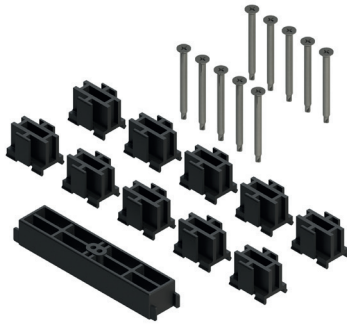

**Functions**

Profile shims for drive gear and main pulley for GS3000 lift and slide system.

Online data sheet



**Technical features**

Set of adapters to combine with the drive gear and main pulley to fit the hardware in the profile groove.

Available in various sizes to be selected in accordance with the profile, drive gear and type of locking point employed.

Each set of shims consists of:

- 10 shims to install on drive gear
- 1 shim to install on main pulley
- self-threading fixing screws

**Materials**

Polyamide shims

Zinc plated steel self-threading screws

Stainless steel grub screws

Side container shims available to lodge the pulleys in a stable position inside special profile slots without any lateral containment.

The shims are fixed to the profile using grub screws.

Shims available to combine with the fixed locking point and locking point with micro-ventilation.

Art. 07153

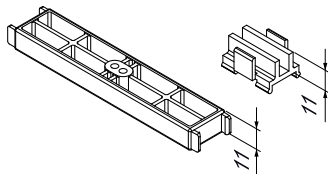

Art. 07154

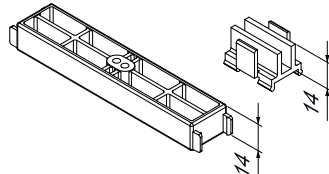

Art. 07155

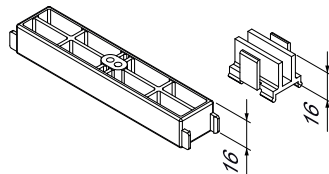

Art. 07156

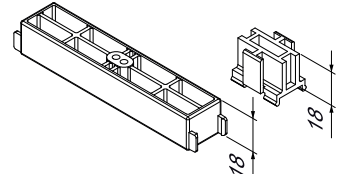

Art. 07157

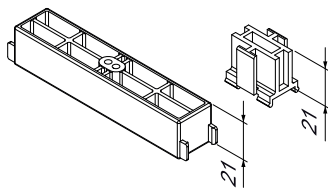

Art. 07158

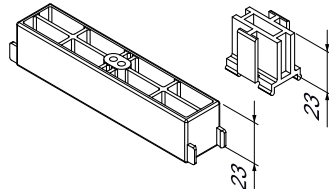

Art. 07159

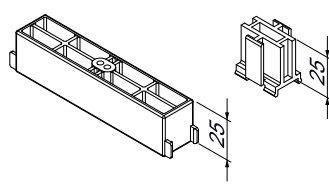

Art. 07160

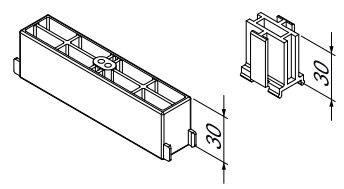

Art. 07162

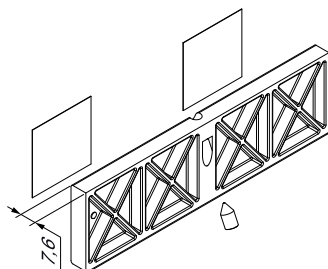

Art. 07163

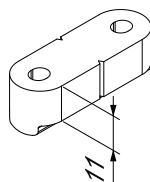

Shim fitting for locking point

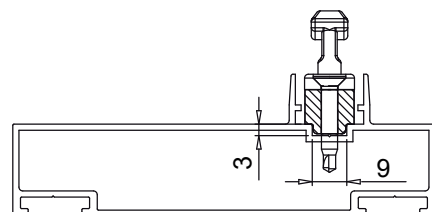

# GS3000 - 300/400 LIFT AND SLIDE

Lateral container shims assembly diagram

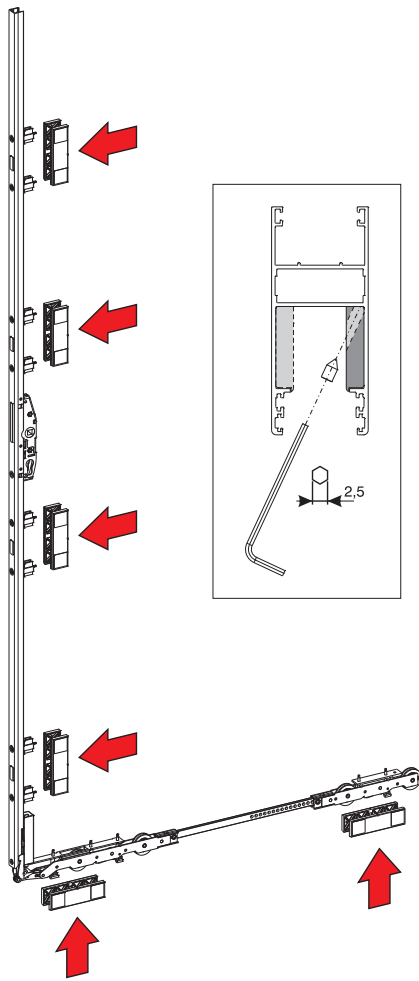

Assembly of main pulley shim

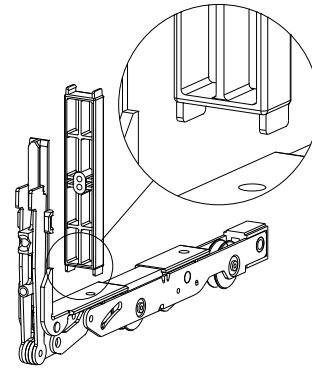

Assembly of shims to drive gear

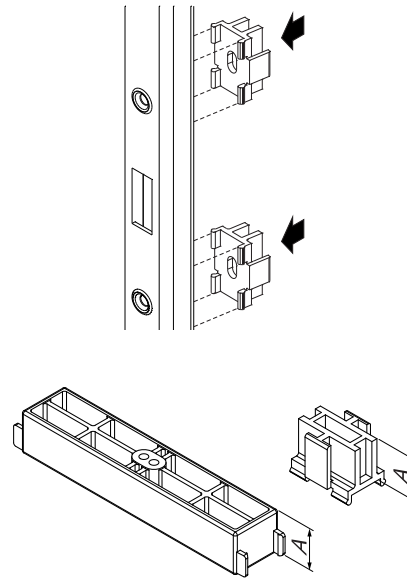

Item code	Description	Dimension (A)	Base Raw	Anodised Elox	Painted	Trend/Gold Brass	Pieces per pack
07153	SHIMS 11 FOR ROD AND PULLEY-GS3000	11 mm	X				1
07154	SHIMS 14 FOR ROD AND PULLEY-GS3000	14 mm	X				1
07155	SHIMS 16 FOR ROD AND PULLEY-GS3000	16 mm	X				1
07156	SHIMS 18 FOR ROD AND PULLEY-GS3000	18 mm	X				1
07157	SHIMS 21 FOR ROD AND PULLEY-GS3000	21 mm	X				1
07158	SHIMS 23 FOR ROD AND PULLEY-GS3000	23 mm	X				1
07159	SHIMS 25 FOR ROD AND PULLEY-GS3000	25 mm	X				1
07160	SHIMS 30 FOR ROD AND PULLEY-GS3000	30 mm	X				1
07162	PULLEY SHIM - GS3000	-	X				20
07163	SHIM FOR LOCKING POINT - GS3000	-	X				20

**GS3000 MACHINING COVER CAPS**

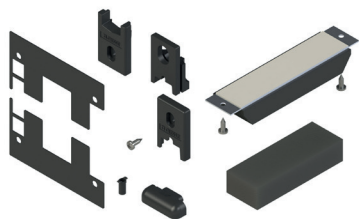

**Functions**

Machining cover caps for GS3000 lift and slide system.

Online data sheet



**Technical features**

The machining cover caps kit contains all the components required to complete a two-sash lift and slide casement:

- top dust-proof plug and lower central sponge to fit in frame, in correspondence with the central labyrinth, to restrict the circulation of dust and passage of air
- top and bottom cover caps to conceal machinings on sash central upright
- lower sealing buffers to increase seal on track
- drainage cap, to fit to the frame lower cross-beam for fast drainage of water from the frame groove to outside the room
- sealing plates to seal the joint between stile and cross-beam in frames with 90° cut
- drainage tubes to position on frame lower cross-beam

**Materials**

- Top dust-proof plug composed of plastic body with sponge
- Central lower sponge in expanded rubber
- Stainless steel screws
- Machining cover caps and anti-lifting plugs in fibreglass-reinforced polyamide
- Lower sealing buffers in rubber
- Cap and drainage tubes in fibreglass-reinforced polyamide
- Sealing plates in adhesive rubber
- Rubber dampers

A central and anti-lifting plugs kit is also available, composed of:

- top dust-proof plug and lower central sponge to fit in frame, in correspondence with the central labyrinth, to restrict the circulation of dust and passage of air
- top and bottom machining cover caps equipped with buffers to absorb closing impact between sash and frame
- anti-lifting plug to be fitted in frame top corner. Designed to prevent sash from being removed simply by lifting it from bottom track
- anti-lifting shims to fit in correspondence with sash side stile

Machining cover kit for 2-sash lift and slide casement

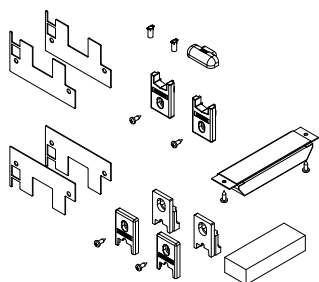

Machining cover and anti-lifting kit

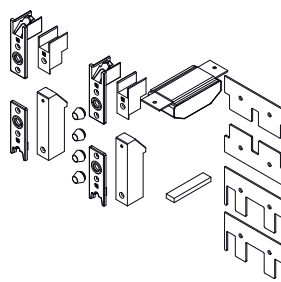

Lower machining cover caps

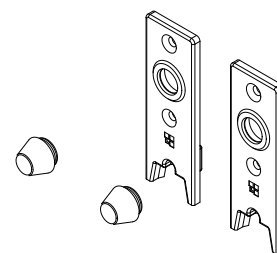

Item code	Description	Note	Base Raw	Anodised Elox	Painted	Trend/Gold Brass	Pieces per pack
07164	MACHINING COVER CAPS KIT GS3000		X				5
07967	MACHINING COVER CAPS KIT GS3000		X				5
0797701	CENTRAL ANTI-LIFTING PLUGS KIT -GS3000		X				5
07978	CENTRAL ANTI-LIFTING PLUGS KIT -GS3000		X				5

**KORA WINDOW HANDLE GS3000-300**

**Functions**

Window handles for GS3000-300 lift and slide system.

Online data sheet



**Technical features**

Long window handles for lift and slide window with KORA style to construct sashes up to 400 kg.  
 10 mm square pin.  
 80 mm fixing C/C distance.  
 Available in single version with and without key and in double version with key.  
 Compatible with driving rod with 27.5 and 37.5 mm backset.  
 Can be combined with recess handles with 80 mm C/C distance.

**Materials**

Aluminium handle and cover  
 Zamak case  
 Rotor made of zinc-plated steel  
 Trim ring made of acetal resin  
 Square pin in zinc plated steel  
 Fixing screws, zinc-coated steel

KORA window handle L240 -I80



KORA window handle dimensions L240 -I80

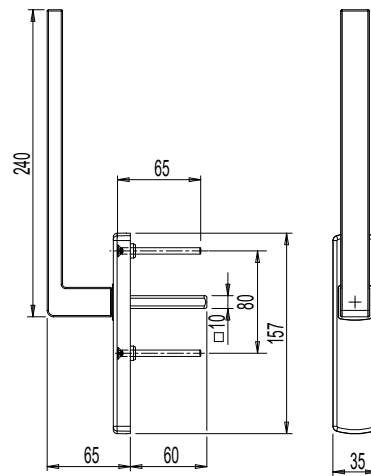

KORA window handle L240 KEY -I80



KORA window handle dimensions L240 KEY -I80

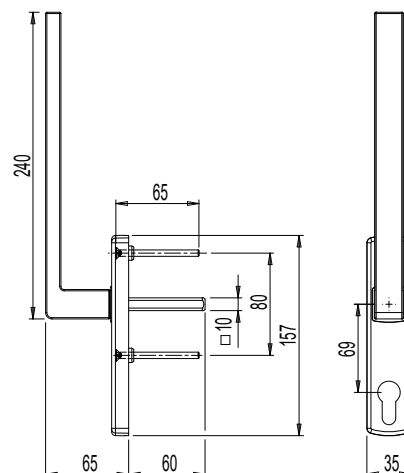

KORA window handle L240 CP -I80

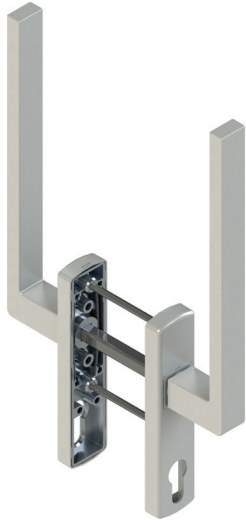

KORA window handle dimensions L240 CP -I80

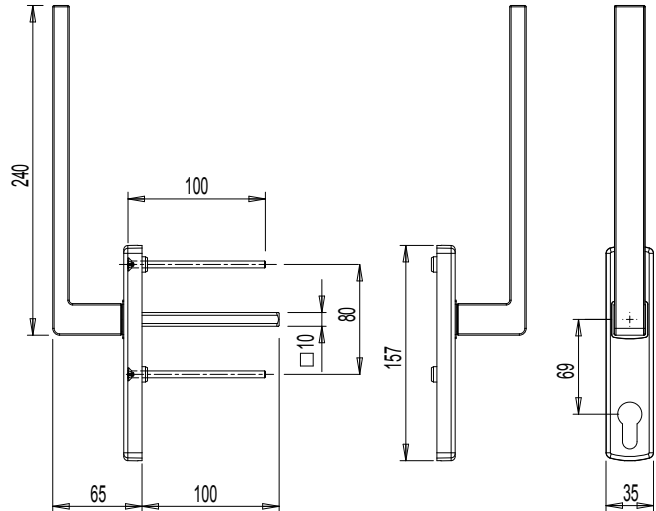

Recess handle



Recess handle dimensions

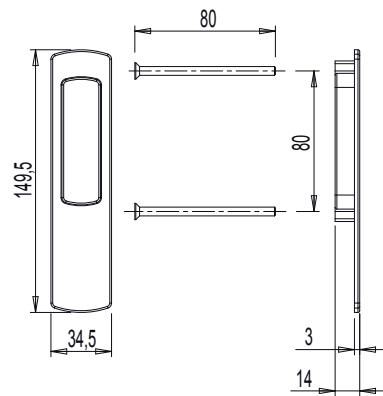

Item code	Description	C/C distance (l)	Handle length (L)	Compatible with drive gear	Base Raw	Anodised Elox	Painted	Trend/Gold Brass	Pieces per pack
0246801	KORA WINDOW HANDLE L240-I80 GS3000	80 mm	240 mm	E = 27.5mm/E = 37.5mm	X	X	X	X	1
0246901	KORA WINDOW HANDLE L240 KEY-I80 GS3000	80 mm	240 mm	E = 27.5mm/E = 37.5mm	X	X	X	X	1
0247001	KORA WINDOW HANDLE L240-I80 GS3000 (PAIR)	80 mm	240 mm	E = 27.5mm/E = 37.5mm	X	X	X	X	1
0799501	RECESS HANDLE	80 mm	-	E = 27.5mm/E = 37.5mm	X		X	X	5

ASIA WINDOW HANDLE GS3000-300

Functions

Window handles for GS3000-300 lift and slide system.

Online data sheet



Technical features

Long window handles for lift and slide window with ASIA style to construct sashes up to 400 kg.  
 10 mm square pin.  
 80 mm fixing C/C distance.  
 Available in single version with and without key and in double version with key.  
 Compatible with driving rod with 27.5 and 37.5 mm backset.  
 Can be combined with recess handles with 80 mm C/C distance.

Materials

Aluminium handle and cover  
 Zamak case  
 Rotor made of zinc-plated steel  
 Trim ring made of acetal resin  
 Square pin in zinc plated steel  
 Fixing screws, zinc-coated steel

ASIA window handle L240 -I80



ASIA window handle dimensions L240 -I80

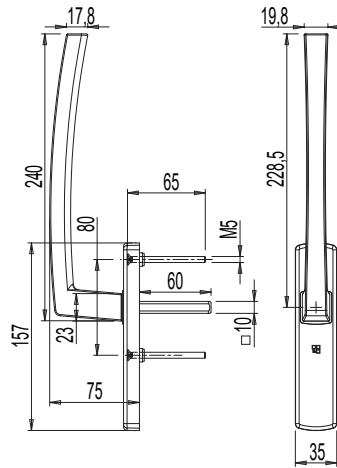

ASIA window handle L240 KEY-I80



ASIA window handle dimensions L240 KEY -I80

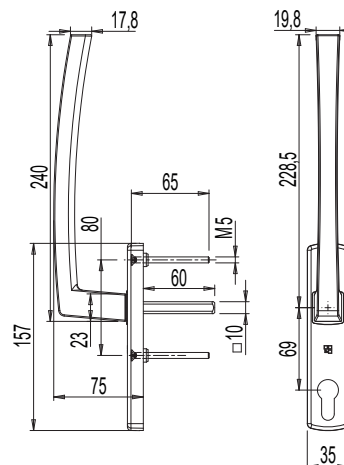



ASIA window handle L240 CP -I80



ASIA window handle dimensions L240 CP -I80

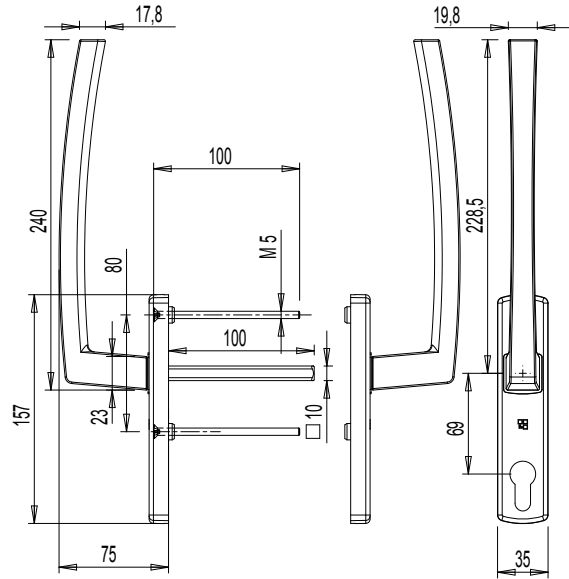

Recess handle



Recess handle dimensions

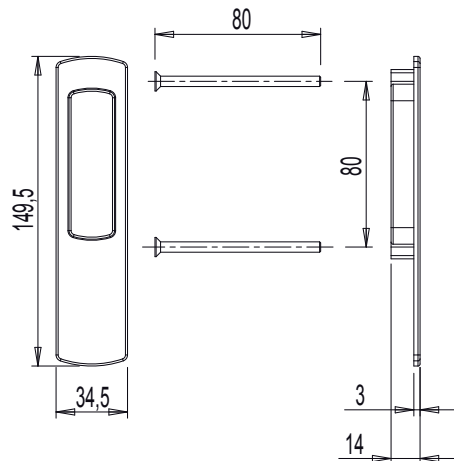

Item code	Description	C/C distance (l)	Handle length (L)	Compatible with drive gear	Base Raw	Anodised Elox	Painted	Trend/Gold Brass	Pieces per pack
0244601	ASIA WINDOW HANDLE L240-I80 GS3000	80 mm	240 mm	E = 27.5mm/E = 37.5mm	X	X	X	X	1
0244701	ASIA WINDOW HANDLE L240 KEY-I80 GS3000	80 mm	240 mm	E = 27.5mm/E = 37.5mm	X	X	X	X	1
0244801	ASIA WINDOW HANDLE L240-I80 GS3000 (PAIR)	80 mm	240 mm	E = 27.5mm/E = 37.5mm	X	X	X	X	1
0799501	RECESS HANDLE	80 mm	-	E = 27.5mm/E = 37.5mm	X		X	X	5

**PRIMA WINDOW HANDLE GS3000-300**

**Functions**

Window handles for GS3000-300 lift and slide system.

Online data sheet



**Technical features**

Long window handles for lift and slide window with PRIMA style to construct sashes up to 400 kg.  
 10 mm square pin.  
 80 mm fixing C/C distance.  
 Available in single version with and without key and in double version with key.  
 Compatible with driving rod with 27.5 and 37.5 mm backset.  
 Can be combined with recess handles with 80 mm C/C distance.

**Materials**

Aluminium handle and cover  
 Zamak case  
 Rotor made of zinc-plated steel  
 Trim ring made of acetal resin  
 Square pin in zinc plated steel  
 Fixing screws, zinc-coated steel

PRIMA window handle L240 -I80



PRIMA window handle dimensions L240 -I80

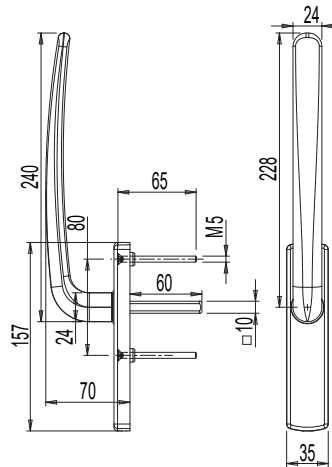

PRIMA window handle L240 KEY-I80



PRIMA window handle dimensions L240 KEY -I80

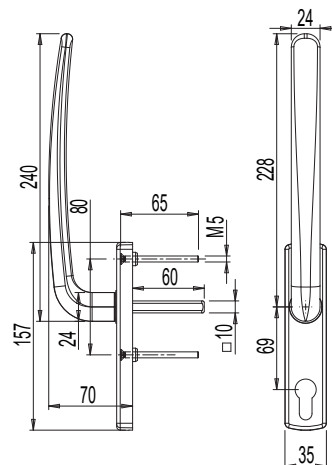

PRIMA window handle L240 CP -I80



PRIMA window handle dimensions L240 CP -I80

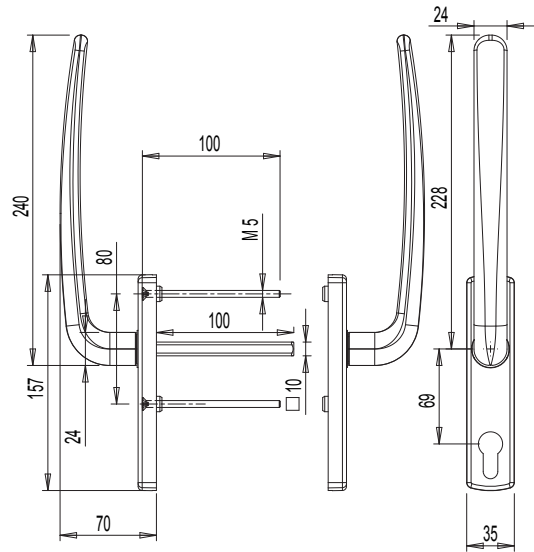

Recess handle



Recess handle dimensions

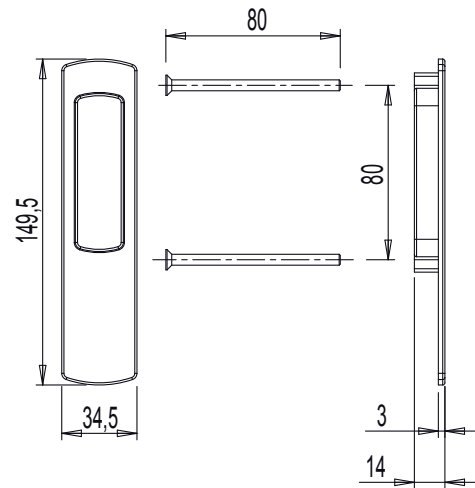

Item code	Description	C/C distance (l)	Handle length (L)	Compatible with drive gear	Base Raw	Anodised Elox	Painted	Trend/Gold Brass	Pieces per pack
0243701	PRIMA WINDOW HANDLE L240-I80 GS3000	80 mm	240 mm	E = 27.5mm/E = 37.5mm	X	X	X	X	1
0243801	PRIMA WINDOW HANDLE L240 KEY-I80 GS3000	80 mm	240 mm	E = 27.5mm/E = 37.5mm	X	X	X	X	1
0243901	PRIMA WINDOW HANDLE L240-I80 GS3000 (PAIR)	80 mm	240 mm	E = 27.5mm/E = 37.5mm	X	X	X	X	1
0799501	RECESS HANDLE	80 mm	-	E = 27.5mm/E = 37.5mm	X		X	X	5