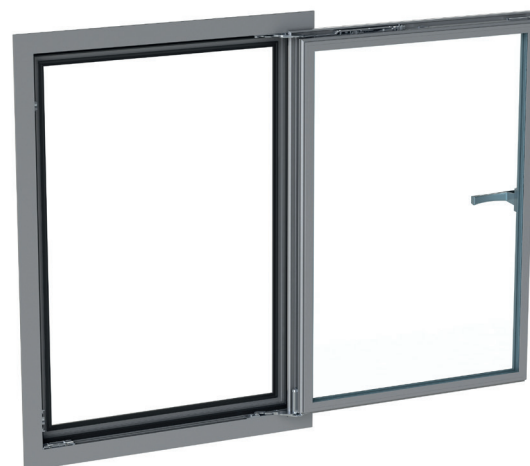

CHIC 3D 130 ERRE

Functions

Complete system for the construction of concealed tilt-and-turn windows with load capacities of up to 130 kg and with 180° sash opening. Available in the standard, logic and micro-ventilation versions.

CHIC 130

**Technical Features**

Making a CHIC 3D 130 ERRE Tilt-and-Turn mechanism requires:

1. Set of hinges + arms
2. Set of mechanisms for cremones, window handles and SUPRA 7 window handles
3. Cremone, window handle or SUPRA 7 window handle (available in different models to choose from in the specific catalogue section)

Adjustments

The adjustments are micrometric and independent.

Standard microventilation

Micro-ventilation enables having simultaneously both the tilt-and-turn position and micro-ventilation (precision opening of the sash) on the casement, for better air exchange.

Logica

The logical operation consists in first tilt-and-turn opening (with the cremone at 90°) and secondly side-hung opening (with the cremone at 180°). Its use is particularly recommended in public buildings (schools, hospitals, etc.) in combination with a cremone with a key in order to have only tilt-and-turn window opening for safety reasons and to allow full opening only for staff with the key.

Production micro-ventilation with standard opening

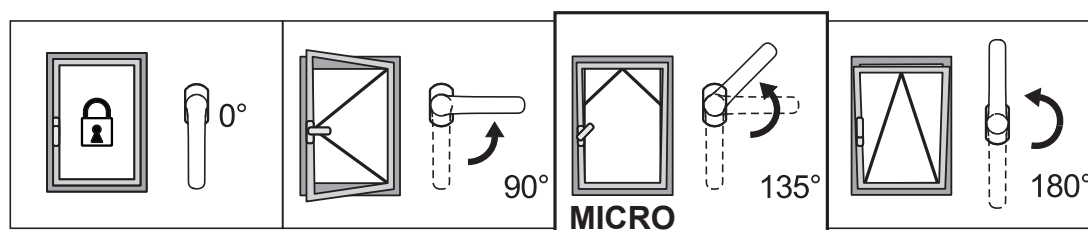

Production micro-ventilation with Logica opening

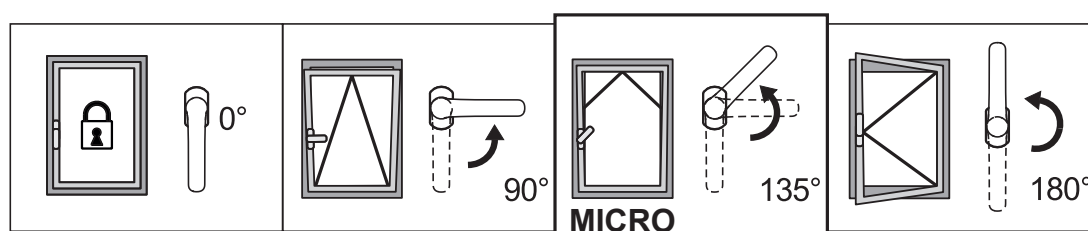

ADJUSTMENTS [mm]

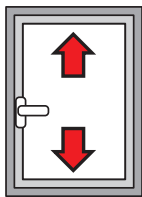

Height:
+2.5 / -1

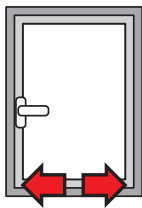

Side:
±1.5

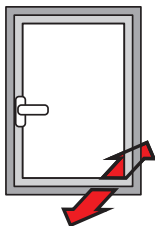

Bottom hinge compression:
+1.4 / -0.6

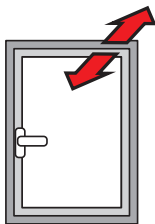

Top hinge compression:
±1.5

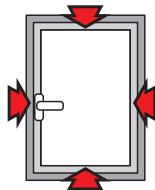

Striker compression:
±1,2

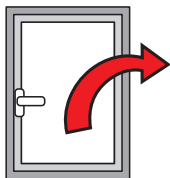

Sash fall:
+3.5 / -1.5

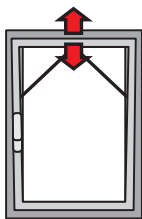

Micro-ventilation:
+3,6 / -0,6

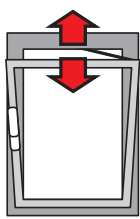

T2 arm opening:
148 ÷ 178

Table of maximum glass thickness [mm]

2800	35	29	25	22	19	17	16	14	13	12	12	
2700	37	31	26	23	20	18	17	15	14	13	12	
2600	39	32	28	24	21	19	18	16	15	14	13	12
2500	43	35	30	27	24	21	19	18	16	15	14	13
2400	43	35	30	27	24	21	19	18	16	15	14	13
2300	44	37	32	28	25	22	20	18	17	16	15	14
2200	46	39	33	29	26	23	21	19	18	17	15	14
2100	49	40	35	30	27	24	22	20	19	17	16	15
2000	51	43	36	32	28	26	23	21	20	18	17	16
1900	54	45	38	34	30	27	24	22	21	19	18	17
1800	57	47	40	35	31	28	26	24	22	20	19	18
1700	60	50	43	38	33	30	27	25	23	21	20	18
1600	60	53	46	40	35	32	29	27	25	23	21	18
1500	60	57	49	43	38	34	31	28	26	24	21	18
1400	60	60	52	46	40	36	33	30	28	24	21	18
1300	60	60	56	49	44	39	36	33	28	24	21	18
1200	60	60	60	53	47	43	39	33	28	24	21	
1100	60	60	60	58	52	46	39	33	28	24		
1000	60	60	60	60	57	47	39	33	28			
900	60	60	60	60	58	47	39	33				
800	60	60	60	60	58	47	39					
700	60	60	60	60	58	47						
600	500	600	700	800	900	1000	1100	1200	1300	1400	1500	1600

Table of maximum load capacity [kg]

2800	124	124	124	124	124	124	124	124	124	124	124		
2700	126	126	126	126	126	126	126	126	126	126	126		
2600	128	128	128	128	128	128	128	128	128	128	128	128	
2500	130	130	130	130	130	130	130	130	130	130	130	130	
2400	130	130	130	130	130	130	130	130	130	130	130	130	
2300	130	130	130	130	130	130	130	130	130	130	130	130	
2200	130	130	130	130	130	130	130	130	130	130	130	130	
2100	130	130	130	130	130	130	130	130	130	130	130	130	
2000	130	130	130	130	130	130	130	130	130	130	130	130	
1900	130	130	130	130	130	130	130	130	130	130	130	130	
1800	130	130	130	130	130	130	130	130	130	130	130	130	
1700	130	130	130	130	130	130	130	130	130	130	130	127	
1600	130	130	130	130	130	130	130	130	130	130	127	119	
1500	130	130	130	130	130	130	130	130	130	128	119	112	
1400	130	130	130	130	130	130	130	130	130	129	119	111	
1300	130	130	130	130	130	130	130	129	119	111	103	97	
1200	130	130	130	130	130	130	130	119	110	102	95		
1100	130	130	130	130	130	130	119	109	101	94			
1000	130	130	130	130	130	119	108	99	92				
900	130	130	130	130	119	107	98	90					
800	130	130	130	119	106	95	87						
700	130	130	119	104	93	84							
600	450	500	600	700	800	900	1000	1100	1200	1300	1400	1500	1600

CHIC 130

CHIC 3D 130 ERRE standard

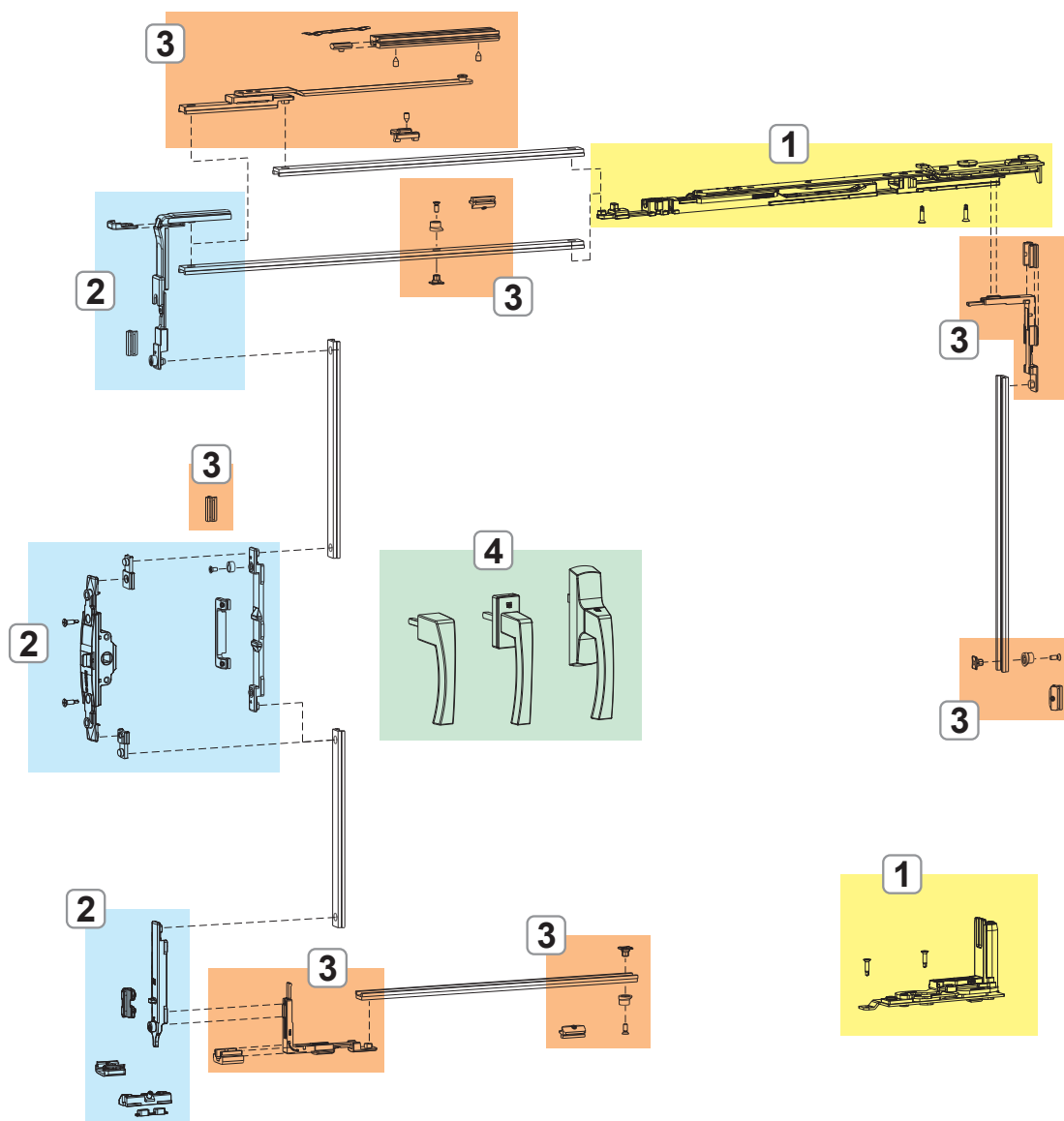

- 1. CHIC 3D 130 HINGES AND ARMS ERRE
- 2. CHIC 3D 130 ERRE FASTENING MECHANISMS
- 3. NP SUPRA CREMONES, WINDOW HANDLES AND MECHANISMS
- 4. CHIC 3D 130 ADDITIONAL FASTENING MECHANISMS AND HARDWARE

CHIC 130

CHIC 3D 130 ERRE logica

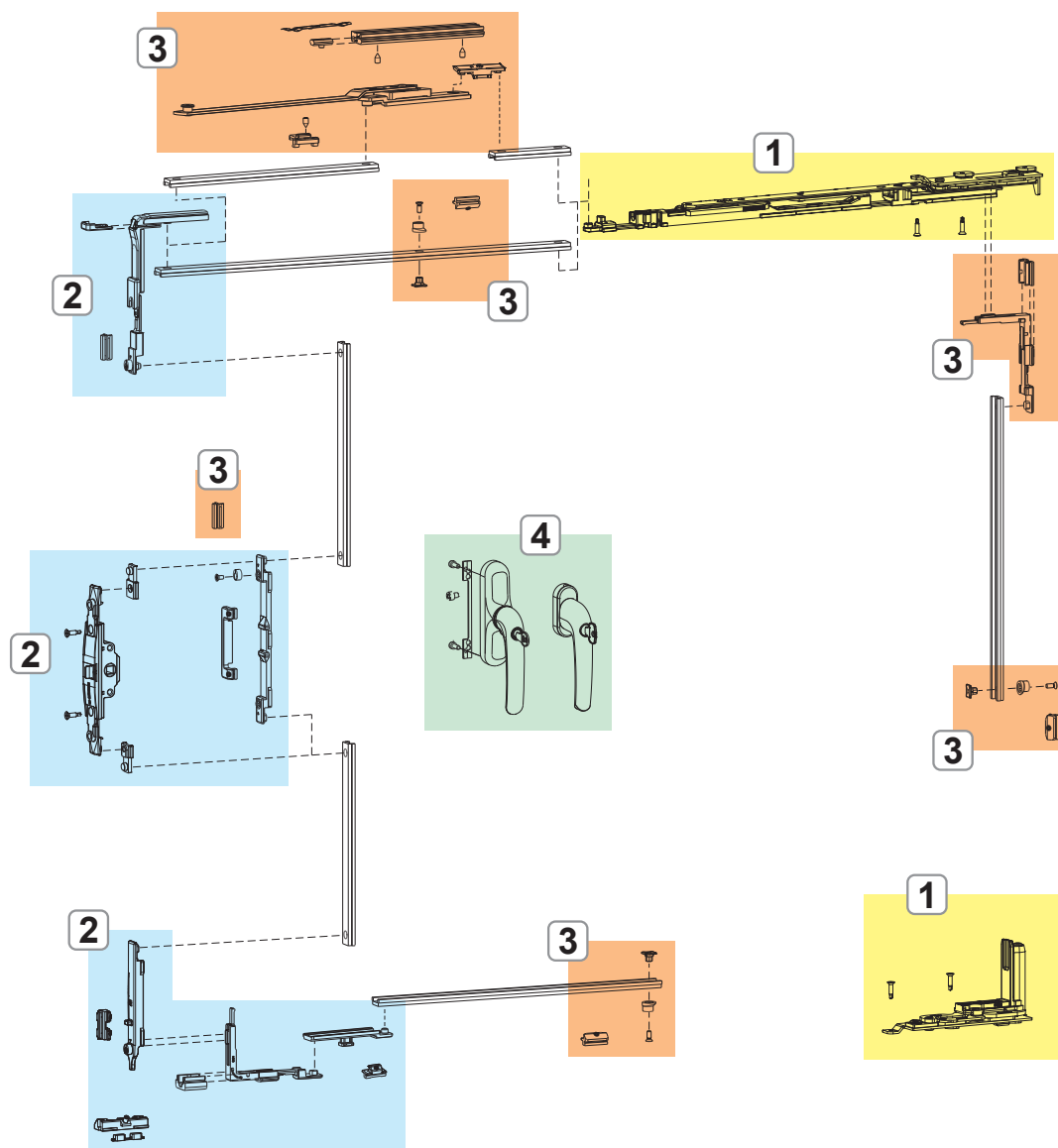

- 1. CHIC 3D 130 HINGES AND ARMS ERRE
- 2. CHIC 3D 130 ERRE FASTENING MECHANISMS
- 3. NP SUPRA CREMONES, WINDOW HANDLES AND MECHANISMS
- 4. CHIC 3D 130 ADDITIONAL FASTENING MECHANISMS AND HARDWARE

CHIC 3D 130 HINGES AND ARMS ERRE

Functions

Set of hinges (top and bottom), completely pre-assembled and ready to be installed on the profile.

Technical Features

They enable tilt-and-turn opening combined with the mechanisms.

Micro-ventilation and logica versions.

The arm is equipped with micro-ventilation as standard (adjustable).

Moving the fastening pawl takes the arm from conventional to logica.

The T2 arm is adjustable: the opening "A" goes from 178 mm (base) to 148 mm.

Materials

Corner support made of zamak

Connecting brackets and hinge plates made of zinc plated steel

Pins made of 304 grade stainless steel and aluminium bronze

Cams made of zinc plated steel

Connecting bracket and arm rod made of 304 grade stainless steel

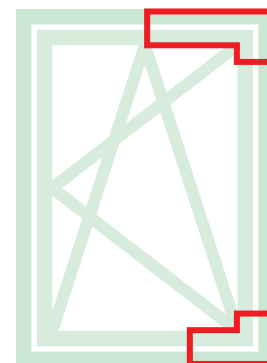

Online data sheet

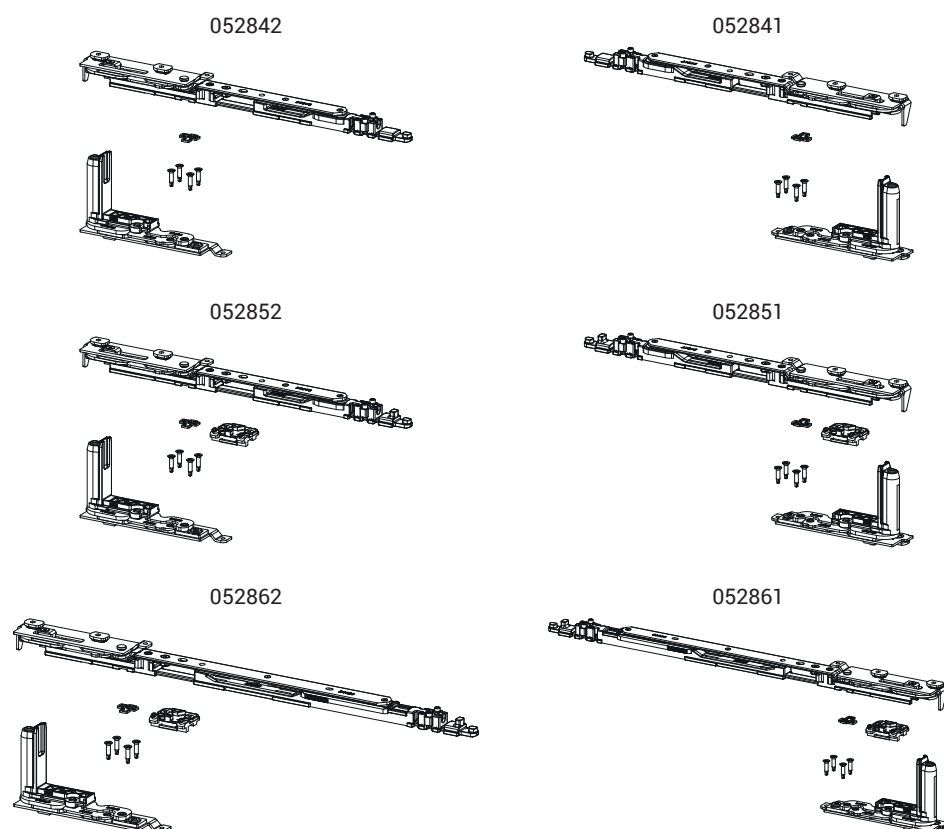

Sash opening

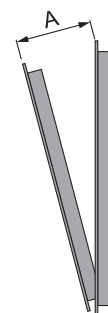

Item code	Description	PROFILE CROSS - SECTION	Range (mm)	Version	A (mm)	Hand	Base Raw	Anodised Elox	Painted	Trend/Gold Brass	Pieces per pack
052841	CHIC 130 ERRE - T1 ARM T&T KIT	C007	L 450 ÷ 475	-	98	RX	X				10
052842	CHIC 130 ERRE - T1 ARM T&T KIT	C007	L 450 ÷ 475	-	98	LX	X				10
052851	CHIC 130 ERRE - T1 ARM T&T KIT	C007	L 475 ÷ 700	Micro	98	RX	X				10
052852	CHIC 130 ERRE - T1 ARM T&T KIT	C007	L 475 ÷ 700	Micro	98	LX	X				10
052861	CHIC 130 ERRE - T2 ARM T&T KIT	C007	L 600 ÷ 1600	Micro	148÷178	RX	X				10
052862	CHIC 130 ERRE - T2 ARM T&T KIT	C007	L 600 ÷ 1600	Micro	148÷178	LX	X				10

CHIC 3D 130 FASTENING MECHANISMS ERRE

Functions

Tilt-and-turn window fastening mechanisms for Cremone, window handle and SUPRA 7 window handle, available in Base and Logica versions.

Materials

Drive, drive rod, mechanism bolt tip and strikers in zamak with GS Silver Plus finish (up to 500 h of corrosion resistance).
Screws and grub screws in stainless steel.
Polyamide raiser.

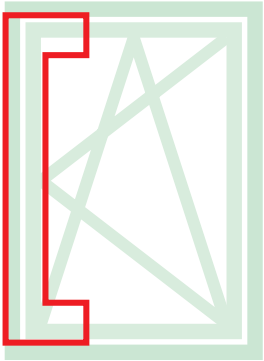

Online data sheet

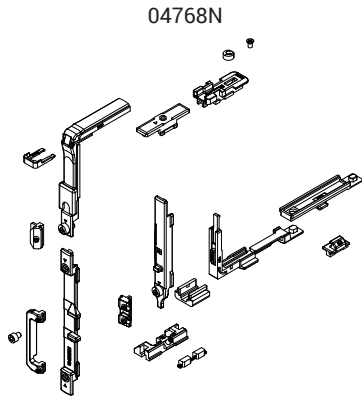
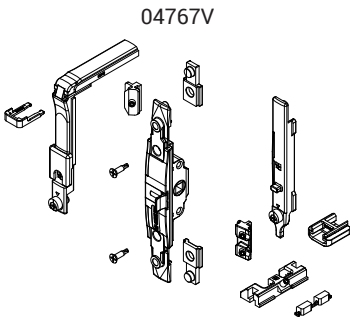
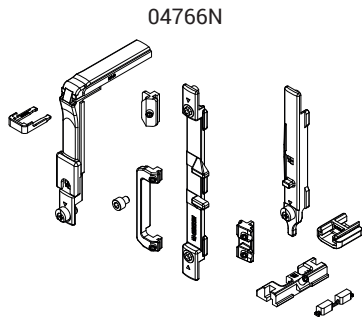

Item code	Description	PROFILE CROSS - SECTION	Mechanism	Version	Base Raw	Anodised Elox	Painted	Trend/Gold Brass	Pieces per pack
04766N	T/T FASTENING MECHANISM	C007	Cremone	-	X				10
04767V	T/T M 180 FASTENING MECHANISM	C007	Window handle	-	X				10
04768N	T/T LOGICA FASTENING MECHANISM	C007	Cremone	Logica	X				10

CHIC 3D 130 ERRE ADDITIONAL FASTENING MECHANISMS AND HARDWARE

Functions

The additional fasteners make it possible to add further fastening elements that either increase the dimensions of the casement or that can be used when locking points are needed on the cross beams or hinge-side upright.

Technical Features

On the basis of the dimensions of the casement, additional fasteners (for $H > 1200$ mm and $W > 1000$ mm) and the additional arm (which is mandatory for $W > 1000$ mm) are to be used in combination with this mechanism.

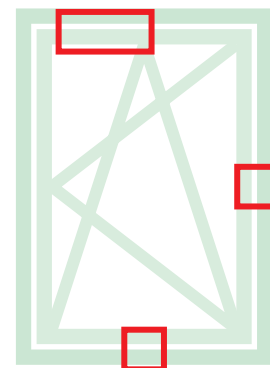

Online data sheet



02034K

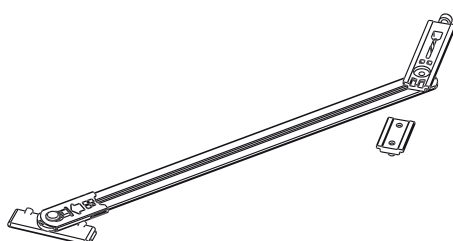

03548

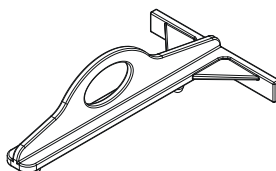

04017K

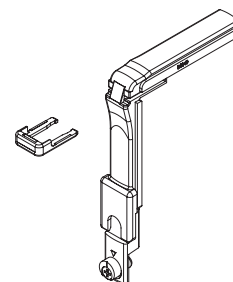

04308K

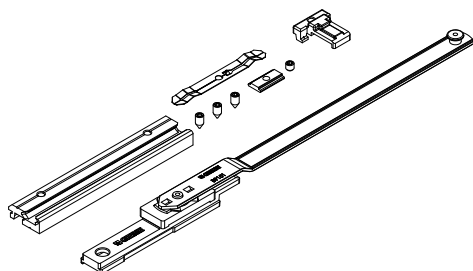

04311

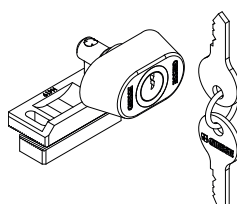

04648K

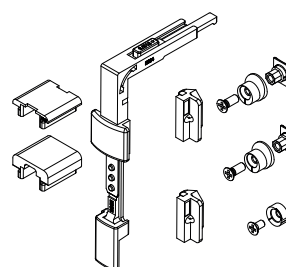

05287

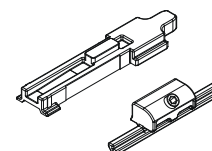

FRIZ arm positioning

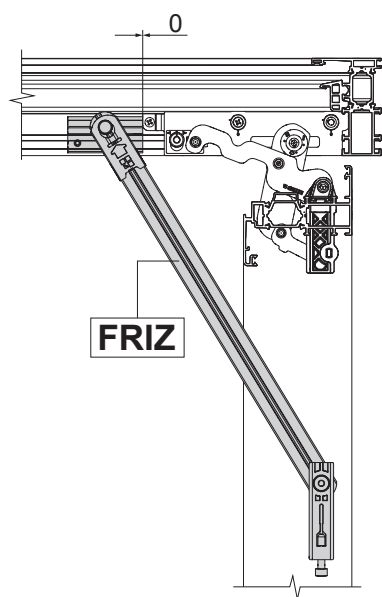

Opening angle with FRIZ arm

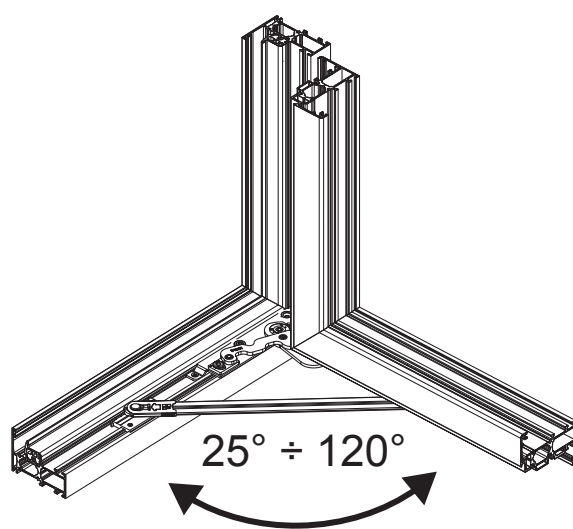

Mandatory to use the FRIZ arm

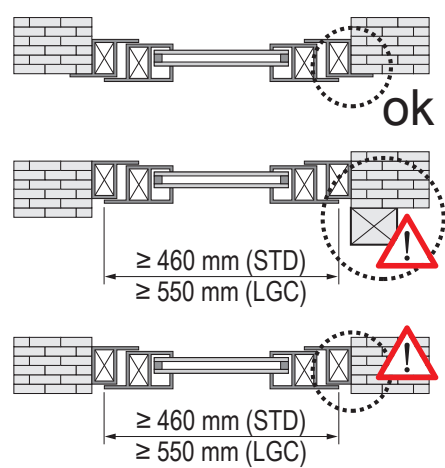

Item code	Description	PROFILE CROSS - SECTION	Range (mm)	Base Raw	Anodised Elox	Painted	Trend/Gold Brass	Pieces per pack
02034K	FRIZ STAY LIMITATION ARM	C007	See picture	X				10
03548	CHIC ERRE - TEMPLATE FOR TILT-AND-TURN	C007	-	X				10
04017K	FUTURA CORNER DRIVE	C007		X				10
04308K	ADDITIONAL ARM FOR T/T	C007	W > 1000	X				5
04311	SASH OPENING BLOCK LOCK	C001-C002-C003-C005-C006-C007-C008-C009-C010-C013-C014-C015-C017	-	X				10
04648K	VERT./HOR.ADD.FAST. GS999	C007	H > 1200 L > 1000	X				10
05287	CHIC ERRE - ARM ADDITIONAL FASTENING MECHANISM	C007	-	X				10

SECONDARY SASH HINGE SET FOR CHIC 3D 130 ERRE

Functions

Set of hinges (top and bottom) for side-hung or secondary sash with tilt-and-turn CHIC 3D 130 ERRE.

Technical Features

Sash opening to 180°.

Maximum load capacity 130 kg.

Assembly is simple, fast and easy using the special pre-assembled cams.

Both hinges are adjustable (3D).

If opening is obstructed, you need to use the FRIZ limitation arm.

Materials

Corner support made of zamak

Connecting brackets and hinge plates made of zinc plated steel

Pins made of 304 grade stainless steel and aluminium bronze

Cams made of zinc plated steel

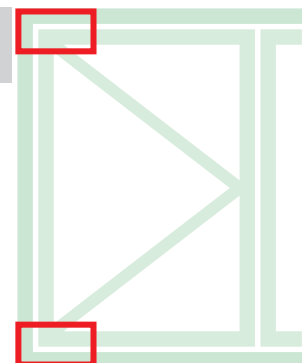

Online data sheet



052832

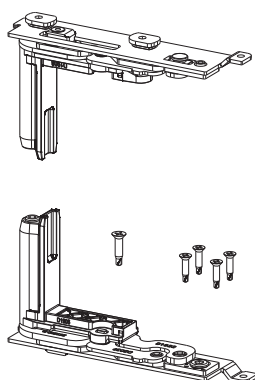

052831

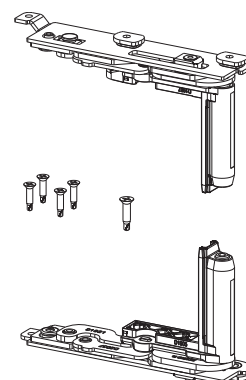

Mandatory to use the FRIZ arm

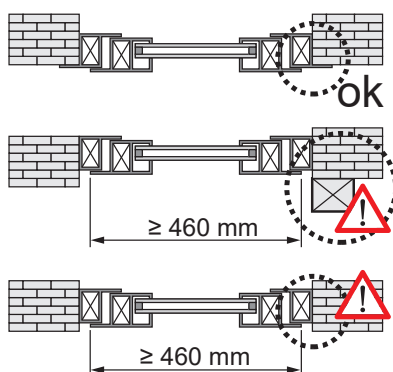

FRIZ arm positioning

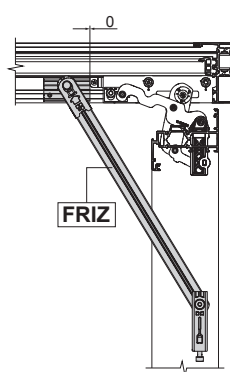

Opening angle with FRIZ arm

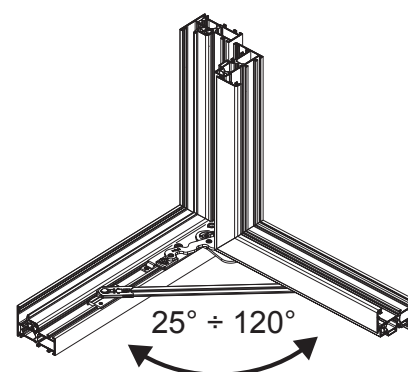

Item code	Description	PROFILE CROSS - SECTION	Hand	Base Raw	Anodised Elox	Painted	Trend/Gold Brass	Pieces per pack
052831	CHIC 130 ERRE - SASH HINGE SET	C007	RX	X				10
052832	CHIC 130 ERRE - SASH HINGE SET	C007	LX	X				10