

**REGUILLI**INOX

**NEW  
PRODUCTS**



**SCHLEGELGIESSE**

MADE FOR THE FUTURE

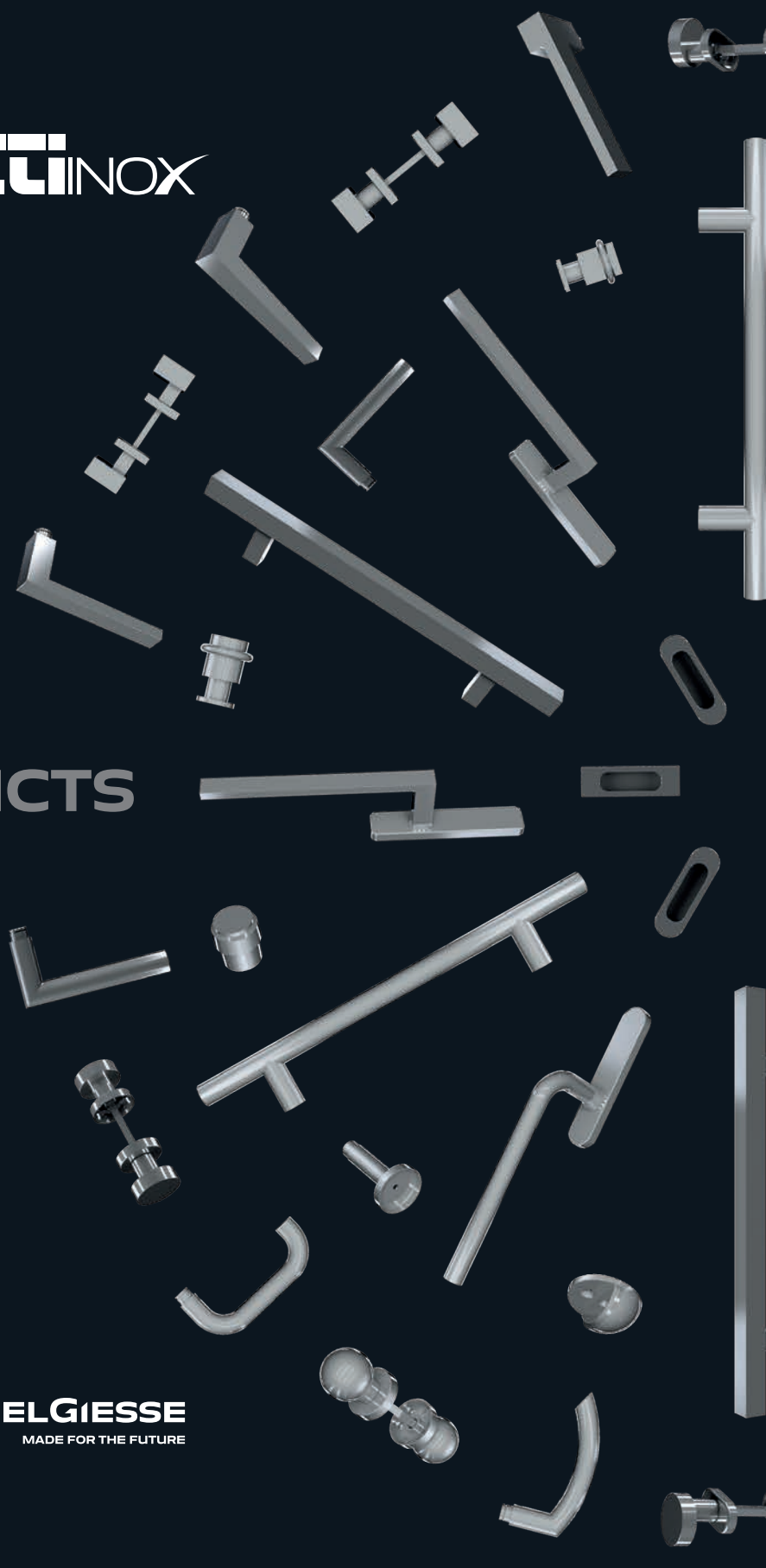

# TOLEDO SERIES WITH ANTIGERM™ TREATMENT

Antiger™ antibacterial treatment is now available on the door and window handles of the Toledo series. The new Toledo Antiger™ series extends the range of antibacterial handles available in the Reguitti Inox catalogue in addition to the Stoccolma series.



## TOLEDO Coordinated Design



# ANTIGERM™

## THE HANDLE THAT PROTECTS US

Antiger™ it is the REGUITTI exclusive antibacterial project, based on silver ions. Antiger™ antibacterial treatment for handles is certified in accordance with the requirements of the ISO 22196 (Determination of Antibacterial Activity).



CERTIFICATION  
**ISO 22196**

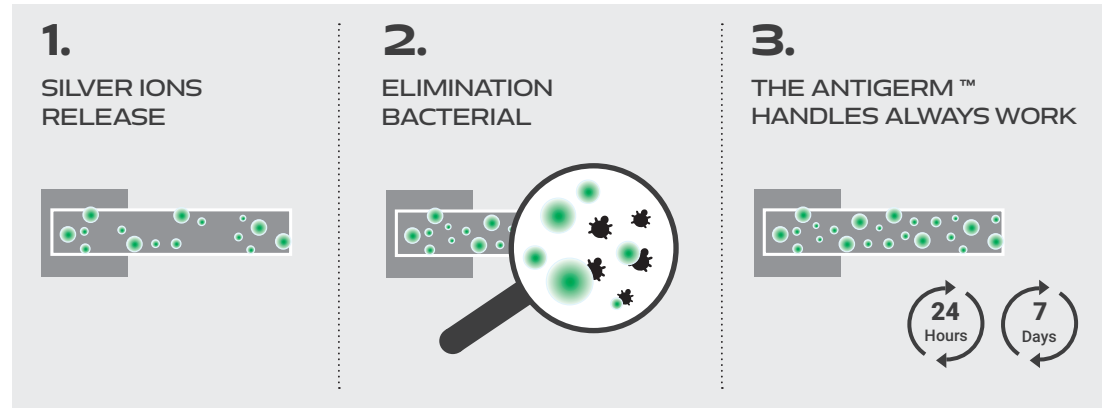

## CROSS HATCH TEST

The Cross Hatch Test allows to evaluate the coatings resistance on surfaces. According to the ISO 2409 standard, the Antiger antibacterial treatment on stainless steel material has obtained the maximum resistance grade (**Grade 0**).

CROSS HATCH TEST  
**ISO 2409**

**ISO 0 Maximum Grade**  
No coating detachment

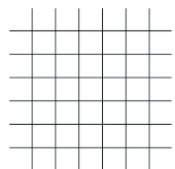

## CORROSION RESISTANCE

The Antiger antibacterial treatment on stainless steel material has obtained the **GRADE 5**, maximum degree of resistance to salt spray corrosion test according to EN 1670 standard.

CORROSION  
RESISTANCE TEST  
**EN 1670**

**> 480 h**  
Excellent resistance  
**Grade 5**



# THE NEW LOOK OF STAINLESS STEEL

## PVD SATIN GUN METAL

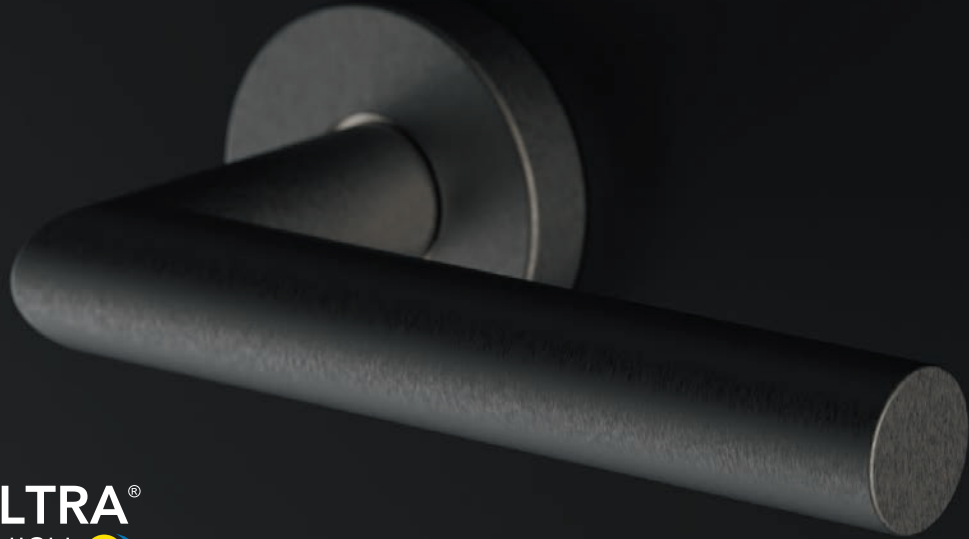

### MAXIMUM RESISTANCE IN CONTEMPORARY STYLE

A trendy "Dark tone" finish with a satin effect that reflects current trends in modern living style. The new PVD Gun Metal Satin finish is reminiscent of the anthracite that since its discover has inspired technological advances and transportation developments.

The main feature of this finish on stainless steel material is the excellent corrosion resistance. PVD Gun Metal Satin on stainless steel material has obtained the **GRADE 5**, maximum degree of resistance to salt spray corrosion test according to **UNI-EN1670** standard.

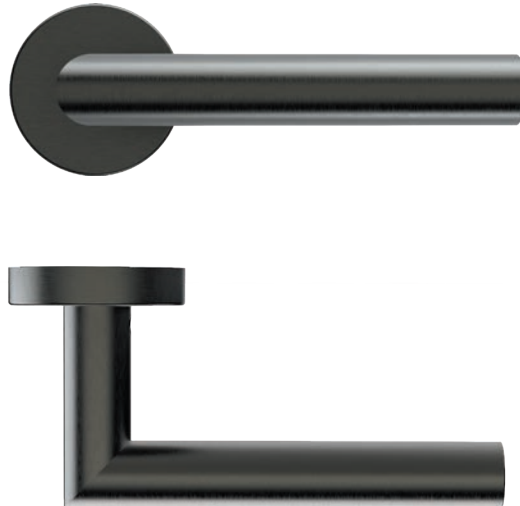

**INOX PVD GM**  
Stainless Steel PVD Satin Gun Metal



## PVD SATIN GUN METAL



Excellent resistance to corrosion



Maximum degree (5) of resistance - EN1670



10 years warranty

### THE PVD TREATMENT (PHYSICAL VAPOUR DEPOSITION)

The surface of this product has been treated with the new PVD process (Physical Vapour Deposition). This finish protects the product surfaces from atmospheric agents and normal wear. Reguitti guarantees protection from alterations and from superficial abrasion.

**The aesthetic characteristics will be maintained for at least 10 YEARS (in normal use and cleaning conditions).**



TEST	RESULT
Resistance to salt spray test	<b>Grade 5</b> - UNI EN 1670
Hardness	2000/2500 Vickers
Resistance to solvents	UNLIMITED
Resistance to muriatic acid	UNLIMITED
Resistance to specific anti-calcareous products	UNLIMITED
Colourfastness in the presence of light (without change)	UNLIMITED



# PVD SATIN GUN METAL RANGE

## TOLEDO AND COORDINATED SERIES

### Toledo L14

Door handles



L14MRL52-31  
Inox PVD GM

L14MRL09-31  
Inox PVD GM

L14MRL52-32  
Inox PVD GM

L14MRL09-32  
Inox PVD GM

Handle-Knob



L14PMM53  
Inox PVD GM

Handle for toilet



L14RWL52  
Inox PVD GM

L14RWF52  
Inox PVD GM

Window handles

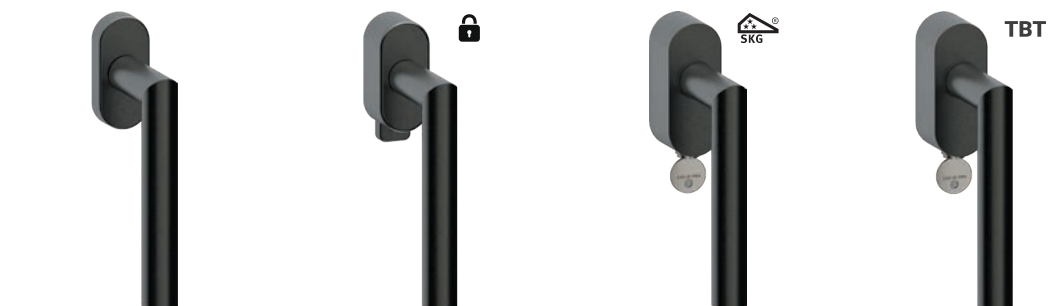

L14DK015  
Inox PVD GM

L14DK075  
Inox PVD GM

L14DKC80  
Inox PVD GM

L14DKT80  
Inox PVD GM

### Toledo L14

Pull handles for lift and slide doors

INOX PVD GM  
Stainless Steel PVD Satin Gun Metal

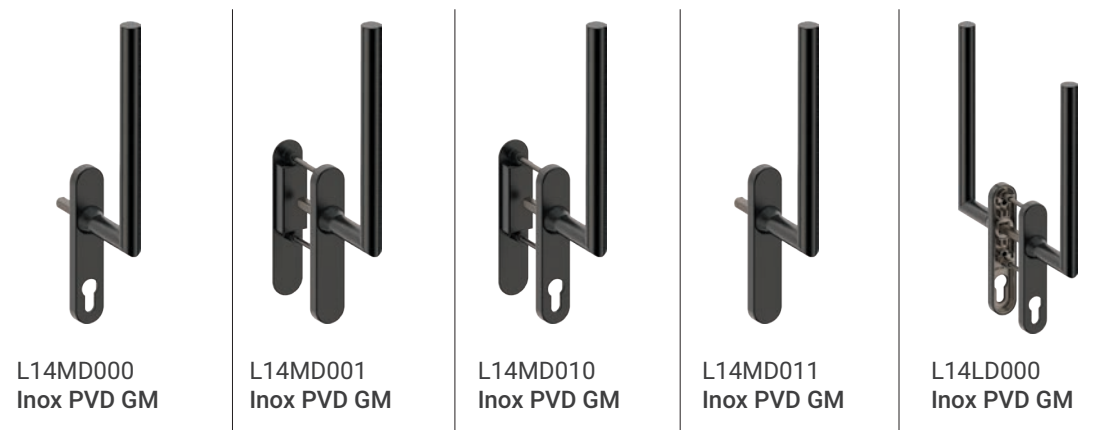

L14MD000  
Inox PVD GM

L14MD001  
Inox PVD GM

L14MD010  
Inox PVD GM

L14MD011  
Inox PVD GM

L14LD000  
Inox PVD GM

### Piano 210

Fixed knob



210PFL52  
Inox PVD GM

Door knob sets



210PRL52  
Inox PVD GM

Oval WC Sets



503NOL09  
Inox PVD GM

503NOF09  
Inox PVD GM

### Frankfurt 25 D25MD

Single pull handle straight supports



D25MD046-C0  
Inox PVD GM  
(C/C distance 300 mm)

### Frankfurt 25 S D25MS

Single pull handle offset supports



D25MS046-C0  
Inox PVD GM  
(C/C distance 300 mm)

# LIVERPOOL STANDARD PULL HANDLE WITH **BLACK** FINISH

## AN INCISIVE AND **STRONG** FINISH

A trendy and increasingly popular finish, Matt Black Ral 9005 is now available in standard lengths, 300 and 600 mm centres, for Liverpool and Liverpool S series pull handles. An "Ecofriendly" finish that respects the environment because it is made using state-of-the-art equipment with low dust emissions and a recycling process in the finishing process.



Inox NR  
Matt Black RAL 9005



Finish available for handles with standard lengths



Ecofriendly finish

# LIVERPOOL AND LIVERPOOL S WITH **BLACK** FINISH AVAILABLE IN STANDARD LENGTHS



## Liverpool

615MD050-C0 INOX NR  
(C/C distance 300 mm)

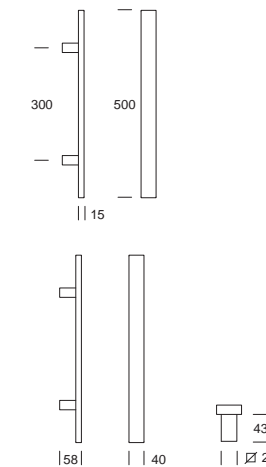

## Liverpool

615MD050-F0 INOX NR  
(C/C distance 600 mm)

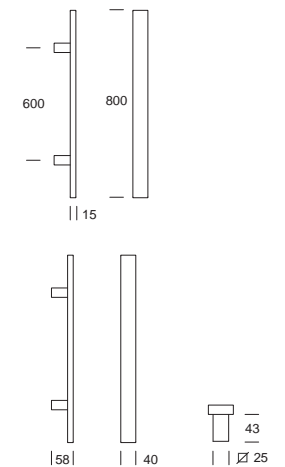

## Liverpool S

615MS050-C0 INOX NR  
(C/C distance 300 mm)

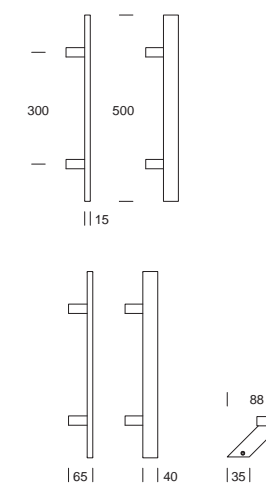

## Liverpool S

615MS050-F0 INOX NR  
(C/C distance 600 mm)

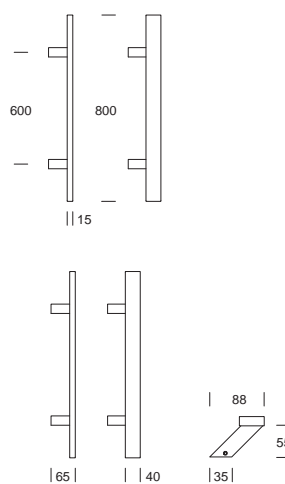

# BLACK STAINLESS STEEL AND STAINLESS STEEL 316L

## THE NEW MOSCOW PULL HANDLE FINISHES

The Moscow handle is now available in Black RAL 9005 and in Satin stainless steel 316L in the standard length with 350 mm centre distance.

### Moscow 3MOMD

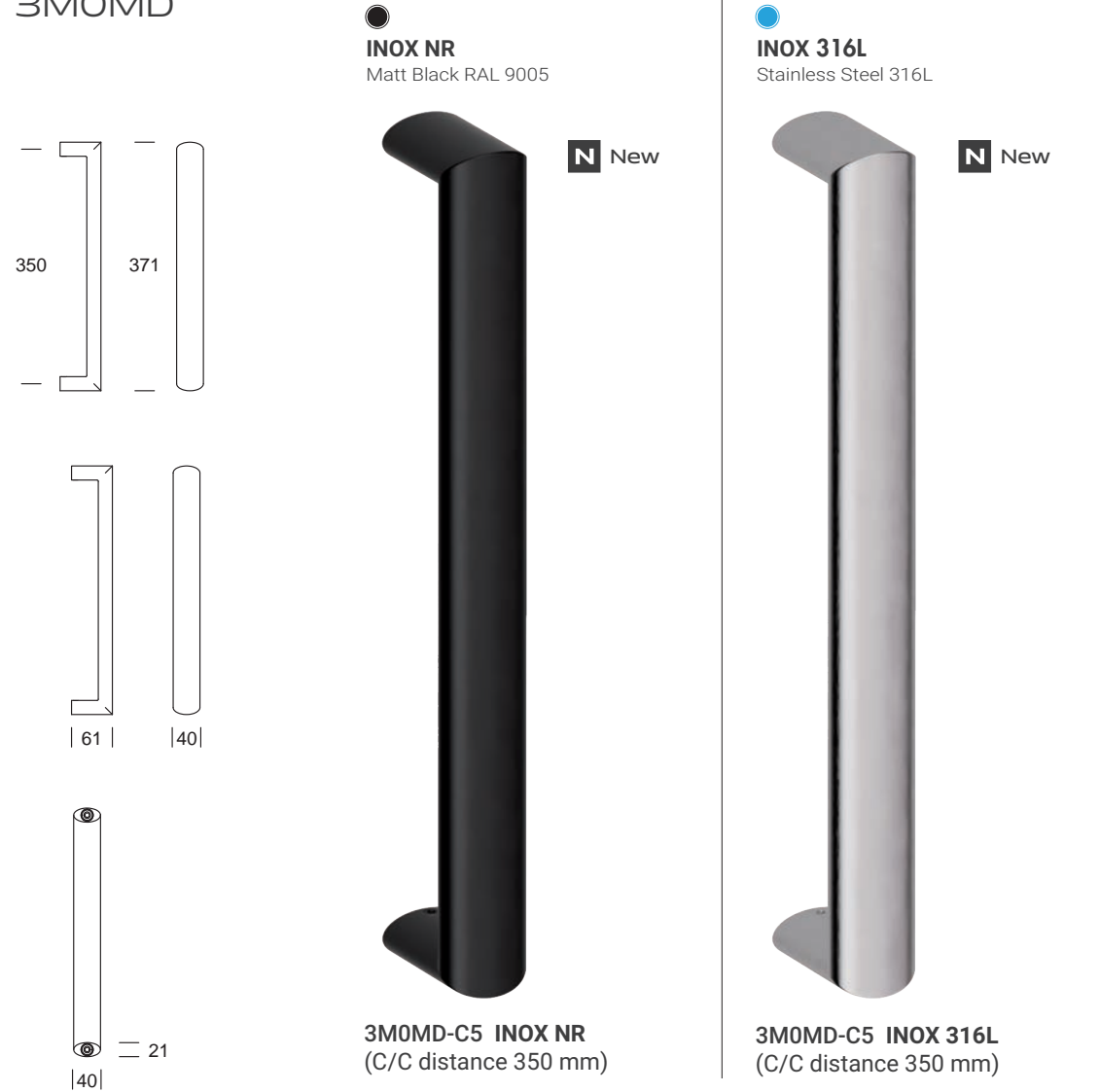

### Moscow 3MOMD

Single pull handle

**INOX 316L**  
Stainless Steel 316L

**INOX NR**  
Matt Black RAL 9005



# GENÈVE AND TOLEDO PAIR OF HANDLES WITH ROSETTE FOR WINDOW-DOORS

New handle pairs from the Genève and Toledo series with rectangular and oval rosette with 8-position movement and 43 mm bolt hole distance. These handles are suitable for window-door applications.

**Genève**  
rose Q15  
Q03MRQ15

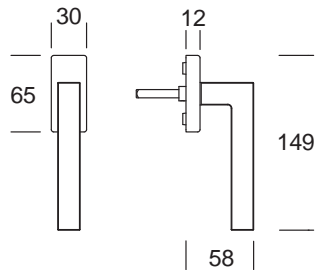

Available finishes:

 **Inox AISI 304**  
Stainless Steel 304

 **Inox NR**  
Matt Black RAL 9005

**Toledo**  
rose O15  
L14MR015

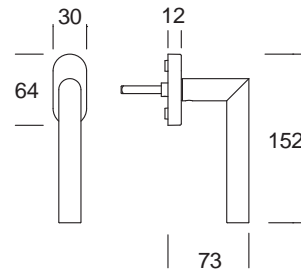

Available finishes:

 **Inox AISI 304**  
Stainless Steel 304

 **Inox NR**  
Matt Black RAL 9005

## Technical information for window door escutcheons

**Genève**  
Q03MRQ15



**8 position**  
mechanism

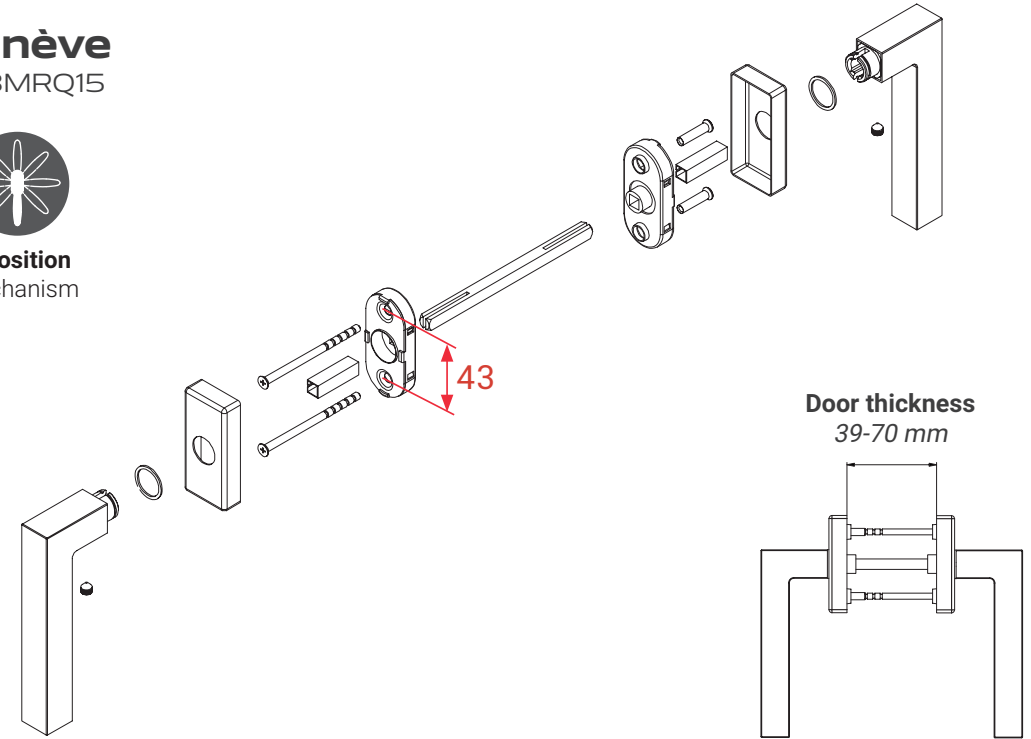

**Toledo**  
L14MR015



**8 position**  
mechanism

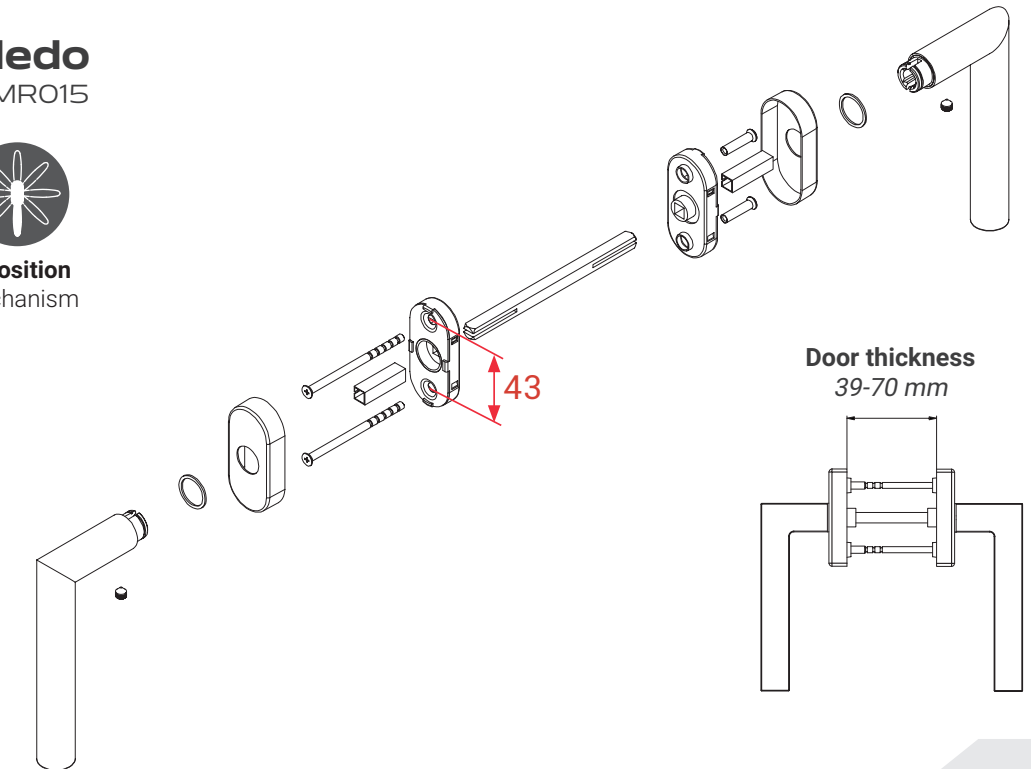

# GENÈVE AND TOLEDO PAIR OF HANDLES WITH ROSETTE FOR NARROW PROFILES

New handle pairs from the Genève and Toledo series with narrow rectangular and oval rosette with 4-position mechanism and 43 mm screw hole distance for the mechanism. These handles are suitable for use on narrow window doors.

**Genève**  
rose Q25  
Q03MRQ25

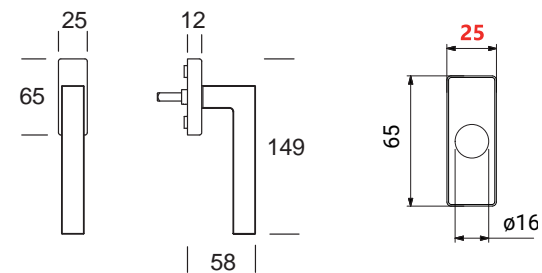

Available finishes:

 **Inox AISI 304**  
Stainless Steel 304

 **Inox NR**  
Matt Black RAL 9005

**Toledo**  
rose O25  
L14MR025

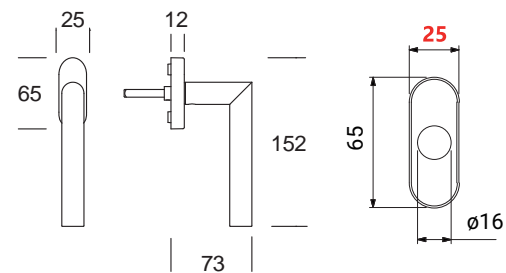

Available finishes:

 **Inox AISI 304**  
Stainless Steel 304

 **Inox NR**  
Matt Black RAL 9005

## Technical information for window door escutcheons

**Genève**  
Q03MRQ25



**4 position**  
mechanism

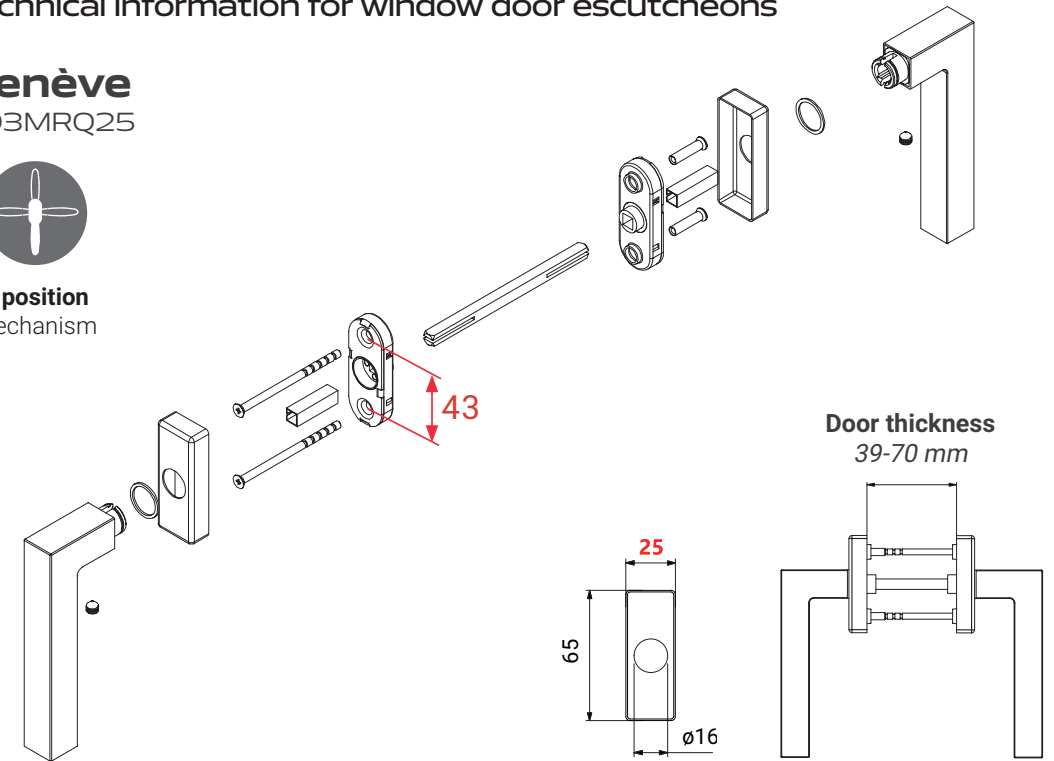

**Door thickness**  
39-70 mm

**Toledo**  
L14MR025



**4 position**  
mechanism

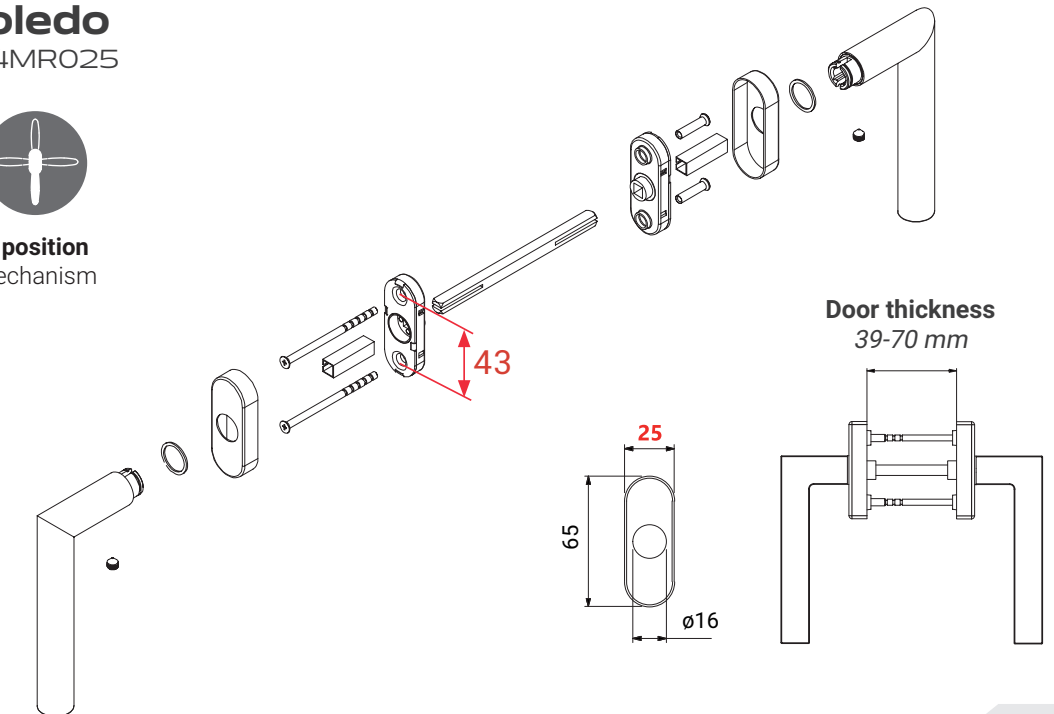

**Door thickness**  
39-70 mm





# GRADE 5

## EXCELLENT CORROSION RESISTANCE

Tests on stainless steel material **AISI 304**, **AISI 316L** and **Matt Black RAL 9005** finish have obtained the **GRADE 5**, maximum degree of resistance to salt spray corrosion test according to **EN 1670** standard.

CORROSION RESISTANCE TEST  
**EN 1670**

**Grade 5**  
Excellent resistance

**> 480 h**

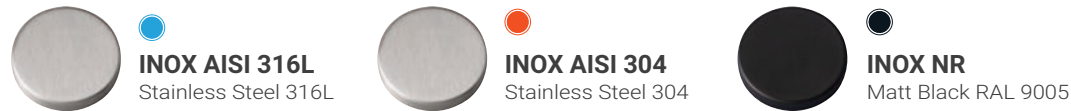

# GRADE 0

## MAXIMUM RESISTANCE OF COATING TO SURFACE

The Cross Hatch Test allows to evaluate the coatings resistance on surfaces. According to the **ISO 2409** standard, the **Matt Black RAL 9005** on stainless steel material has obtained the **maximum resistance grade (Grade 0)**.

CROSS HATCH TEST  
**ISO 2409**

**Grade 0**

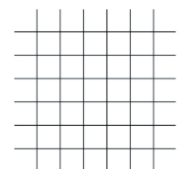

ISO 0  
**Maximum Grade**  
No coating detachment



# REGUITTI INOX FINISHES

Available Standard finishes

Image	Signs	Code	Description	Material
	INOX AISI 304	5S	Stainless Steel 304	
	INOX AISI 316L	S5	Stainless Steel 316L	
	INOX AISI 304 SAT. / LUC.	Q1	Satin Stainless Steel / Polished Stainless Steel	
	INOX ANTIGERM™	GX	Stainless Steel Antigerm™ AG+	
	INOX BN	KG	Glossy White Ral 9010	
	INOX NR	KK	Matt Black Ral 9005	
	INOX PVD ORO	5X	Stainless Steel PVD Gold	
	INOX PVD GM	3X	Stainless Steel PVD Satin Gun Metal	

Available finishes on request

Image	Signs	Code	Description	Material
	INOX LUCIDO	50	Polished Stainless Steel	
	INOX 316L PVD	WP	Stainless Steel 316L PVD Satin	
	INOX 304 PVD	WQ	Stainless Steel 304 PVD Satin	

Stainless Steel



# A GLOBAL PARTNER

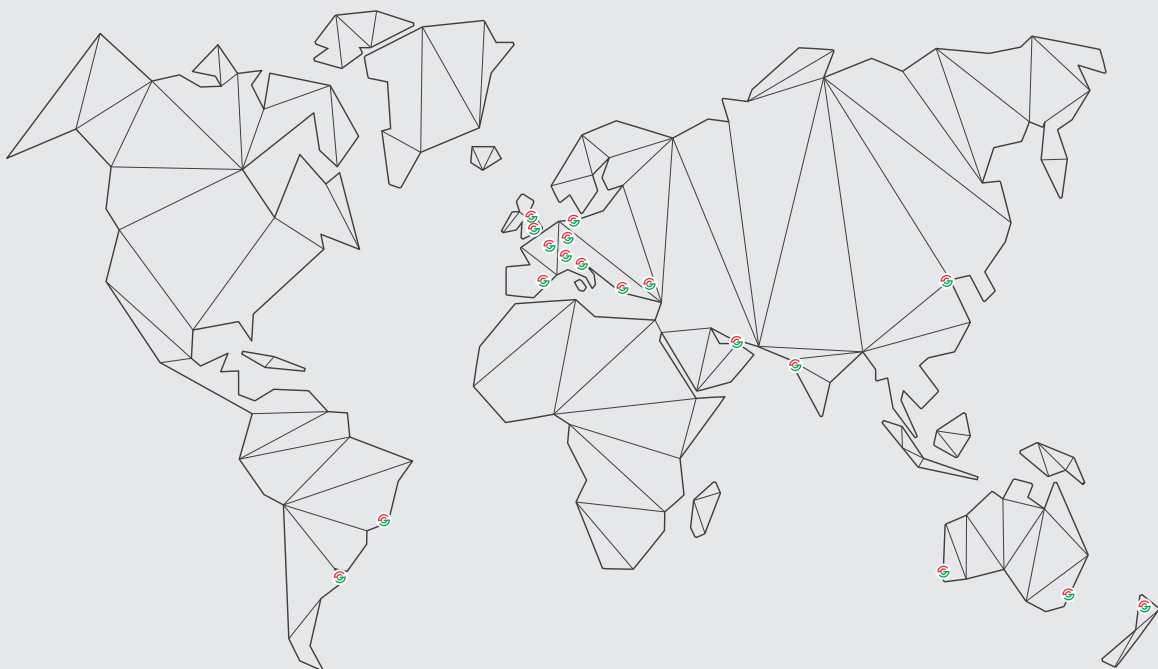

**REGUITTI S.p.A.**

Zona industriale località Fondi 33, 25071 Agnosine (BS), Italy

Tel: +39 0365 896186 | Fax: +39 0365 896137 | email: [salesreguitti@schlegelgiesse.com](mailto:salesreguitti@schlegelgiesse.com)

[www.schlegelgiesse.com](http://www.schlegelgiesse.com)

M.DEPAVB64-20-EN