

CHIC HINGES FOR BOTTOM-HUNG WINDOWS



Functions

Hinge set for concealed Bottom-hung window.

Technical Features

Total opening of the 180° hinge to facilitate its assembly.
 Fixing on the frame without machining, by means of pre-assembled cams.
 Sash height (+2.5 ÷ -0.5 mm) and compression (+1.4 ÷ -0.6 mm) adjustment, micrometric and independent of each other.
 The hinge is completed by 2 raising components that improve its stability.
 Maximum load capacity (*) 250 kg
 Minimum height (*) 3,000 mm
 (*) these are a consequence of the opening limiter used (see the opening limiters table).
 Maximum width 2,500 mm. Over 1,500 and 2,000 mm it is necessary to use no. 1 or no. 2 Raising components 04363 (see Raising component use scheme).

Materials

GS Silver PLUS zamak sash support
 Connecting brackets, hinge plates and cams in zinc plated steel
 AISI 304 stainless steel pins and screws
 Grey polyamide raising component

CHIC BOTTOM HUNG

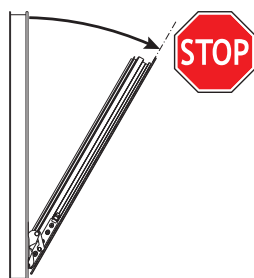
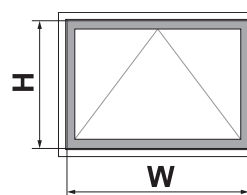

Compulsory: opening limiter.

Description	Item code	Capacities	W (mm)	H (mm)
RALLENTY (150mm)	02041K	50 kg	200÷2500	400÷1500
RALLENTY (250mm)	02040K	80 kg	200÷2500	570÷1500
FRIZ (140mm)	02800K	70 kg	200÷2500	420÷2500
FRIZ (300mm)	02030K	130 kg	200÷2500	580÷2500
FUTURA HP	01175K	250 kg	780÷2500	600÷3000

Raising component use

04363

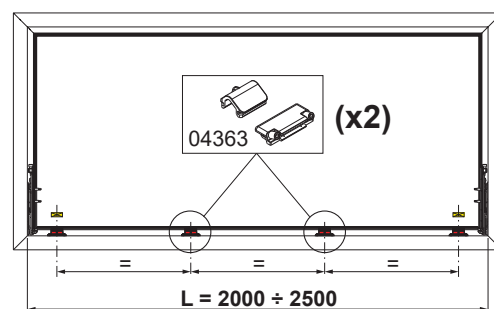
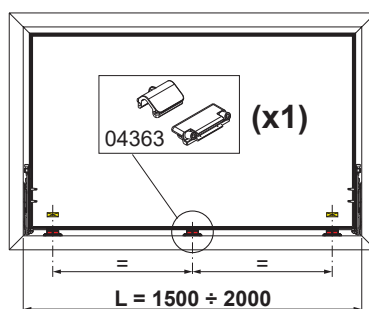
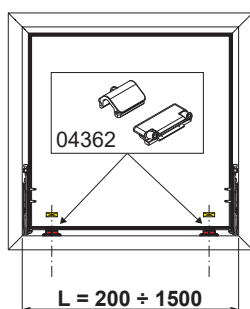
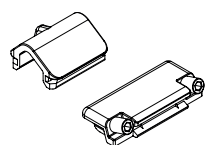

Height adjustment

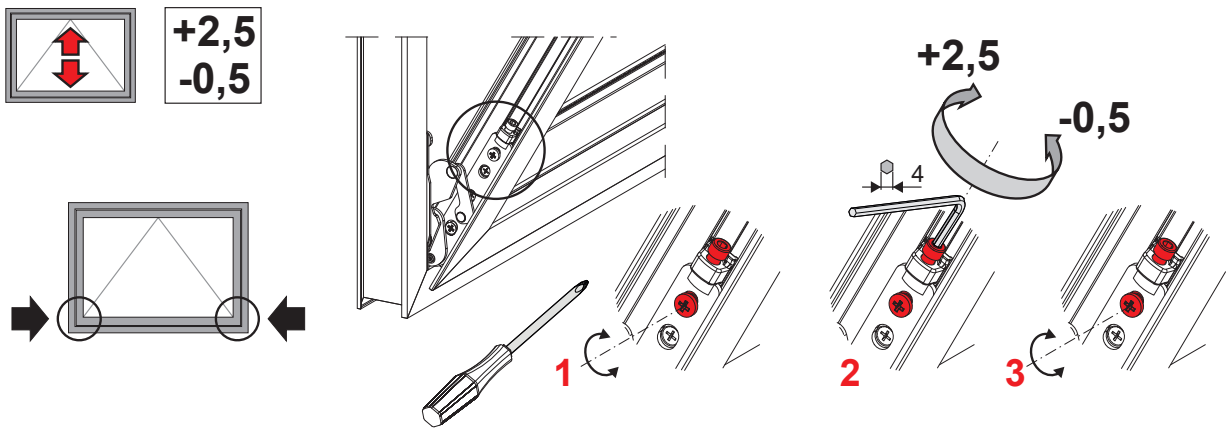

Compression adjustment

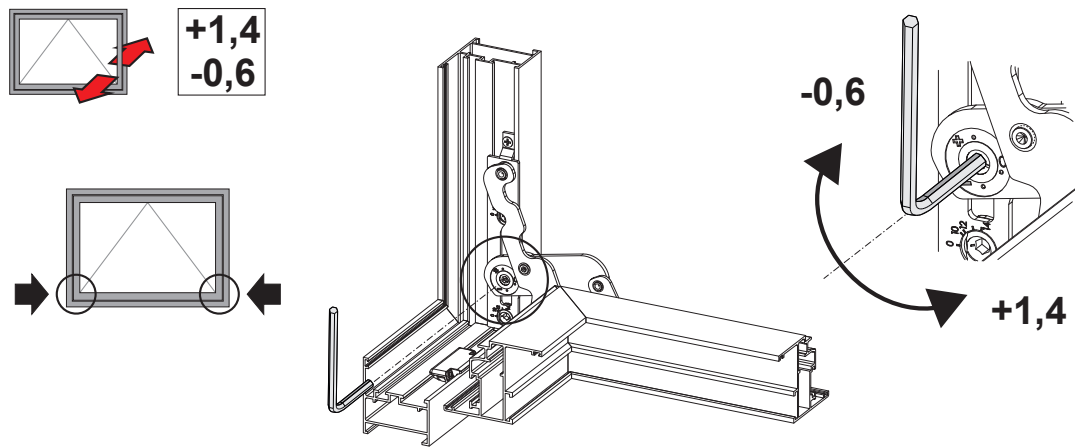

Item code	Description	Note	PROFILE CROSS - SECTION	Base Raw	Anodised Elox	Painted	Trend/Gold Brass	Pieces per pack
04362	CHIC - BOTTOM-HUNG WINDOW HINGE KIT	pair	C001-C002	X				10
04363	CHIC - BOTTOM-HUNG WINDOW RAISING COMPONENT		C001-C002	X				10