

FUTURA 3D 130

Functions

Complete system for the construction of tilt-and-turn windows with load capacities of up to 140 kg.

Available in the standard, logic and microventilation versions.

FUTURA 3D

130

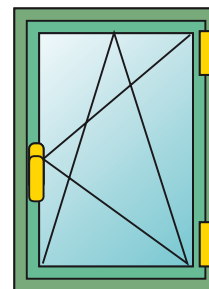

FUTURA 3D

130

FUTURA 3D

130 micro

FUTURA 3D

130 lgc

FUTURA 3D

130 micro lgc

Technical Features

Making a FUTURA 3D 130 tilt-and-turn window mechanism requires:

- Hinge kit
- Set of fastening mechanisms for Cremones and window handles
- Arms, available in three versions (standard, micro-ventilation and logic)
- Cremona or window handle (available in different models to choose from in the specific catalogue section)

Adjustments

The FUTURA 3D tilt-and-turn window enables micrometric adjustment in every direction, ideal after installing the casement.

Micro-ventilation

Microventilation enables having simultaneously both the tilt-and-turn position and micro-ventilation (precision opening of the sash) on the casement. Available both as standard and with an additional device.

Logica

The logical operation consists in first tilt-and-turn opening (with the cremona at 90°) and secondly side-hung opening (with the cremona at 180°). Its use is particularly recommended in public buildings (schools, hospitals, etc.) in combination with a cremona with a key in order to have only tilt-and-turn window opening for safety reasons and to allow full opening only for staff with the key.

Logica mechanism operation

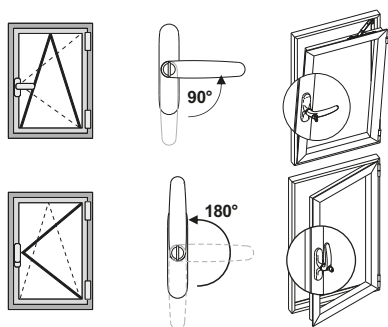

Standard microventilation

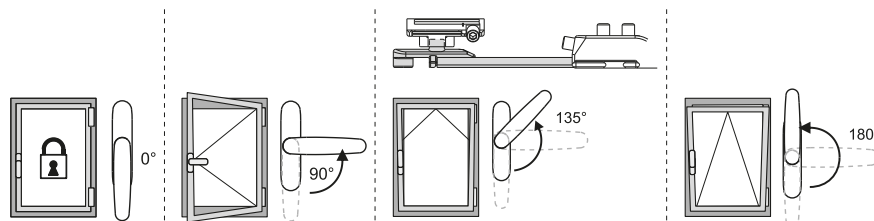

ADJUSTMENTS [mm]

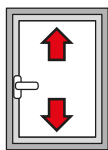

Height:
+1.5 / -0.5

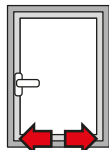

Side:
±1

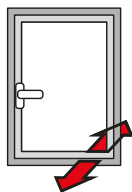

Bottom hinge compression:
±0.3

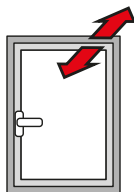

Top hinge compression:
±1.5

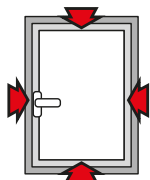

Striker compression:
±1.8

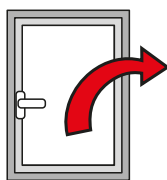

Sash fall:
+3.5 / -1.5

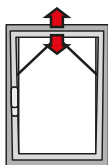

Micro-ventilation:
+3.6 / -1.8

Table of maximum glass thickness [mm]

3000	35	28	24	21	19	17	15	14	13	12	11	11	10		
2900	35	29	25	22	20	18	16	15	14	13	12	11	10	10	
2800	36	30	26	23	20	18	17	15	14	13	12	11	11	10	
2700	38	31	27	24	21	19	17	16	15	13	13	12	11	10	
2600	39	33	28	25	22	20	18	16	15	14	13	12	12	11	
2500	44	37	31	27	24	22	20	18	17	16	15	14	13	11	
2400	46	38	33	29	25	23	21	19	18	16	15	14	13	12	
2300	48	40	34	30	27	24	22	20	18	17	16	15	14	12	
2200	50	42	36	31	28	25	23	21	19	18	17	16	15	13	
2100	50	44	37	33	29	26	24	22	20	19	17	16	15	13	
2000	50	46	39	34	31	27	25	23	21	20	18	17	16	14	
1900	50	48	41	36	32	29	26	24	22	21	19	18	16	14	
1800	50	50	44	38	34	31	28	25	23	22	20	18	16	14	
1700	50	50	46	40	36	32	29	27	25	23	21	18	16	14	
1600	50	50	49	43	38	34	31	29	26	24	21	18	16	14	
1500	50	50	50	46	41	37	33	31	27	24	21	18	16	14	
1400	50	50	50	49	44	39	36	32	27	24	21	18	16		
1300	50	50	50	50	47	42	38	32	27	24	21	18			
1200	50	50	50	50	50	46	38	32	27	24	21				
1100	50	50	50	50	50	46	38	32	27	24					
1000	50	50	50	50	50	46	38	32							
900	50	50	50	50	50	46	38	32							
800	50	50	50	50	50	46	38								
700	50	50	50	50	50	46									
600	50	50	50	50	50	46									
	350	500	600	700	800	900	1000	1100	1200	1300	1400	1500	1600	1700	1800

Table of maximum load capacity [kg]

3000	130	130	130	130	130	130	130	130	130	130	130	130	130	130	
2900	130	130	130	130	130	130	130	130	130	130	130	130	130	130	130
2800	130	130	130	130	130	130	130	130	130	130	130	130	130	130	130
2700	130	130	130	130	130	130	130	130	130	130	130	130	130	130	130
2600	130	130	130	130	130	130	130	130	130	130	130	130	130	130	130
2500	140	140	140	140	140	140	140	140	140	140	140	140	140	140	130
2400	140	140	140	140	140	140	140	140	140	140	140	140	140	140	130
2300	140	140	140	140	140	140	140	140	140	140	140	140	140	140	130
2200	140	140	140	140	140	140	140	140	140	140	140	140	140	140	130
2100	140	140	140	140	140	140	140	140	140	140	140	140	140	140	130
2000	140	140	140	140	140	140	140	140	140	140	140	140	140	140	130
1900	140	140	140	140	140	140	140	140	140	140	140	140	140	140	125
1800	140	140	140	140	140	140	140	140	140	140	140	140	140	133	118
1700	140	140	140	140	140	140	140	140	140	140	134	126	118	111	105
1600	140	140	140	140	140	140	140	140	140	137	127	118	111	104	99
1500	140	140	140	140	140	140	140	138	127	118	110	104	97		
1400	140	140	140	140	140	140	140	128	118	110	103	96			
1300	140	140	140	140	140	140	129	118	109	101	95				
1200	140	140	140	140	140	130	118	108	100	93					
1100	140	140	140	140	140	131	118	108	99	91					
1000	140	140	140	133	118	106	97	89							
900	140	140	135	118	105	95	86								
800	140	138	118	104	92	83									
700															
600															
	350	500	600	700	800	900	1000	1100	1200	1300	1400	1500	1600	1700	1800



Futura 3D 130 traditional

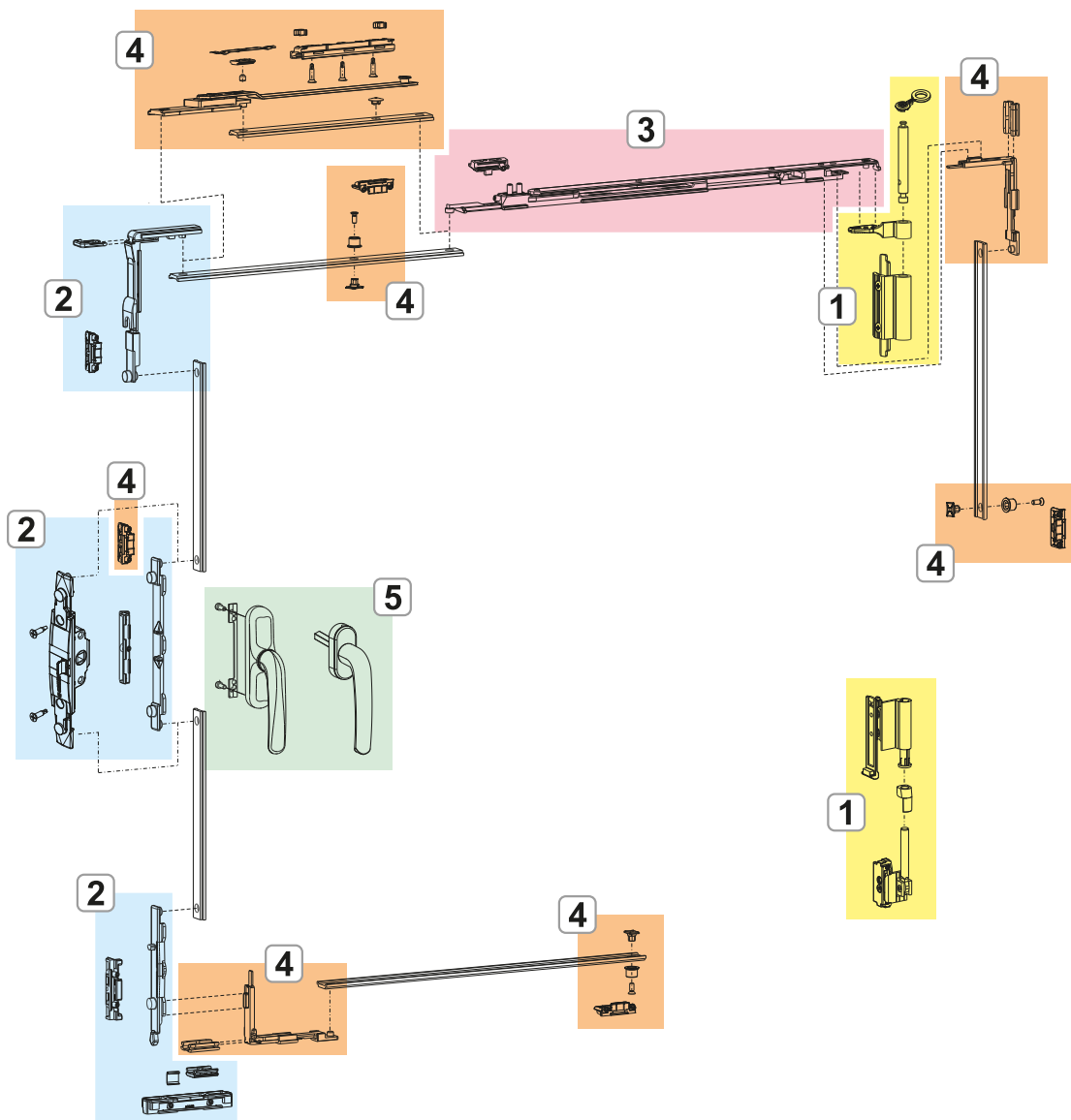

1. FUTURA 3D 130 HINGES
2. FUTURA 3D 130 FASTENING MECHANISMS
3. FUTURA 3D 130 ARMS
4. FUTURA 3D 130 ADDITIONAL FASTENING MECHANISMS AND ACCESSORIES
5. CREMONES AND WINDOW HANDLES

FUTURA 3D
130 lgc

FUTURA 3D
130 micro lgc

Futura 3D 130 logica

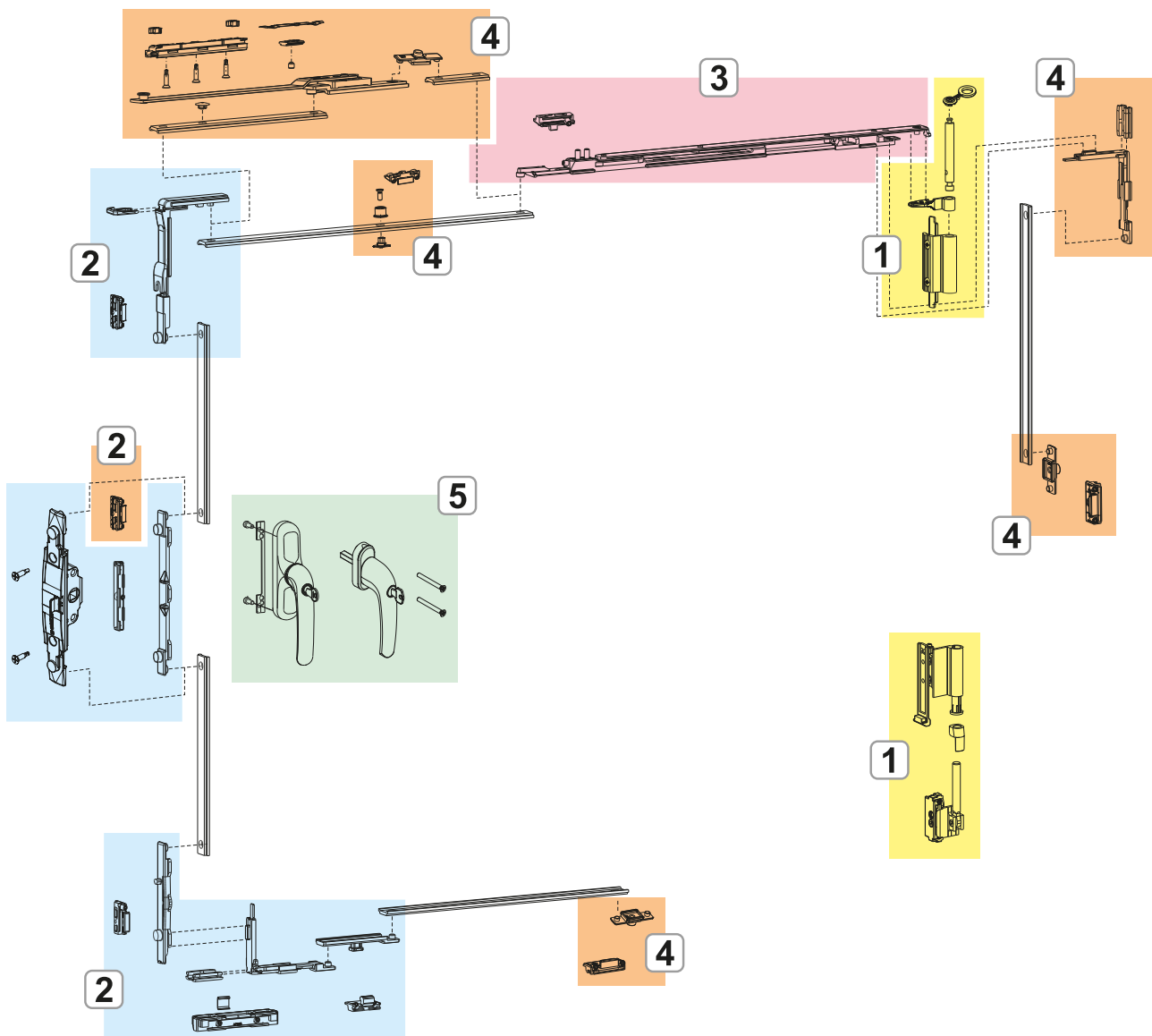

- 1. FUTURA 3D 130 HINGES
- 2. FUTURA 3D 130 FASTENING MECHANISMS
- 3. FUTURA 3D 130 ARMS
- 4. FUTURA 3D 130 ADDITIONAL FASTENING MECHANISMS AND ACCESSORIES
- 5. CREMONES AND WINDOW HANDLES

FUTURA 3D 130 HINGES

Functions

Hinge set (upper and lower), completely pre-assembled and ready to be installed on the profile.

Materials

Body of hinges in extruded aluminium and brass.

Supports in zamak with GS Silver Plus finish (up to 500 hr corrosion resistance).

Pins, screws and grub screws in stainless steel.

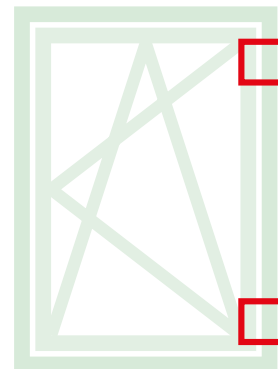

04711

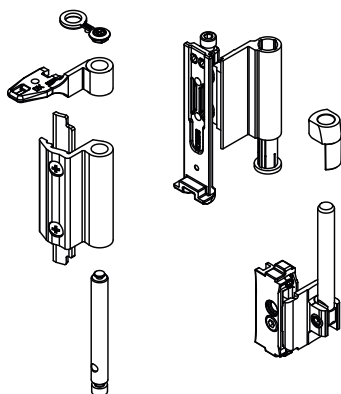

04711010

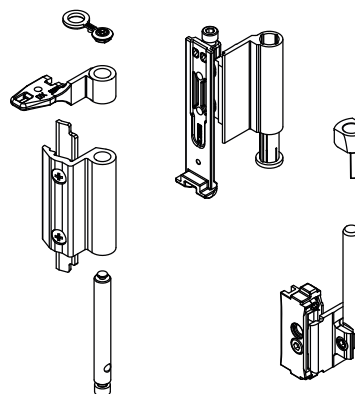

04756N

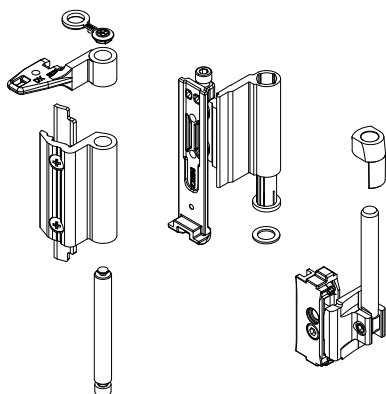

Item code	Description	PROFILE CROSS - SECTION	Base Raw	Anodised Elox	Painted	Trend/Gold Brass	Pieces per pack
04711	HINGE T/T FUTURA 130	C001-C002-C005-C006	X		X	X	10
04711010	HINGE T/T FUTURA 130	C003	X		X		10
04756N	HINGE T/T FUTURA 130	C004	X		X	X	10

FUTURA 3D 130 FASTENING MECHANISMS

Functions

Tilt-and-turn window fastening mechanisms for cremone or window handle, available in Base and Logica versions

Materials

Drive, drive rod, mechanism bolt tip and strikers in zamak with GS Silver Plus finish (up to 500 h of corrosion resistance).

Screws and grub screws in stainless steel.

Polyamide raiser.

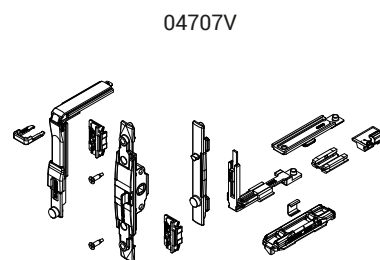
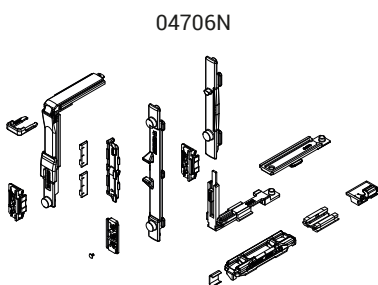
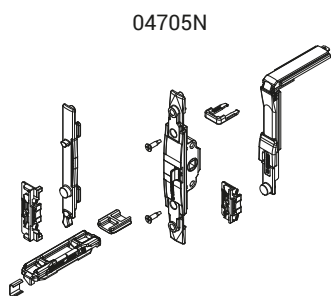
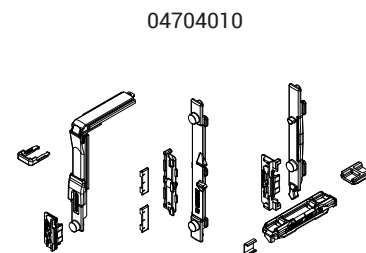
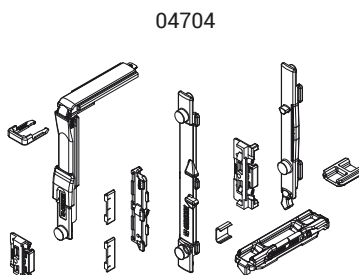
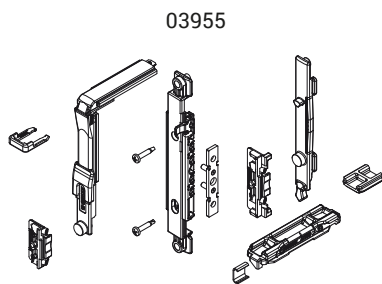
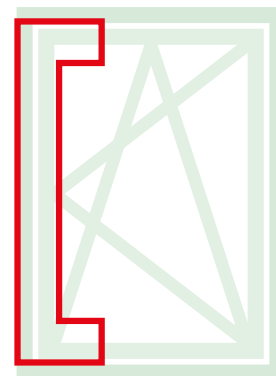

Item code	Description	PROFILE CROSS - SECTION	Window handle	Version	Base Raw	Anodised Elox	Painted	Trend/Gold Brass	Pieces per pack
0395501	T/T FASTENING MECHANISM	C001-C002-C004-C005-C006-C013-C014-C015-C016-C017	NP SUPRA	-	X				10
04704	T/T FASTENING MECHANISM	C001-C002-C004-C005-C006-C013-C014-C015-C016-C017	Cremone	-	X				10
04704010	T/T FASTENING MECHANISM	C003	Cremone	-	X				10
04705N	T/T M 180 FASTENING MECHANISM	C001-C002-C004-C005-C006-C013-C014-C015-C016-C017	Window handle	-	X				10
04706N	T/T LOGICA FASTENING MECHANISM	C001-C002-C004-C005-C006-C013-C014-C015-C016-C017	Cremone	Logica	X				10
04707V	T/T M 180 LOGICA FASTENING MECHANISM	C001-C002-C004-C005-C006-C013-C014-C015-C016-C017	Window handle	Logica	X				10

FUTURA 3D 130 ARMS

Functions

They enable tilt-and-turn opening in conjunction with the mechanisms and are available in three versions (standard, microventilation and logic).

Materials

Body, fixing block and slider in zamak with GS Silver Plus finish (up to 500 h of corrosion resistance).
Rod, connecting bracket, grub screws and screws in stainless steel.
Stop disk in polyamide.

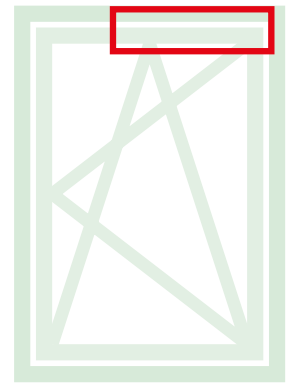

04202

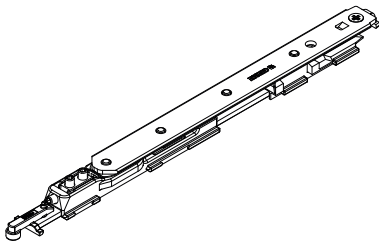

04203

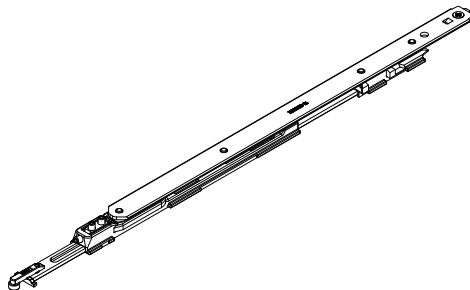

04222

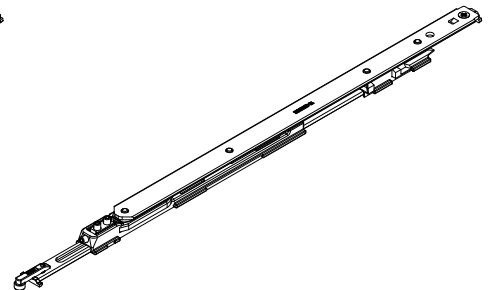

04284

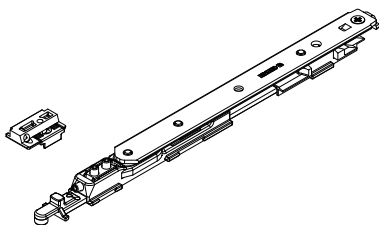

04285

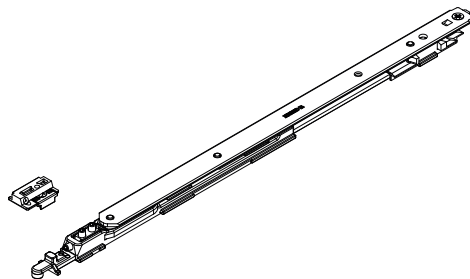

04344

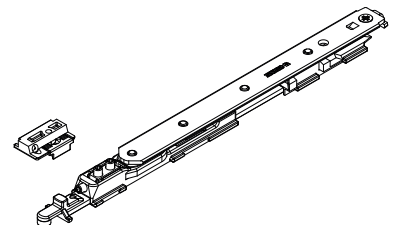

04345

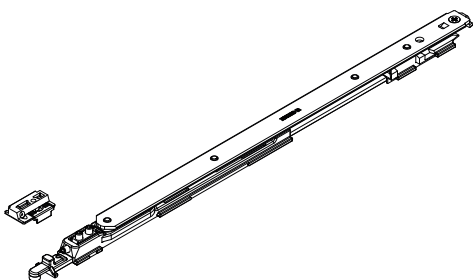

04353

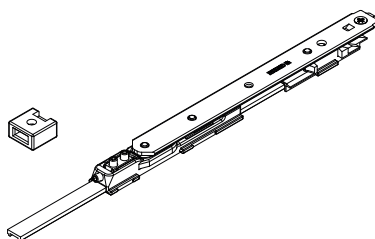

Sash opening

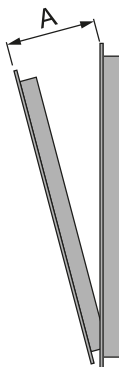

Item code	Description	PROFILE CROSS - SECTION	Range (mm)	Version	A (mm)	Base Raw	Anodised Elox	Painted	Trend/Gold Brass	Pieces per pack
04202	ARM TYPE 1 T/T FUTURA LOGICA 130	C001-C002-C003-C004-C005-C006-C013-C014-C015-C016-C017	W 390 ÷ 700	Logica	120					10
04203	ARM TYPE 2 T/T FUTURA LOGICA 130	C001-C002-C003-C004-C005-C006-C013-C014-C015-C016-C017	W 701 ÷ 1800	Logica	175					10
04222	ARM TYPE 2 T/T FUTURA LOGICA 130	C001-C002-C003-C004-C005-C006-C013-C014-C015-C016-C017	W 701 ÷ 1800	Logica	160					10
04284	ARM T1 130 WITH MICROVENTILATION	C001-C002-C003-C004-C005-C006-C013-C014-C015-C016-C017	W 410 ÷ 700	Micro	120					10
04285	ARM T2 130 WITH MICROVENTILATION	C001-C002-C003-C004-C005-C006-C013-C014-C015-C016-C017	W 701 ÷ 1800	Micro	175					10
04344	ARM T1 130 MICROVENTILATION LOGIC	C001-C002-C003-C004-C005-C006-C013-C014-C015-C016-C017	W 410 ÷ 700	Logica Micro	120					10
04345	ARM T2 130 MICROVENTILATION LOGIC	C001-C002-C003-C004-C005-C006-C013-C014-C015-C016-C017	W 701 ÷ 1800	Logica Micro	175					10
04353	ARM TYPE 0 T/T FUTURA 130	C001-C002-C003-C004-C005-C006-C013-C014-C015-C016-C017	W 350 ÷ 410	-	120					10

FUTURA 3D 130 ADDITIONAL FASTENING MECHANISMS AND ACCESSORIES

Functions

The additional fasteners make it possible to add further fastening elements that either increase the dimensions of the casement or that can be used when locking points are needed on the cross beams or hinge-side upright.

On the basis of the dimensions of the casement, additional fasteners (for H>1200 mm and W>1000 mm) and the additional arm (which is mandatory for W>1000 mm) are to be used in combination with this mechanism.

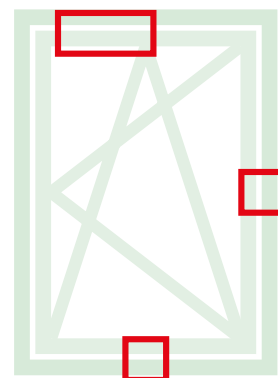

01299

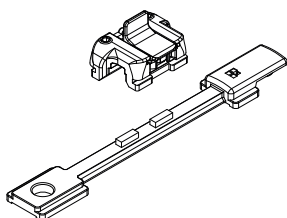

04014K

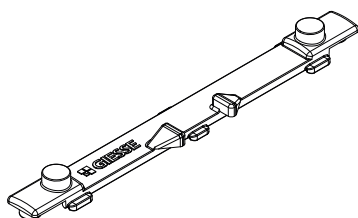

04019K

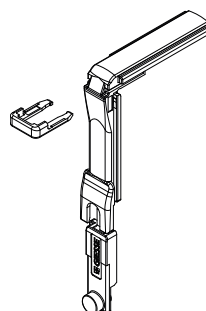

04020K

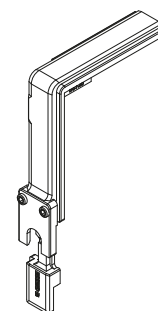

04024K

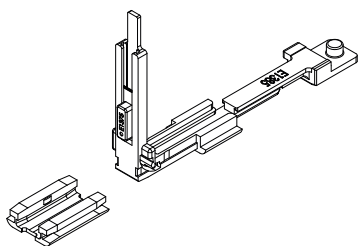

04026K

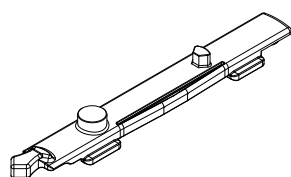

04301K

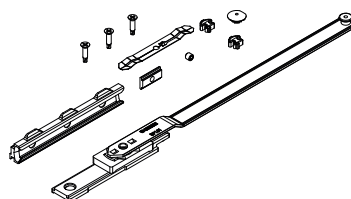

04311

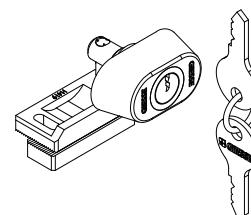

04770K

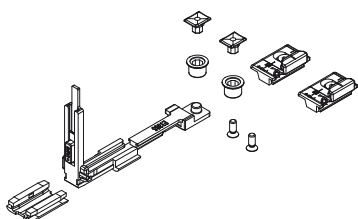

04777K

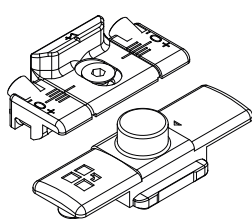

Item code	Description	Interface type	Range (mm)	Version	Base Raw	Anodised Elox	Painted	Trend/Gold Brass	Pieces per pack
01299	INCORRECT MOVEMENT SAFETY DEVICE	C001-C002-C003-C004-C005-C006-C013-C014-C015-C016-C017	H > 620 HC > 250	-	X				10
04014K	FUTURA T/T DRIVE ROD	C001-C002-C003-C004-C005-C006-C013-C014-C015-C016-C017	-	-	X				10
04019K	CORNER DRIVE GROOVE 15/20 FUTURA	C001-C002-C003-C004-C005-C006-C009-C010-C011-C012-C013-C014-C015-C016-C017	-	-	X				10
04020K	FUTURA CORNER DRIVE	C001-C002-C003-C004-C005-C006-C009-C010-C011-C012-C013-C014-C015-C016-C017-P001-P002-P003-P004-P005-P006-P007-P008-P009-P010	-	-	X				50
04024K	CORNER DRIVE FOR FUTURA BURGLAR-PROOF FUNCTION	C001-C002-C003-C004-C005-C006-C013-C014-C015-C016-C017	-	-	X				10
04026K	FUTURA T/T BOLT TIP	C001-C002-C003-C004-C005-C006-C013-C014-C015-C016-C017	-	-	X				10
04301K	T/T FUTURA ADDITIONAL ARM	C001-C002-C003-C004-C005-C006	W > 1000	-	X				5
04311	SASH OPENING BLOCK LOCK	C001-C002-C003-C004-C005-C006-C007-C013-C014-C015-C016-C017	-	-	X				10
04770K	FUTURA ADDITIONAL FASTENING MECHANISM	C001-C002-C003-C004-C005-C006-C013-C014-C015-C016-C017	H > 1200 L > 1000	-	X				10
04777K	FUTURA ADDITIONAL FASTENING MECHANISM	C001-C002-C003-C004-C005-C006-C013-C014-C015-C016-C017	H > 1200 L > 1000	Logica	X				50

FUTURA 3D 130 SECONDARY SASH

Functions

FUTURA 3D 130 features specific hinges for the secondary sash, with the same styling line and the same adjustments.

Materials

Body of hinges in extruded aluminium and brass.

Supports in zamak with GS Silver Plus finish (up to 500 hr corrosion resistance).

Pins, screws and grub screws in stainless steel.

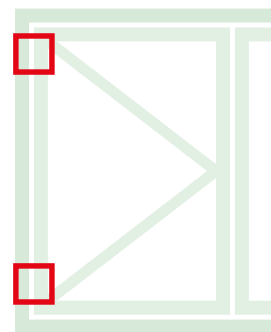

04728

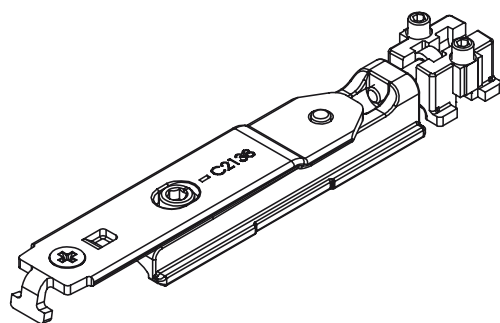

Item code	Description	PROFILE CROSS - SECTION	Base Raw	Anodised Elox	Painted	Trend/Gold Brass	Pieces per pack
04728	FUTURA 3D 130 SECONDARY SASH ADAPTER	C001-C002-C003-C004-C005-C006	X				10