

**CLASSIC 3D 80**

**Functions**

Complete system for the construction of tilt-and-turn windows with load capacities of up to 80 kg.  
Available in the standard, logic and microventilation versions.

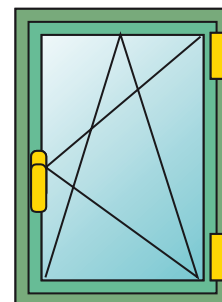

**Technical Features**

Making a CLASSIC 3D 80 tilt-and-turn window mechanism requires:

- Hinge kit
- Set of fastening mechanisms for Cremones and window handles
- Arms, available in three versions (standard, micro-ventilation and logic)
- Cremona or window handle (available in different models to choose from in the specific catalogue section)

**Adjustments**

The CLASSIC 3D tilt-and-turn window enables micrometric adjustment in every direction, ideal after installing the casement.

**Micro-ventilation**

Microventilation enables having simultaneously both the tilt-and-turn position and micro-ventilation (precision opening of the sash) on the casement.

**Logica**

The logical operation consists in first tilt-and-turn opening (with the cremona at 90°) and secondly side-hung opening (with the cremona at 180°). Its use is particularly recommended in public buildings (schools, hospitals, etc.) in combination with a cremona with a key in order to have only tilt-and-turn window opening for safety reasons and to allow full opening only for staff with the key.

Logica mechanism operation

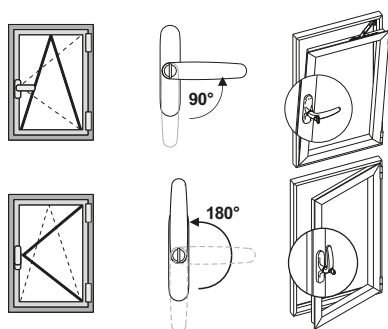

Standard microventilation

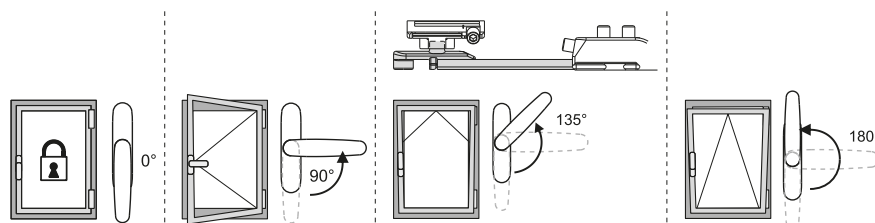

## ADJUSTMENTS [mm]

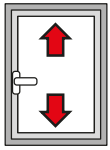

**Height:**  
+1.5 / -0.5

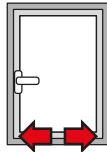

**Side:**  
±1

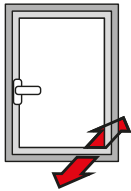

**Bottom hinge compression:**  
±0.3

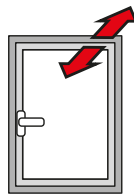

**Top hinge compression:**  
±1.5

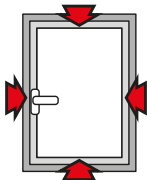

**Striker compression:**  
±1.8

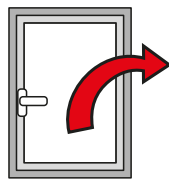

**Sash fall:**  
+3.5 / -1.5

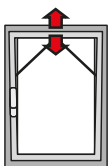

**Micro-ventilation:**  
+3.6 / -1.8

Table of maximum glass thickness [mm]

2500										
2400	25	21	18	16	14	13	11	10	10	
2300	26	22	19	16	15	13	12	11	10	
2200	27	23	19	17	15	14	12	11	10	
2100	29	24	20	18	16	14	13	12	11	
2000	30	25	21	19	17	15	14	12	11	
1900	31	26	22	20	17	16	14	13	12	
1800	33	28	24	21	18	17	15	14	13	
1700	35	29	25	22	19	17	16	15	13	
1600	37	31	26	23	21	18	17	15	14	
1500	39	33	28	25	22	20	18	16	15	
1400	42	35	30	26	23	21	19	17	16	
1300	45	37	32	28	25	22	20	19	17	
1200	48	40	34	30	27	24	22	20	17	
1100	50	44	37	33	29	26	24	20	17	
1000	50	48	41	36	32	29	24	20		
900	50	50	45	39	35	29	24			
800	50	50	50	44	35	29				
700	50	50	50	45	35					
600	50	50	50	45						
	350	500	600	700	800	900	1000	1100	1200	1300

Table of maximum load capacity [kg]

2500										
2400	80	80	80	80	80	80	80	80	80	80
2300	80	80	80	80	80	80	80	80	80	80
2200	80	80	80	80	80	80	80	80	80	80
2100	80	80	80	80	80	80	80	80	80	80
2000	80	80	80	80	80	80	80	80	80	80
1900	80	80	80	80	80	80	80	80	80	80
1800	80	80	80	80	80	80	80	80	80	80
1700	80	80	80	80	80	80	80	80	80	80
1600	80	80	80	80	80	80	80	80	80	80
1500	80	80	80	80	80	80	80	80	80	80
1400	80	80	80	80	80	80	80	80	80	80
1300	80	80	80	80	80	80	80	80	78	78
1200	80	80	80	80	80	80	80	79	73	73
1100	80	80	80	80	80	80	73	67		
1000	80	80	80	80	80	73	66			
900	80	80	80	80	73	66				
800	80	80	80	73	65					
700	80	80	80	73	64					
600	80	80	73	64						
	350	500	600	700	800	900	1000	1100	1200	1300

**CLASSIC 3D**  
**80**

**CLASSIC 3D**  
**80 micro**

Classic 3D 80 traditional

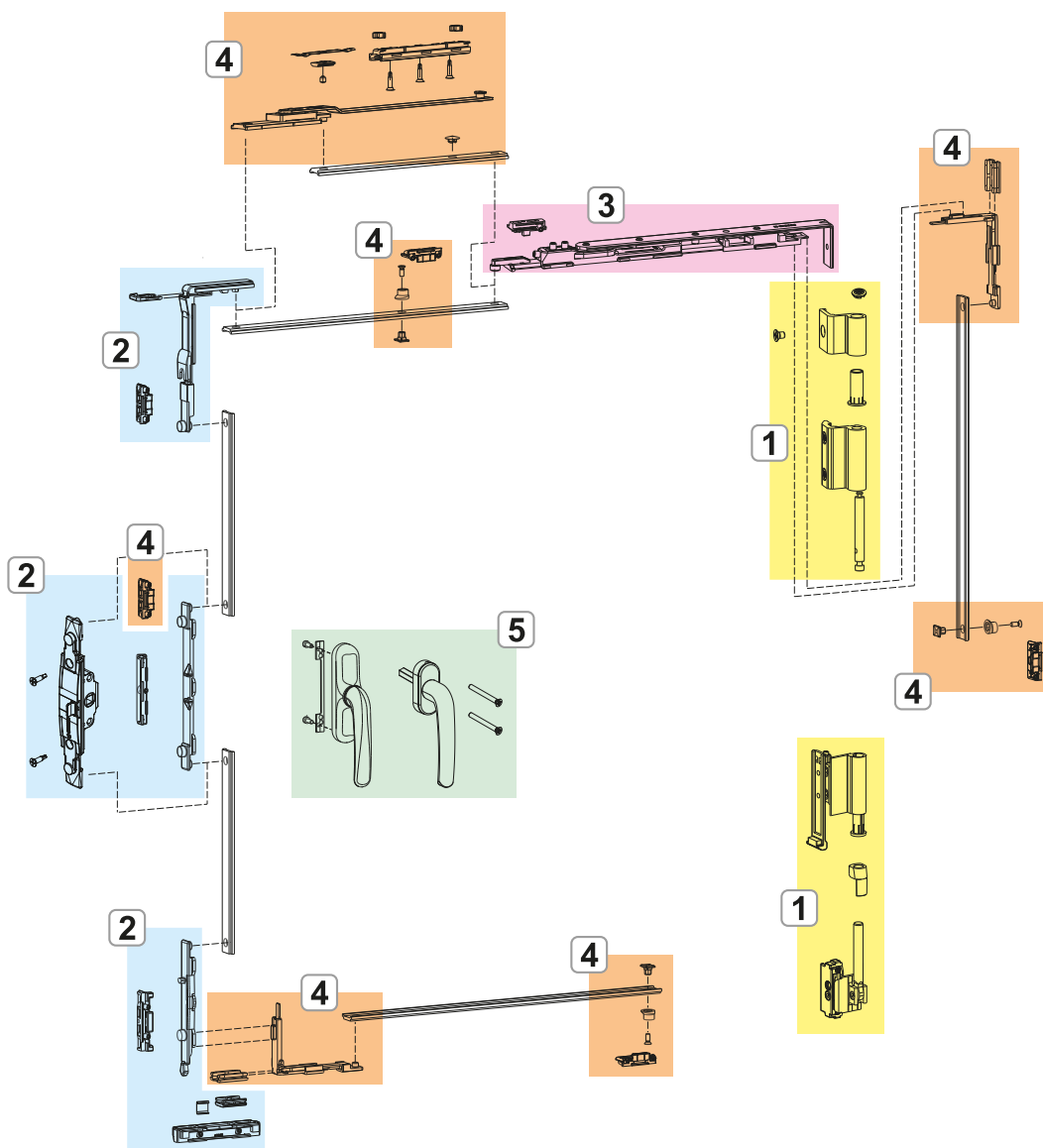

- 1. CLASSIC 3D 80 HINGES
- 2. CLASSIC 3D 80 FASTENING MECHANISMS
- 3. CLASSIC 3D 80 ARMS
- 4. CLASSIC 3D 80 ADDITIONAL FASTENING MECHANISMS AND ACCESSORIES
- 5. CREMONES AND WINDOW HANDLES

**CLASSIC 3D**  
80 lgc

Classic 3D 80 logica

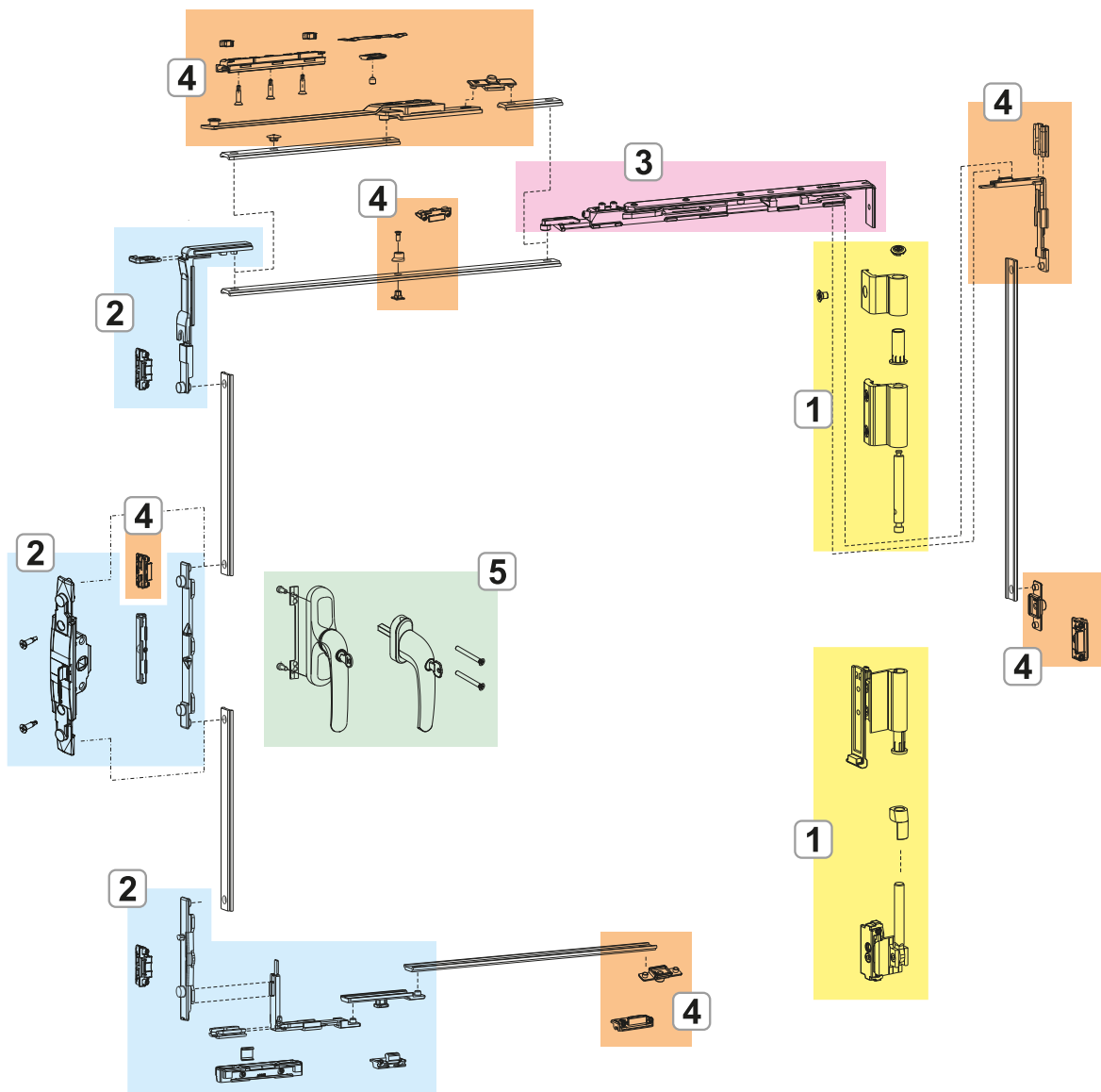

- 1. CLASSIC 3D 80 HINGES
- 2. CLASSIC 3D 80 FASTENING MECHANISMS
- 3. CLASSIC 3D 80 ARMS
- 4. CLASSIC 3D 80 ADDITIONAL FASTENING MECHANISMS AND ACCESSORIES
- 5. CREMONES AND WINDOW HANDLES

**CLASSIC 3D 80 HINGES**

**Functions**

Hinge set (upper and lower), completely pre-assembled and ready to be installed on the profile.

**Materials**

Extruded aluminium hinge body.

Supports in zamak with GS Silver Plus finish (up to 500 hr corrosion resistance).

Pins, screws and grub screws in stainless steel.

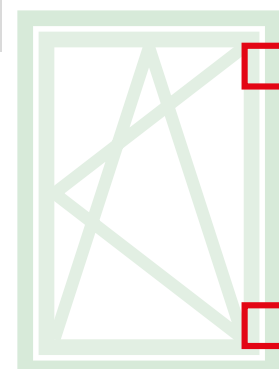

04739

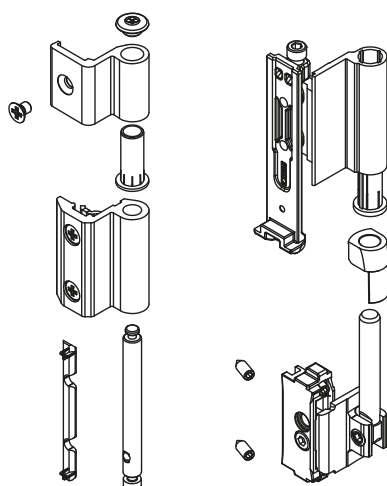

Item code	Description	PROFILE CROSS - SECTION	Base Raw	Anodised Elox	Painted	Trend/Gold Brass	Pieces per pack
04739	HINGE T/T CLASSIC 80	C001-C002-C003-C005	X	X	X		10

## CLASSIC 3D 80 FASTENING MECHANISMS

### Functions

Tilt-and-turn window fastening mechanisms for cremone or window handle, available in Base and Logica versions.

### Materials

Drive, drive rod, mechanism bolt tip and strikers in zamak with GS Silver Plus finish (up to 500 h of corrosion resistance).  
Screws and grub screws in stainless steel.  
Polyamide raiser.

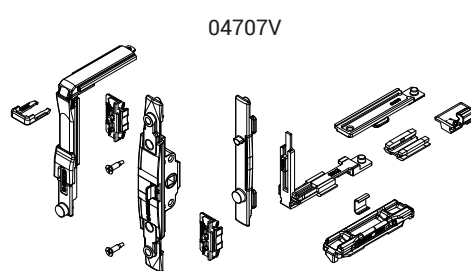
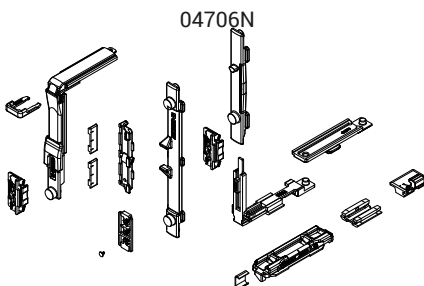
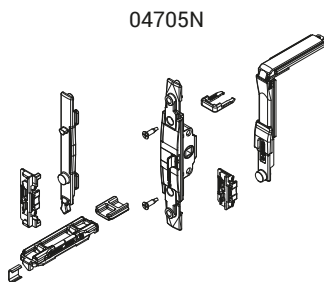
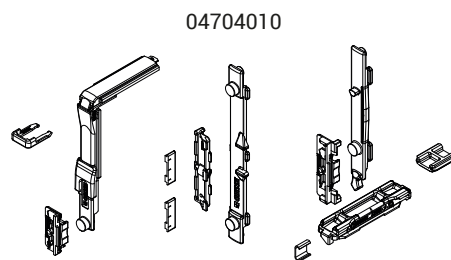
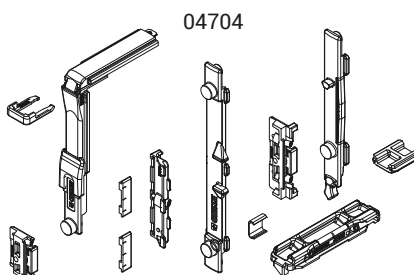
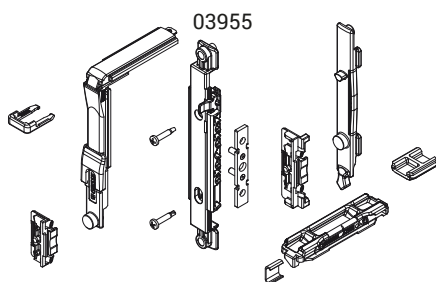
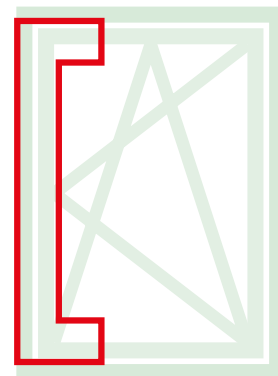

Item code	Description	PROFILE CROSS - SECTION	Window handle	Version	Base Raw	Anodised Elox	Painted	Trend/Gold Brass	Pieces per pack
03955	T/T FASTENING MECHANISM	C001-C002-C004-C005-C006-C013-C014-C015-C016-C017	NP SUPRA	-	X				10
04704	T/T FASTENING MECHANISM	C001-C002-C004-C005-C006-C013-C014-C015-C016-C017	Cremone	-	X				10
04704010	T/T FASTENING MECHANISM	C003	Cremone	-	X				10
04705N	T/T M 180 FASTENING MECHANISM	C001-C002-C004-C005-C006-C013-C014-C015-C016-C017	Window handle	-	X				10
04706N	T/T LOGICA FASTENING MECHANISM	C001-C002-C004-C005-C006-C013-C014-C015-C016-C017	Cremone	Logica	X				10
04707V	T/T M 180 LOGICA FASTENING MECHANISM	C001-C002-C004-C005-C006-C013-C014-C015-C016-C017	Window handle	Logica	X				10

**CLASSIC 3D 80 ARMS**

**Functions**

They enable tilt-and-turn opening in conjunction with the mechanisms and are available in three versions (standard, microventilation and logic).

**Materials**

Body, fixing block and slider in zamak with GS Silver Plus finish (up to 500 h of corrosion resistance).  
Rod, connecting bracket, grub screws and screws in stainless steel. Stop disk in polyamide.

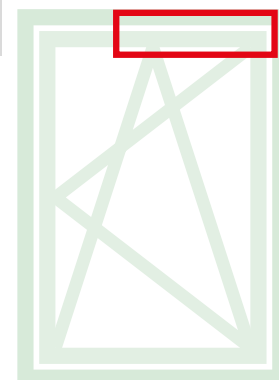

04329

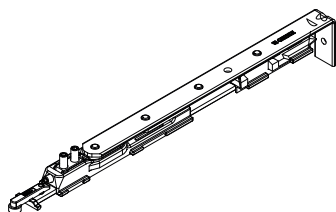

04330

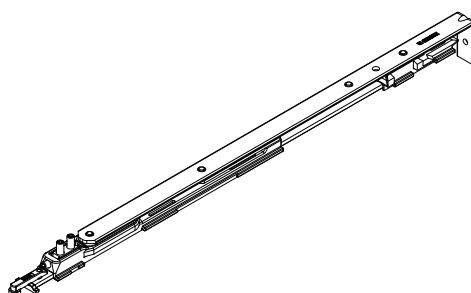

04339

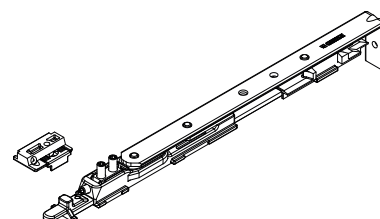

04340

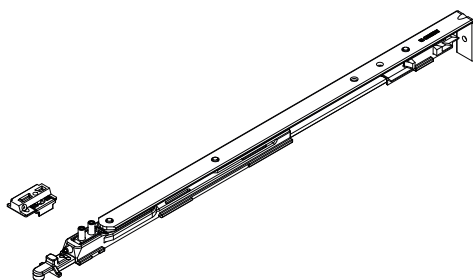

04352

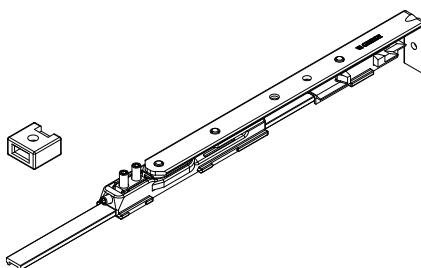

Item code	Description	PROFILE CROSS - SECTION	Range (mm)	Version	Base Raw	Anodised Elox	Painted	Trend/Gold Brass	Pieces per pack
04329	ARM TYPE 1 T/T CLASSIC 3D 80 LOGICA	C001-C002-C003-C005	W 390 ÷ 1300	Logica	X				10
04330	ARM TYPE 2 T/T CLASSIC 3D 80 LOGICA	C001-C002-C003-C005	W 550 ÷ 1700	Logica	X				10
04339	ARM TYPE 1 T/T CLASSIC 3D 80 MICRO	C001-C002-C003-C005	W 410 ÷ 1300	Micro	X				10
04340	ARM TYPE 2 T/T CLASSIC 3D 80 MICRO	C001-C002-C003-C005	W 570 ÷ 1700	Micro	X				10
04352	ARM TYPE 0 T/T CLASSIC 80	C001-C002-C003-C005	W 350 ÷ 410	-	X				10

## CLASSIC 3D 80 ADDITIONAL FASTENING MECHANISMS AND ACCESSORIES

### Functions

The additional fasteners make it possible to add further fastening elements that either increase the dimensions of the casement or that can be used when locking points are needed on the cross beams or hinge-side upright.

On the basis of the dimensions of the casement, additional fasteners (for  $H > 1200$  mm and  $W > 1000$  mm) and the additional arm (which is mandatory for  $W > 1000$  mm if the sash weighs more than 60 kg) are to be used in combination with this mechanism.

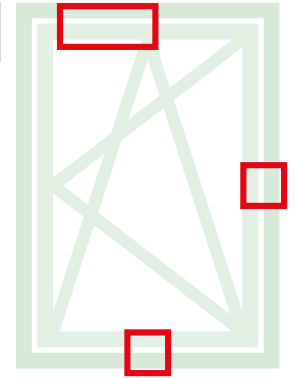

01299

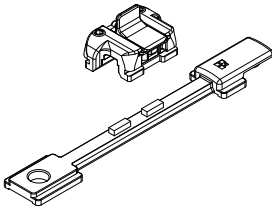

03528

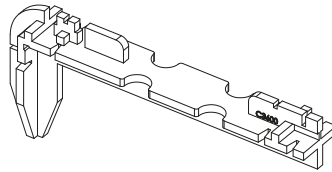

04014K

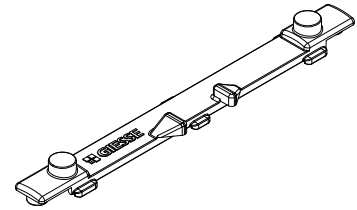

04026K

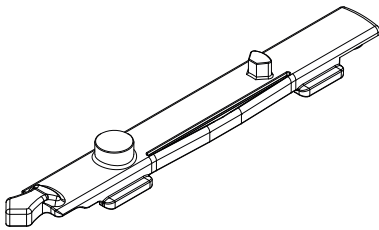

04301K

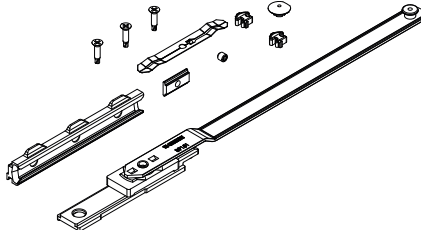

04311

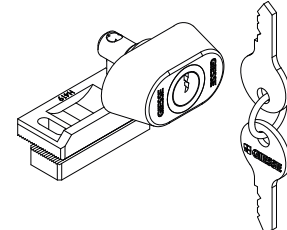

04778

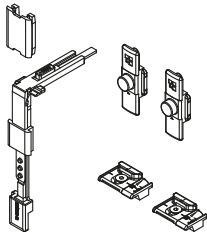

Item code	Description	PROFILE CROSS - SECTION	Range (mm)	Version	Base Raw	Anodised Elox	Painted	Trend/Gold Brass	Pieces per pack
01299	INCORRECT MOVEMENT SAFETY DEVICE	C001-C002-C003-C004-C005-C006-C013-C014-C015-C016-C017	H > 620 HC > 250	-	X				10
03528	TEMPLATE	C001-C002-C003-C004-C005-C006	-	-	X				20
04014K	FUTURA T/T DRIVE ROD	C001-C002-C003-C004-C005-C006-C013-C014-C015-C016-C017	-	-	X				10
04026K	FUTURA T/T BOLT TIP	C001-C002-C003-C004-C005-C006-C013-C014-C015-C016-C017	-	-	X				10
04301K	T/T FUTURA ADDITIONAL ARM	C001-C002-C003-C004-C005-C006	W > 1000	-	X				5
04311	SASH OPENING BLOCK LOCK	C001-C002-C003-C004-C005-C006-C007-C013-C014-C015-C016-C017	-	-	X				10
04778	FUTURA ADDITIONAL FASTENING MECHANISM	C001-C002-C003-C005	H > 1200 L > 1000	-	X				10



## CLASSIC 80 SECONDARY SASH

### Functions

Adapter for CLASSIC 3D 80 tilt-and-turn secondary sash hinges.

The adapter lets you turn the set of tilt-and-turn hinges into hinges for a secondary sash, keeping the same design, adjustments, dimensions and capacities achievable with a main sash.

### Materials

Grub screws and false arm rod made of steel

Support in zamak

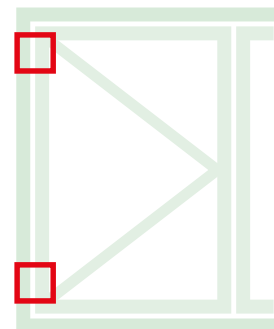

04727

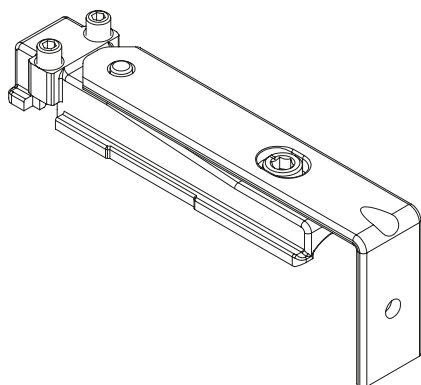

Item code	Description	PROFILE CROSS - SECTION	Base Raw	Anodised Elox	Painted	Trend/Gold Brass	Pieces per pack
04727	CLASSIC 3D 80 SECONDARY SASH ADAPTER	C001-C002-C003-C005	X				10